

PAGE 1/2	ISSUE 2028A	SERIES SMA-X	PART NUMBER R125415850X
----------	--------------------	---------------------	--------------------------------

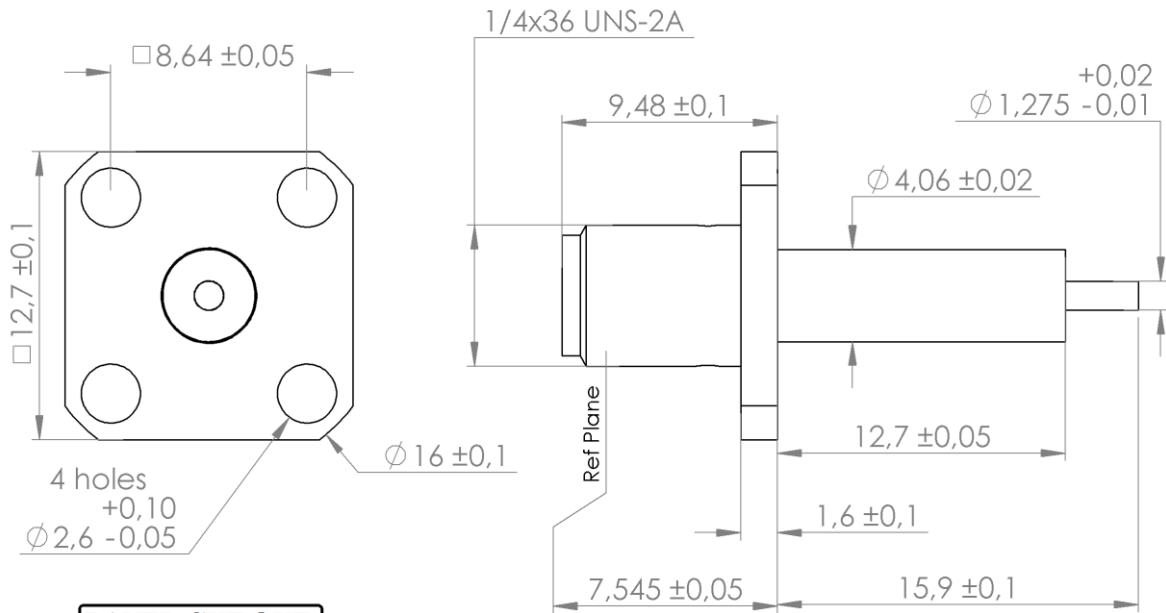

PANEL CUT OUT

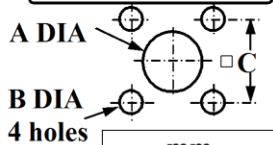

mm		
	Maxi	mini
A	4.2	4.1
B	2.7	2.6
C	8.69	8.59

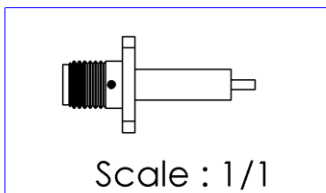

All dimensions are in mm.

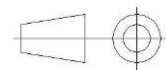

COMPONENTS	MATERIALS	PLATING (µm)
Body	STAINLESS STEEL	GOLD 1.3 OVER NICKEL2
Center contact	BERYLLIUM COPPER	GOLD 1.3 OVER NICKEL2
Outer contact	-	-
Insulator	PTFE	-
Gasket	-	-
Others parts	-	-
-	-	-
-	-	-

PAGE 2/2	ISSUE 2028A	SERIES SMA-X	PART NUMBER R125415850X
----------	--------------------	---------------------	--------------------------------

PACKAGING

Standard	Unit	Other
1	-	Contact us

ELECTRICAL CHARACTERISTICS

Impedance		50	Ω	
Frequency		0-18	GHz	
VSWR	1.05	+	0,0030	x F(GHz) Maxi
Insertion loss		0.02+0.07	√F(GHz) dB Maxi	
RF leakage	-	95	- F(GHz) dB Maxi	
Voltage rating		500	Vrms Maxi	
Dielectric withstanding voltage		1500	Vrms mini	
Insulation resistance		5000	MΩ mini	

ENVIRONMENTAL

Operating temperature	-65/+105	°C
Hermetic seal	NA	Atm.cm3/s
Panel leakage	NA	

MECHANICAL CHARACTERISTICS

Center contact retention				
Axial force – Mating End		27	N mini	
Axial force – Opposite end		27	N mini	
Torque		2.8	N.cm mini	
Recommended torque				
Mating		80-120	N.cm	
Panel nut			N.cm	
Mating life		500	Cycles Maxi	
Weight		3,7000	g Maxi	

SPECIFICATION

RAD-GEN-CONN 001
RAD-DET-CONN 003

OTHER CHARACTERISTICS

Assembly instruction:

Others: