

PAGE 1/2

ISSUE 2035A

SERIES 2.4

PART NUMBER R327466601

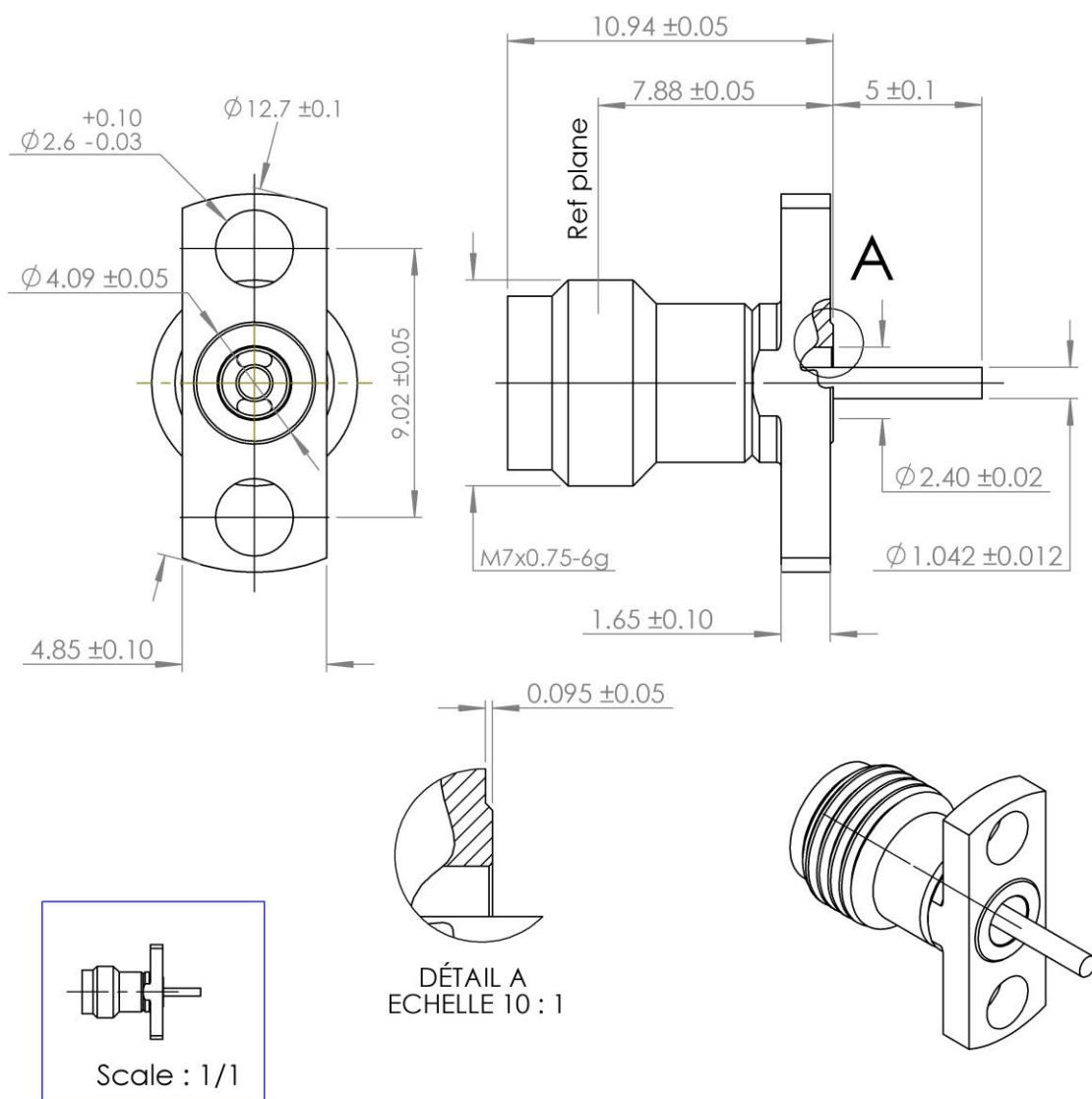

All dimensions are in mm.

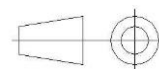

COMPONENTS	MATERIALS	PLATING (μm)
Body	STAINLESS STEEL	PASSIVATED
Center contact	BERYLLIUM COPPER	GOLD 1.3 OVER NICKEL2
Outer contact	BRASS.	GOLD 1.3 OVER NICKEL2
Insulator	PEEK	
Gasket		
Others parts		
-	-	-
-	-	-

PAGE 2/2

ISSUE **2035A**

SERIES **2.4**

PART NUMBER **R327466601**

PACKAGING

Standard	Unit	Other
1	-	Contact us

ELECTRICAL CHARACTERISTICS

Impedance	50	Ω
Frequency	DC-50	GHz
VSWR	1.05 + 0,0030	x F(GHz) Maxi
Insertion loss	0.02+0.04	\sqrt{F} (GHz) dB Maxi
RF leakage	- (100)	- F(GHz)) dB Maxi
Voltage rating	250	Vrms Maxi
Dielectric withstanding voltage	500	Vrms mini
Insulation resistance	5000	M Ω mini

MECHANICAL CHARACTERISTICS

Center contact retention		
Axial force – Mating End	27	N mini
Axial force – Opposite end	27	N mini
Torque	NA	N.cm mini
Recommended torque		
Mating	80-120	N.cm
Panel nut	NA	N.cm
Mating life	500	Cycles Maxi
Weight	2,2100	g Maxi

ENVIRONMENTAL

Operating temperature	-65/+165	°C
Hermetic seal	NA	Atm.cm3/s
Panel leakage	NA	

SPECIFICATION

RAD-GEN-CONN 001
RAD-DET-CONN 025

OTHER CHARACTERISTICS

Assembly instruction:

Others: