

PAGE 1/1	ISSUE 2035A	SERIES ACC-COAX	PART NUMBER R280152610
----------	-------------	-----------------	------------------------

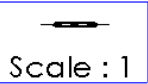

All dimensions are in mm. Tolerances according ISO 2768 m-H

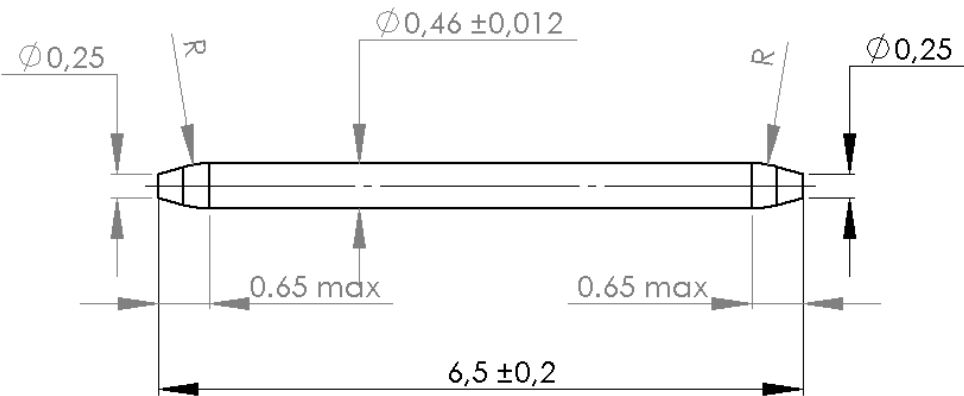
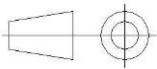

COMPONENTS	MATERIALS	PLATING (μm)
Body	DILVER P1	GOLD 1.3 OVER NICKEL2
Center contact		
Outer contact		
Insulator		
Gasket		
Others parts	-	-
-	-	-
-	-	-
Operating temperature		°C
Weight	0,0090	g
Others characteristics	According to ESCC 3402	