

PAGE 1/2

ISSUE 2035A

SERIES SMA

PART NUMBER R280151000X

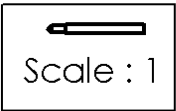
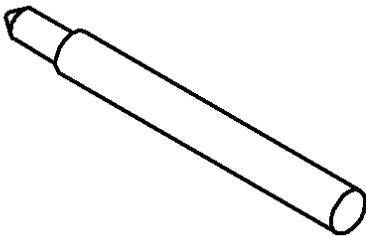
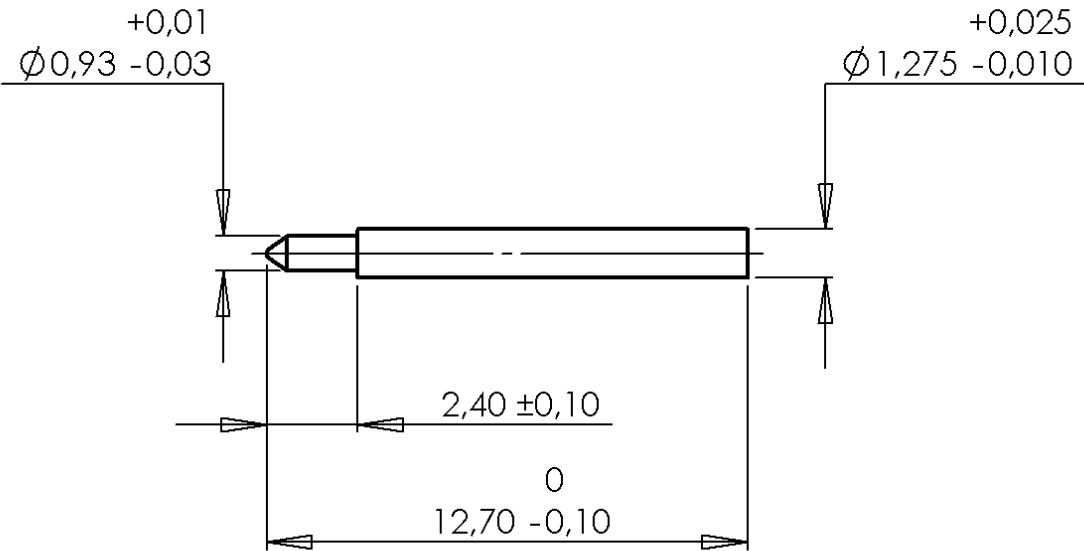

All dimensions are in mm.

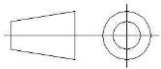

COMPONENTS	MATERIALS	PLATING (μm)
Body	BERYLLIUM COPPER	GOLD 1.3 OVER NICKEL2
Center contact		
Outer contact		
Insulator		
Gasket		
Others parts		
-	-	-
-	-	-
Operating temperature	-65/+160	°C
Weight	0,1370	g
Others characteristics	RAD-GEN-CONN 001 RAD-DET-CONN 020	



PAGE 2/2	ISSUE 2035A	SERIES SMA	PART NUMBER R280151000X
----------	-------------	------------	-------------------------

--