

PAGE 1/3	ISSUE 2035A	SERIES SMP-S	PART NUMBER R232723140
----------	-------------	--------------	------------------------

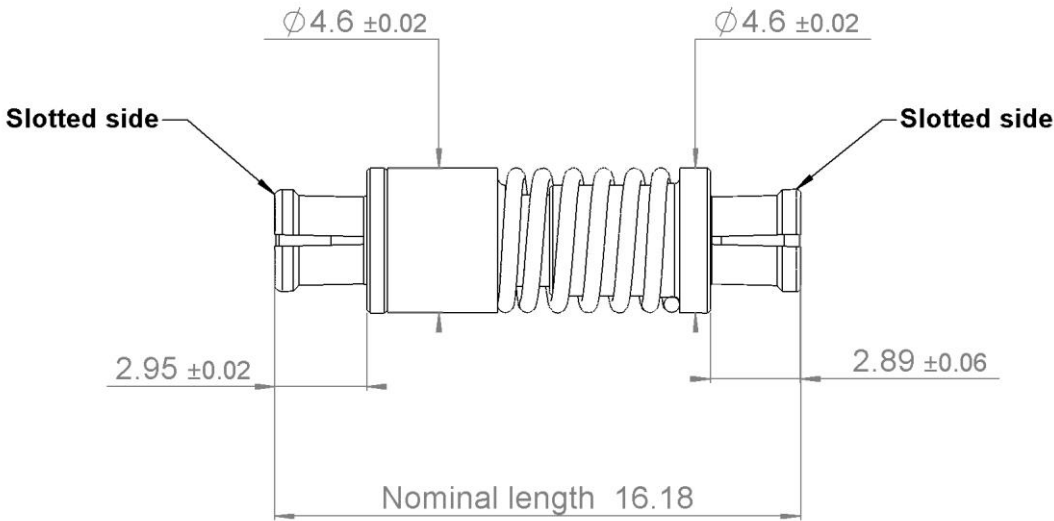

One side can be mated on
FULL or Limited detent
The opposite on Smooth-bore

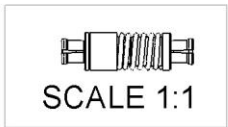

All dimensions are in mm.

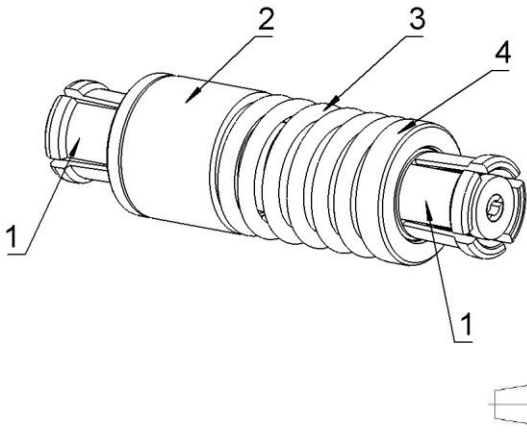

COMPONENTS	MATERIALS	PLATING (μm)
Body	BERYLLIUM COPPER	GOLD 1.3 OVER NICKEL2
Center contact	BERYLLIUM COPPER	GOLD 1.3 OVER NICKEL2
Outer contact	BRASS	GOLD 1.3 OVER NICKEL2
Insulator	PTFE + PEI	
Gasket		
Others parts	STAINLESS STEEL	PASSIVATED
-	-	-
-	-	-

PAGE 2/3

ISSUE 2035A

SERIES SMP-S

PART NUMBER R232723140

PACKAGING

Standard	Unit	Other
1	-	Contact us

ELECTRICAL CHARACTERISTICS

Impedance	50	Ω
Frequency	DC-31.5	GHz
VSWR	See* + 0,0000	x F(GHz) Maxi
Insertion loss	0.02+0.12	√F(GHz) dB Maxi
RF leakage	- (NA	- F(GHz)) dB Maxi
Voltage rating	335	Vrms Maxi
Dielectric withstanding voltage	500	Vrms mini
Insulation resistance	5000	MΩ mini

MECHANICAL CHARACTERISTICS

Center contact retention		
Axial force – Mating End	6.7	N mini
Axial force – Opposite end	6.7	N mini
Torque	NA	N.cm mini
Recommended torque		
Mating	NA	N.cm
Panel nut	NA	N.cm
Mating life	100	Cycles Maxi
Weight	1,1000	g Maxi

ENVIRONMENTAL

Operating temperature	-65/+150	°C
Hermetic seal	NA	Atm.cm3/s
Panel leakage	NA	

SPECIFICATION

RAD-GEN-CONN 001
RAD-DET-CONN 019

OTHER CHARACTERISTICS

Assembly instruction:

Others:

DC to 12 GHz: 1.15 max
From 12 GHz to 22 GHz: 1.25 max
From 22 to 31.5 GHz: 1.35 max

Use SMP Kit of calibration,
With S1P parameter for RF measurements

PAGE 3/3

ISSUE 2035A

SERIES SMP-S

PART NUMBER R232723140

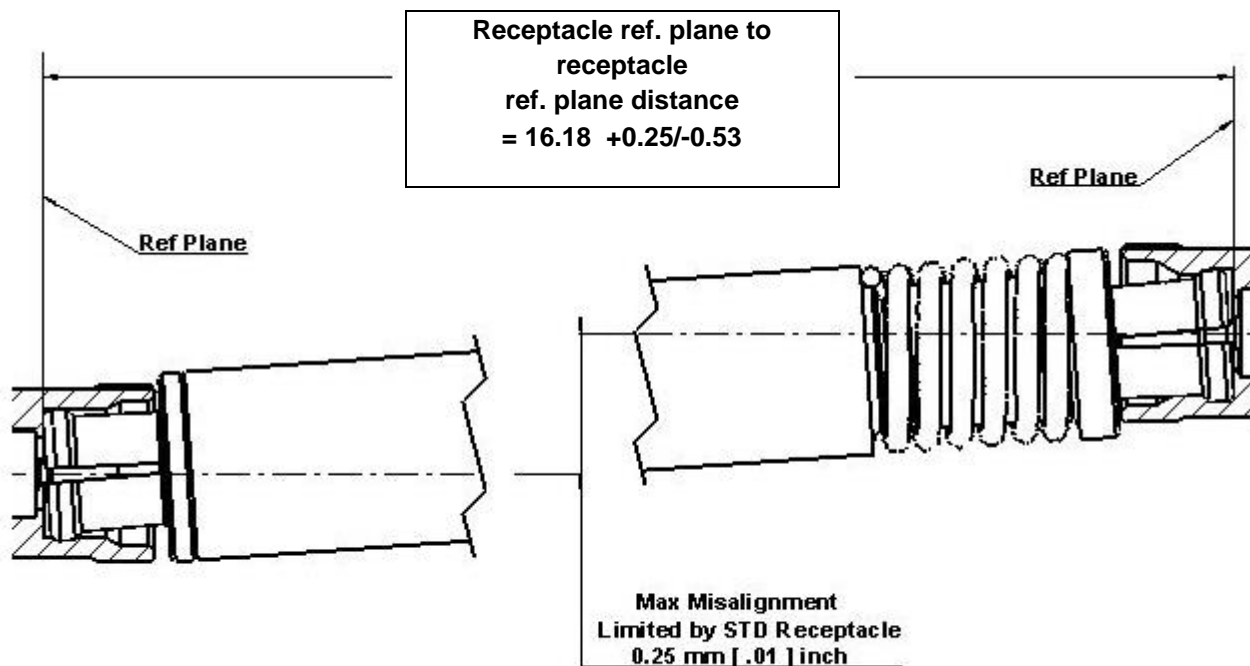

Spring bullet in neutral position = 16.95 Maxi

Operating length:

Maxi = 16.43

Mini = 15.65

MINI COMPRESSION > 9 N

MAX COMPRESSION < 13.6 N