

| | | | |
|----------|-------------|--------------|------------------------|
| PAGE 1/2 | ISSUE 2035A | SERIES SMP-S | PART NUMBER R232561311 |
|----------|-------------|--------------|------------------------|

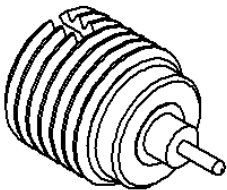

All dimensions are in mm.

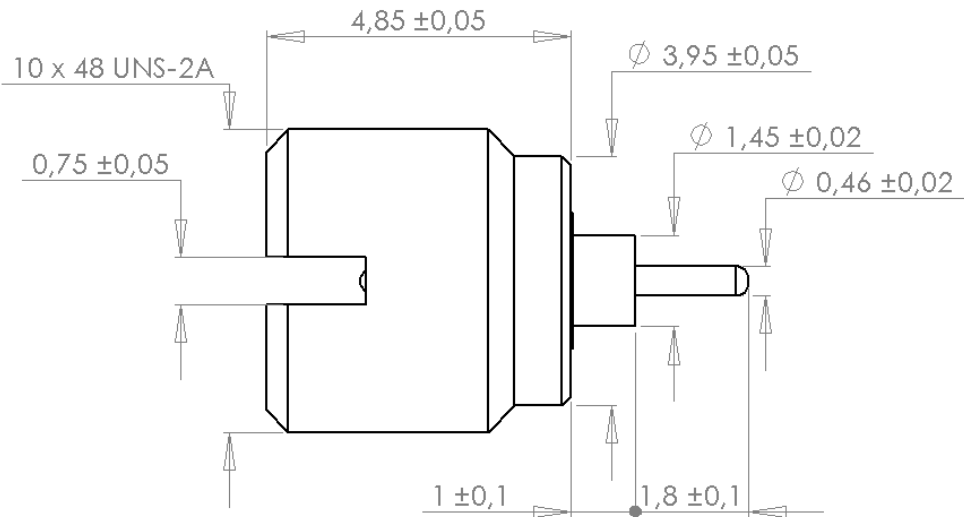
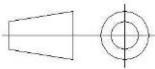

| COMPONENTS | MATERIALS | PLATING (μm) |
|----------------|------------------|----------------------------|
| Body | STAINLESS STEEL | PASSIVATED. |
| Center contact | BERYLLIUM COPPER | GOLD 1.27 OVER NICKEL 1.27 |
| Outer contact | | |
| Insulator | PTFE | |
| Gasket | | |
| Others parts | | |
| - | - | - |
| - | - | - |

PAGE 2/2

ISSUE **2035A**

SERIES **SMP-S**

PART NUMBER **R232561311**

PACKAGING

| Standard | Unit | Other |
|----------|------|-------------------|
| 1 | - | Contact us |

ELECTRICAL CHARACTERISTICS

| | | |
|---------------------------------|------------------|--------------------------|
| Impedance | 50 | Ω |
| Frequency | 0-12 | GHz |
| VSWR | + 0,0000 | x F(GHz) Maxi |
| Insertion loss | 0.02+0.12 | \sqrt{F} (GHz) dB Maxi |
| RF leakage | - (NA | - F(GHz)) dB Maxi |
| Voltage rating | 335 | Vrms Maxi |
| Dielectric withstanding voltage | 500 | Vrms mini |
| Insulation resistance | 5000 | M Ω mini |

MECHANICAL CHARACTERISTICS

| | | |
|----------------------------|---------------|-------------|
| Center contact retention | | |
| Axial force – Mating End | NA | N mini |
| Axial force – Opposite end | NA | N mini |
| Torque | NA | N.cm mini |
| Recommended torque | | |
| Mating | NA | N.cm |
| Panel nut | 90 | N.cm |
| Mating life | 100 | Cycles Maxi |
| Weight | 0,4200 | g Maxi |

ENVIRONMENTAL

| | | |
|-----------------------|-----------------|-----------|
| Operating temperature | -65/+165 | °C |
| Hermetic seal | NA | Atm.cm3/s |
| Panel leakage | NA | |

SPECIFICATION

RAD-GEN-CONN 001
RAD-DET-CONN 019

OTHER CHARACTERISTICS

Assembly instruction:

Others: