

PAGE 1/2	ISSUE 2034A	SERIES SMA2.9 S	PART NUMBER R137876101
----------	-------------	-----------------	------------------------

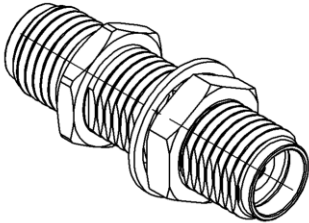

All dimensions are in mm.

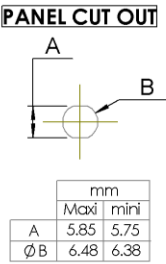
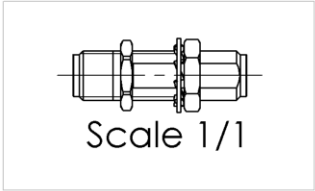
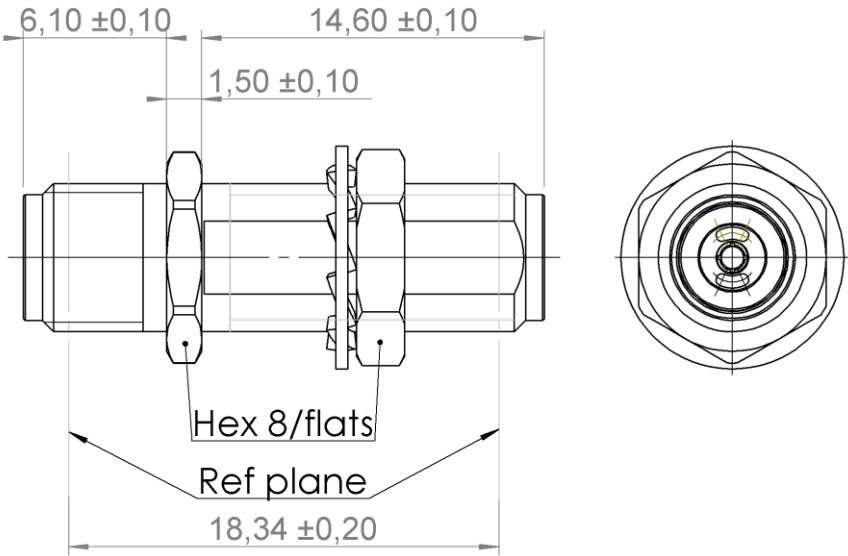
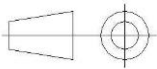

COMPONENTS	MATERIALS	PLATING (µm)
Body	STAINLESS STEEL	PASSIVATED
Center contact	BERYLLIUM COPPER	GOLD 1.3 OVER NICKEL2
Outer contact	BRASS	GOLD 1.3 OVER NICKEL2
Insulator	ULTEM	
Gasket	-	
Others parts	BRASS	NICKEL 2
-	-	-
-	-	-

PAGE 2/2

ISSUE 2034A

SERIES SMA2.9 S

PART NUMBER R137876101

PACKAGING

Standard	Unit	Other
1	-	Contact us

ELECTRICAL CHARACTERISTICS

Impedance	50	Ω
Frequency	0-40	GHz
VSWR	* + 0,0000	x F(GHz) Maxi
Insertion loss	0.02+0.03	√F(GHz) dB Maxi
RF leakage	- (120	- F(GHz)) dB Maxi
Voltage rating	350	Vrms Maxi
Dielectric withstanding voltage	750	Vrms mini
Insulation resistance	5000	MΩ mini

ENVIRONMENTAL

Operating temperature	-65/+165	°C
Hermetic seal	NA	Atm.cm3/s
Panel leakage	NA	

MECHANICAL CHARACTERISTICS

Center contact retention		
Axial force – Mating End	27	N mini
Axial force – Opposite end	27	N mini
Torque	NA	N.cm mini
Recommended torque		
Mating	80-120	N.cm
Panel nut	NA	N.cm
Mating life	500	Cycles Maxi
Weight	5,2000	g Maxi

SPECIFICATION

According to ESCC 3402
According to ESCC 3402 023

OTHER CHARACTERISTICS

Assembly instruction:

Others:
assembly instruction