

PAGE 1/2	ISSUE 2033A	SERIES SMA2.9 S	PART NUMBER R137800001
----------	-------------	-----------------	------------------------

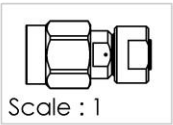

All dimensions are in mm.

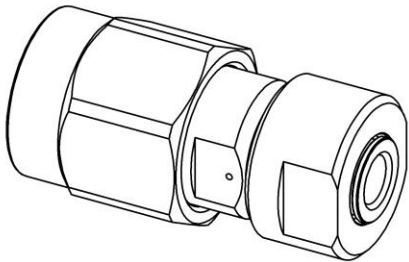
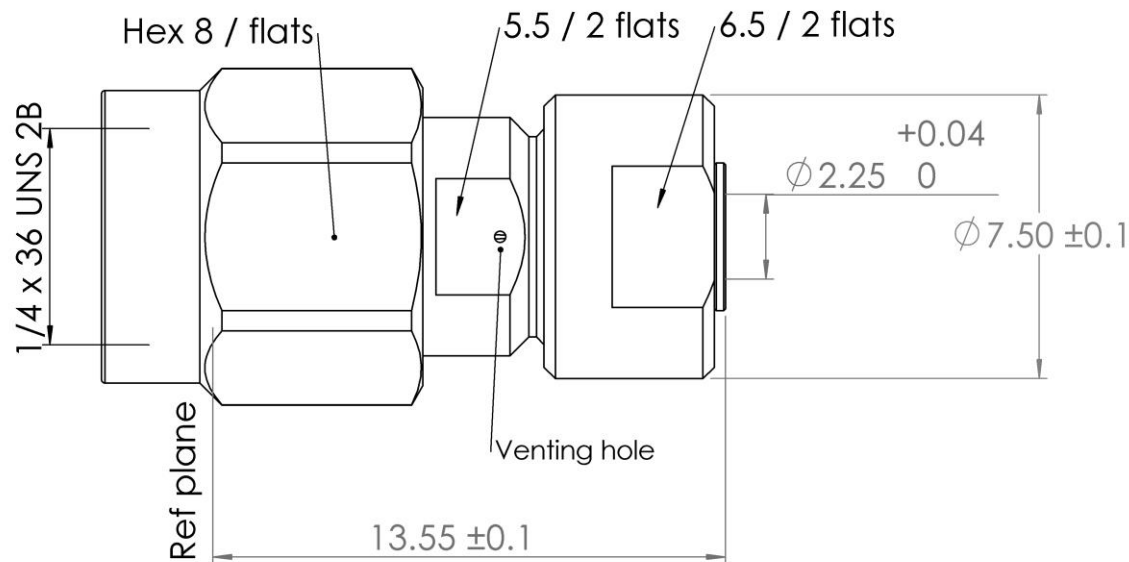
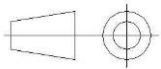

COMPONENTS	MATERIALS	PLATING (µm)
Body	X8CrNiS18-9 - S30300	PASSIVATED.
Center contact	CuBe2Pb H - C17300	GOLD 1.3 OVER NICKEL2
Outer contact	CuBe2Pb H - C17300	GOLD 1.3 OVER NICKEL2
Insulator	ULTEM1000	
Gasket	SILICONE	
Others parts	CuBe2Pb H - C17300	SILVER 5 OVER COPPER 0.5
-	-	-
-	-	-

PAGE 2/2

ISSUE 2033A

SERIES SMA2.9 S

PART NUMBER R137800001

## PACKAGING

Standard	Unit	Other
1	-	Contact us

## ELECTRICAL CHARACTERISTICS

Impedance	50	Ω
Frequency	0-40	GHz
VSWR	1.05 + 0,0050	x F(GHz) Maxi
Insertion loss	0.02+0.03	√F(GHz) dB Maxi
RF leakage	- ( 90	- F(GHz)) dB Maxi
Voltage rating	500	Vrms Maxi
Dielectric withstanding voltage	750	Vrms mini
Insulation resistance	5000	MΩ mini

## MECHANICAL CHARACTERISTICS

Center contact retention		
Axial force – Mating End	27	N mini
Axial force – Opposite end	NA	N mini
Torque	NA	N.cm mini
Recommended torque		
Mating	NA	N.cm
Panel nut	NA	N.cm
Mating life	500	Cycles Maxi
Weight	4,6000	g Maxi

## ENVIRONMENTAL

Operating temperature	-65 +165	°C
Hermetic seal	NA	Atm.cm3/s
Panel leakage	NA	

## SPECIFICATION

According to ESCC 3402  
According to ESCC 3402 021

## OTHER CHARACTERISTICS

Assembly instruction:

Others: