

PAGE 1/2

ISSUE 2033A

SERIES SMA 2.9

PART NUMBER R127873001X

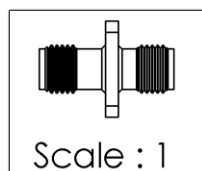
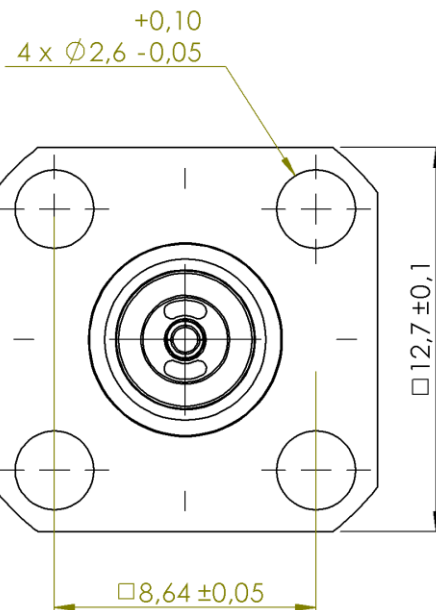
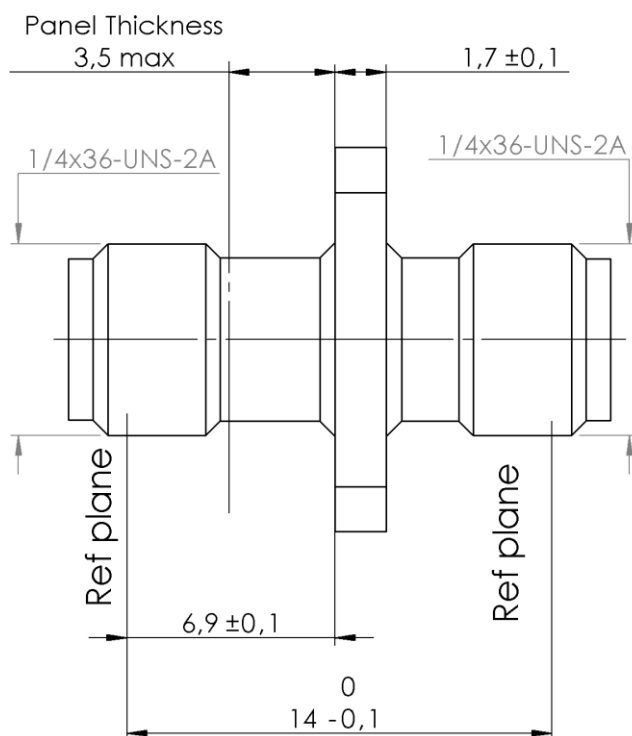

PANEL CUT OUT		
A DIA		
B DIA		
4 holes		
	mm	
	Maxi	mini
A	6.5	6.4
B	2.7	2.6
C	8.69	8.59

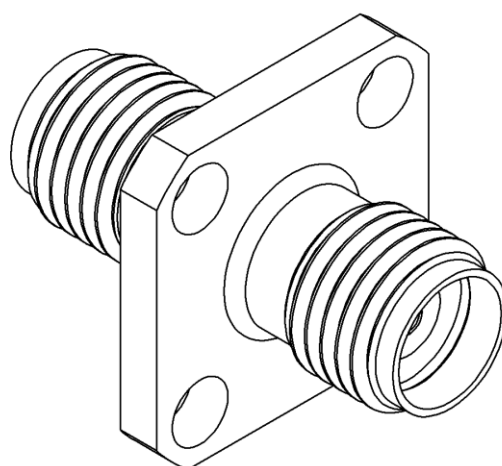

All dimensions are in mm.

COMPONENTS	MATERIALS	PLATING (µm)
Body	STAINLESS STEEL	PASSIVATED.
Center contact	BERYLLIUM COPPER	GOLD 1.3 OVER NICKEL2
Outer contact	BRASS	GOLD 1.3 OVER NICKEL2
Insulator	ULTEM	
Gasket		
Others parts		
-	-	-
-	-	-

PAGE 2/2

ISSUE **2033A**

SERIES **SMA 2.9**

PART NUMBER **R127873001X**

PACKAGING

Standard	Unit	Other
1	-	Contact us

ELECTRICAL CHARACTERISTICS

Impedance	50	Ω
Frequency	0-40	GHz
VSWR	1.05 + 0,0030	x F(GHz) Maxi
Insertion loss	0.02+0.03	\sqrt{F} (GHz) dB Maxi
RF leakage	- (120)	- F(GHz)) dB Maxi
Voltage rating	350	Vrms Maxi
Dielectric withstanding voltage	750	Vrms mini
Insulation resistance	5000	M Ω mini

MECHANICAL CHARACTERISTICS

Center contact retention		
Axial force – Mating End	27	N mini
Axial force – Opposite end	27	N mini
Torque	NA	N.cm mini
Recommended torque		
Mating	80-120	N.cm
Panel nut		N.cm
Mating life	500	Cycles Maxi
Weight	4,4000	g Maxi

ENVIRONMENTAL

Operating temperature	-65/+165	°C
Hermetic seal		Atm.cm3/s
Panel leakage		

SPECIFICATION

RAD-GEN-CONN 001
RAD-DET-CONN 007

OTHER CHARACTERISTICS

Assembly instruction:

Others: