

PAGE 1/2

ISSUE 2013A

SERIES SMA-S

PART NUMBER R126052000

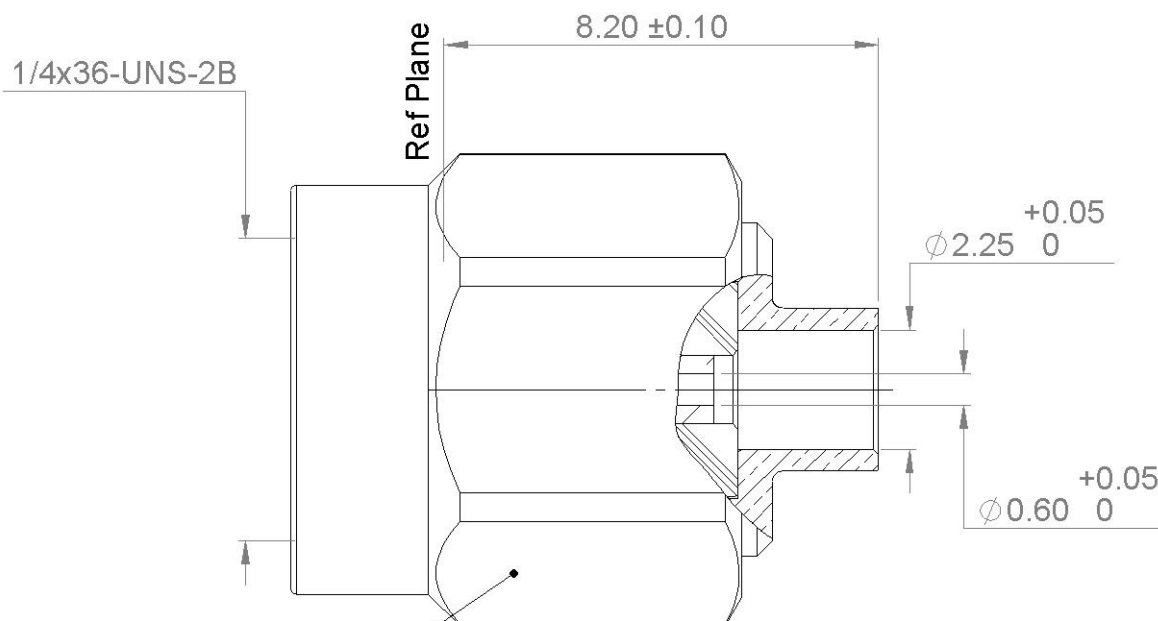

Hex: 8 / flats

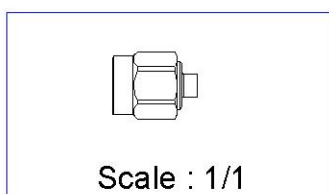

All dimensions are in mm.

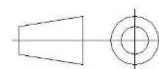
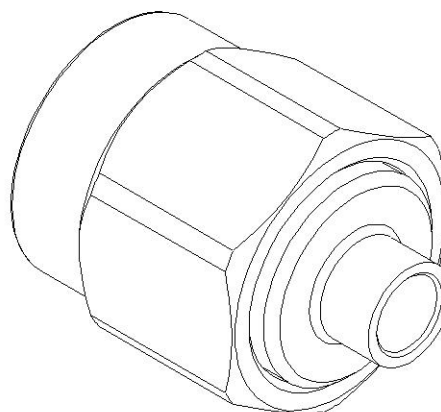

COMPONENTS	MATERIALS	PLATING (μm)
Body	BERYLLIUM COPPER	GOLD 2.5 OVER COPPER 2.5
Center contact	BRASS.	GOLD 2.5 OVER COPPER 2.5
Outer contact	-	-
Insulator	PTFE	-
Gasket	SILICONE RUBBER	-
Others parts	BERYLLIUM COPPER	GOLD 2.5 OVER COPPER 2.5
-	-	-
-	-	-

PAGE 2/2

ISSUE 2013A

SERIES SMA-S

PART NUMBER R126052000

PACKAGING

Standard	Unit	Other
1	-	Contact us

ELECTRICAL CHARACTERISTICS

Impedance	50	Ω
Frequency	0-18	GHz
VSWR	1.07 + 0,0080	x F(GHz) Maxi
Insertion loss	0.02 +0.03	√F(GHz) dB Maxi
RF leakage	- (- F(GHz)) dB Maxi
Voltage rating	335	Vrms Maxi
Dielectric withstanding voltage	750	Vrms mini
Insulation resistance	5000	MΩ mini

MECHANICAL CHARACTERISTICS

Center contact retention	NA	N mini
Axial force – Mating End	NA	N mini
Axial force – Opposite end	NA	N.mini
Torque	NA	N.cm mini
Recommended torque		
Mating	80-120	N.cm
Panel nut	NA	N.cm
Mating life	500	Cycles Maxi
Weight	2.7	g Maxi

ENVIRONMENTAL

Operating temperature	-65/+165	°C
Hermetic seal	NA	Atm.cm3/s
Panel leakage	NA	

SPECIFICATION

According to ESCC3402
According to ESCC3402/001
According to Tecnologica specification

OTHER CHARACTERISTICS

Assembly instruction:

Others:

-