

PAGE 1/2

ISSUE 2032A

SERIES SMA-S

PART NUMBER R126421011

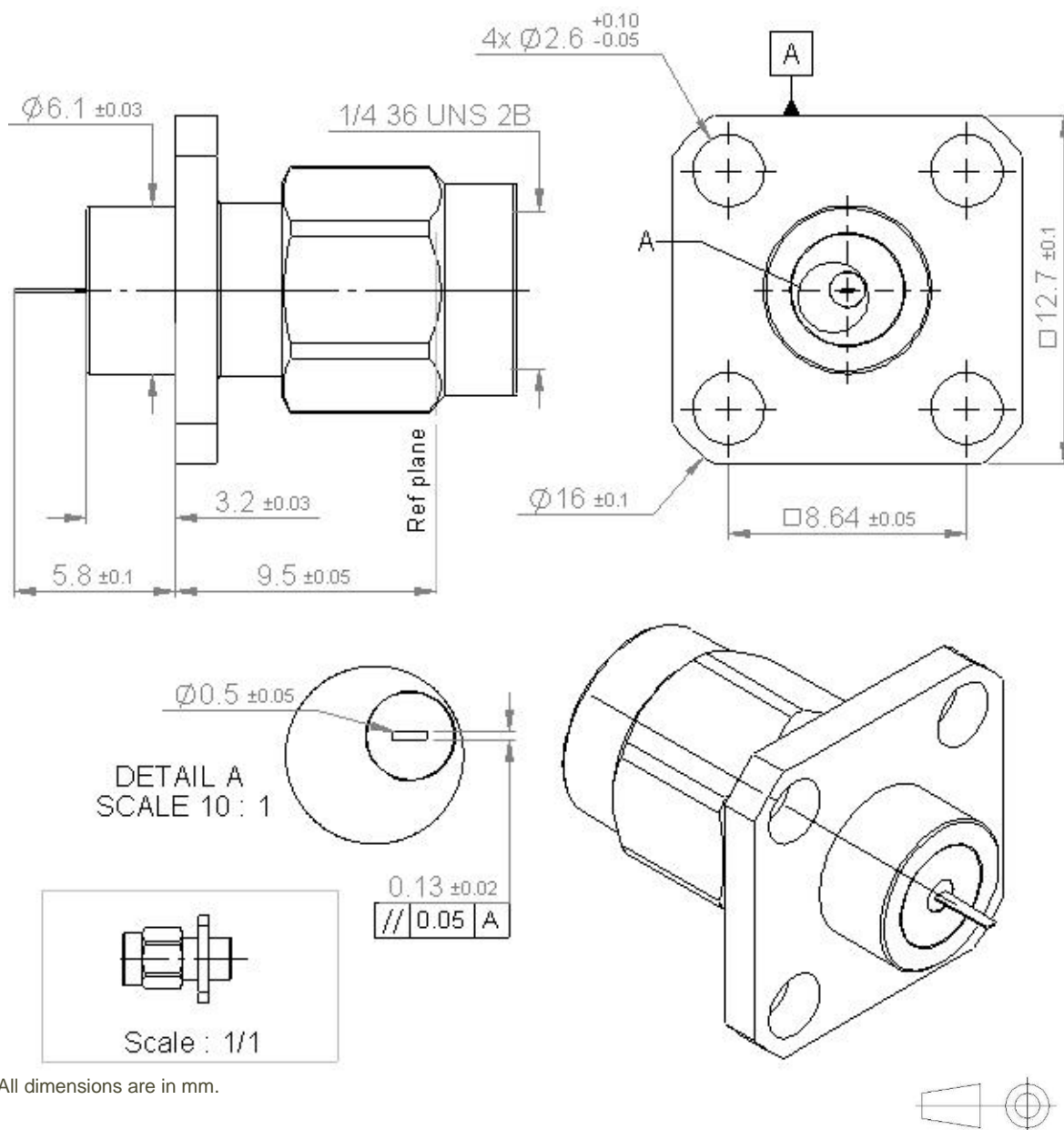

All dimensions are in mm.

COMPONENTS	MATERIALS	PLATING (μm)
Body	STAINLESS STEEL	PASSIVATED
Center contact	BERYLLIUM COPPER	GOLD 1.3 OVER NICKEL2
Outer contact	STAINLESS STEEL	PASSIVATED
Insulator	PTFE	
Gasket	SILICONE 60 SHORE A, RED	
Others parts	STAINLESS STEEL	PASSIVATED
-	-	-
-	-	-

PAGE 2/2

ISSUE **2032A**

SERIES **SMA-S**

PART NUMBER **R126421011**

### PACKAGING

Standard	Unit	Other
<b>1</b>	-	<b>Contact us</b>

### ELECTRICAL CHARACTERISTICS

Impedance	<b>50</b>	$\Omega$
Frequency	<b>0-18</b>	GHz
VSWR	<b>1.1 + 0,0100</b>	x F(GHz) Maxi
Insertion loss	<b>0.02+0.05</b>	$\sqrt{F}$ (GHz) dB Maxi
RF leakage	- ( <b>110</b> )	- F(GHz)) dB Maxi
Voltage rating	<b>335</b>	Vrms Maxi
Dielectric withstanding voltage	<b>1000</b>	Vrms mini
Insulation resistance	<b>5000</b>	M $\Omega$ mini

### ENVIRONMENTAL

Operating temperature	<b>-65/ +105</b>	°C
Hermetic seal	<b>NA</b>	Atm.cm3/s
Panel leakage	<b>NA</b>	

### MECHANICAL CHARACTERISTICS

Center contact retention		
Axial force – Mating End	<b>27</b>	N mini
Axial force – Opposite end	<b>27</b>	N mini
Torque	<b>2.8</b>	N.cm mini
Recommended torque		
Mating	<b>80-120</b>	N.cm
Panel nut	<b>NA</b>	N.cm
Mating life	<b>500</b>	Cycles Maxi
Weight	<b>5,5000</b>	g Maxi

### SPECIFICATION

**According to 3402**  
**According to 3402 001**

### OTHER CHARACTERISTICS

Assembly instruction:

Others: