

PAGE 1/2	ISSUE 2027A	SERIES SMA-X	PART NUMBER R125055500X
----------	-------------	--------------	-------------------------

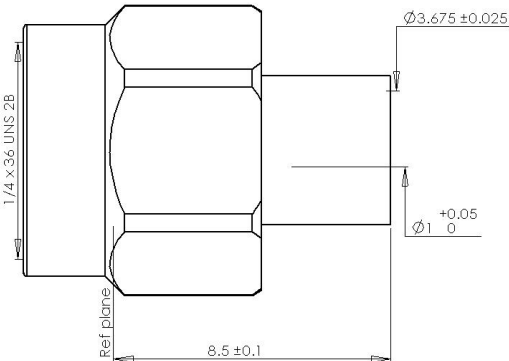

Scale : 1/1

All dimensions are in mm.

COMPONENTS	MATERIALS	PLATING (µm)
Body	INOX	GOLD 0.5 OVER NICKEL 2
Center contact	BRASS	GOLD 1.3 OVER NICKEL2
Outer contact	-	-
Insulator	PTFE	-
Gasket	SILICONE RUBBER	-
Others parts	INOX	GOLD 0.5 OVER NICKEL 2
-	-	-
-	-	-

PAGE 2/2

ISSUE 2027A

SERIES SMA-X

PART NUMBER R125055500X

## PACKAGING

Standard	Unit	Other
1	-	Contact us

## ELECTRICAL CHARACTERISTICS

Impedance		50	Ω
Frequency		0-18	GHz
VSWR	1.05	+	0,0030
Insertion loss		0.02+0.02	x F(GHz) Maxi
RF leakage	- (	90	√F(GHz) dB Maxi
Voltage rating		500	- F(GHz)) dB Maxi
Dielectric withstanding voltage		1000	Vrms Maxi
Insulation resistance		5000	Vrms mini
			MΩ mini

## MECHANICAL CHARACTERISTICS

Center contact retention		
Axial force – Mating End	NA	N mini
Axial force – Opposite end	NA	N mini
Torque	NA	N.cm mini

Recommended torque		
Mating	80-120	N.cm
Panel nut	NA	N.cm

Mating life	500	Cycles Maxi
Weight	2,0000	g Maxi

## ENVIRONMENTAL

Operating temperature	-65/+105	°C
Hermetic seal	NA	Atm.cm3/s
Panel leakage	NA	

## SPECIFICATION

RAD-GEN-CONN 001  
RAD-DET-CONN 002

## OTHER CHARACTERISTICS

Assembly instruction:

Others: