

PAGE 1/2

ISSUE 2032A

SERIES SMA-X

PART NUMBER R125720121X

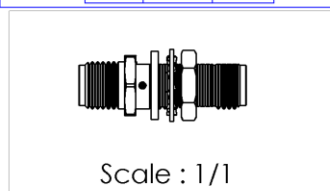
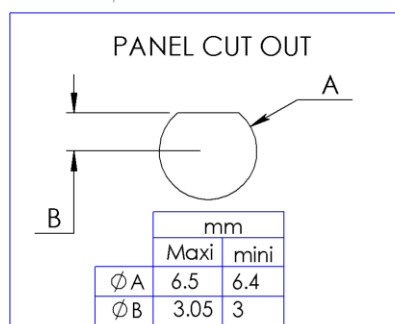
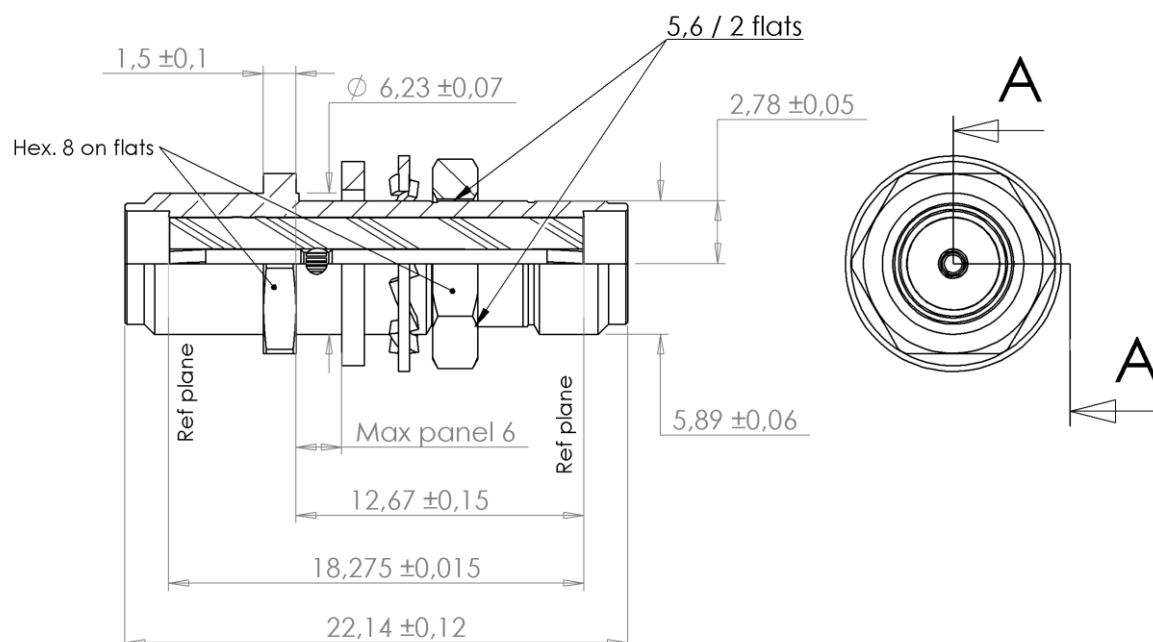

All dimensions are in mm.

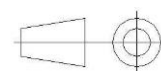

COMPONENTS	MATERIALS	PLATING (μm)
Body	STAINLESS STEEL	PASSIVATED
Center contact	BERYLLIUM COPPER	GOLD 1.3 OVER NICKEL2
Outer contact		
Insulator	PTFE	
Gasket		
Others parts	STAINLESS STEEL	PASSIVATED
-	-	-
-	-	-

PAGE 2/2

ISSUE 2032A

SERIES SMA-X

PART NUMBER R125720121X

PACKAGING

Standard	Unit	Other
1	-	Contact us

ELECTRICAL CHARACTERISTICS

Impedance	50	Ω
Frequency	0-22	GHz
VSWR	* + 0,0000	x F(GHz) Maxi
Insertion loss	0.02+0.05	√F(GHz) dB Maxi
RF leakage	- (80	- F(GHz)) dB Maxi
Voltage rating	500	Vrms Maxi
Dielectric withstanding voltage	1000	Vrms mini
Insulation resistance	5000	MΩ mini

ENVIRONMENTAL

Operating temperature	-65/+165	°C
Hermetic seal		Atm.cm3/s
Panel leakage		

MECHANICAL CHARACTERISTICS

Center contact retention		
Axial force – Mating End	27	N mini
Axial force – Opposite end	27	N mini
Torque	2.8	N.cm mini
Recommended torque		
Mating	80-120	N.cm
Panel nut	150	N.cm
Mating life	500	Cycles Maxi
Weight	5,0000	g Maxi

SPECIFICATION

RAD-GEN-CONN 001
RAD-DET-CONN 004

OTHER CHARACTERISTICS

Assembly instruction:

Others: