

PAGE 1/2

ISSUE 2029A

SERIES SMA-X

PART NUMBER R125500001X

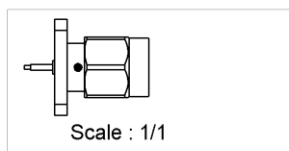
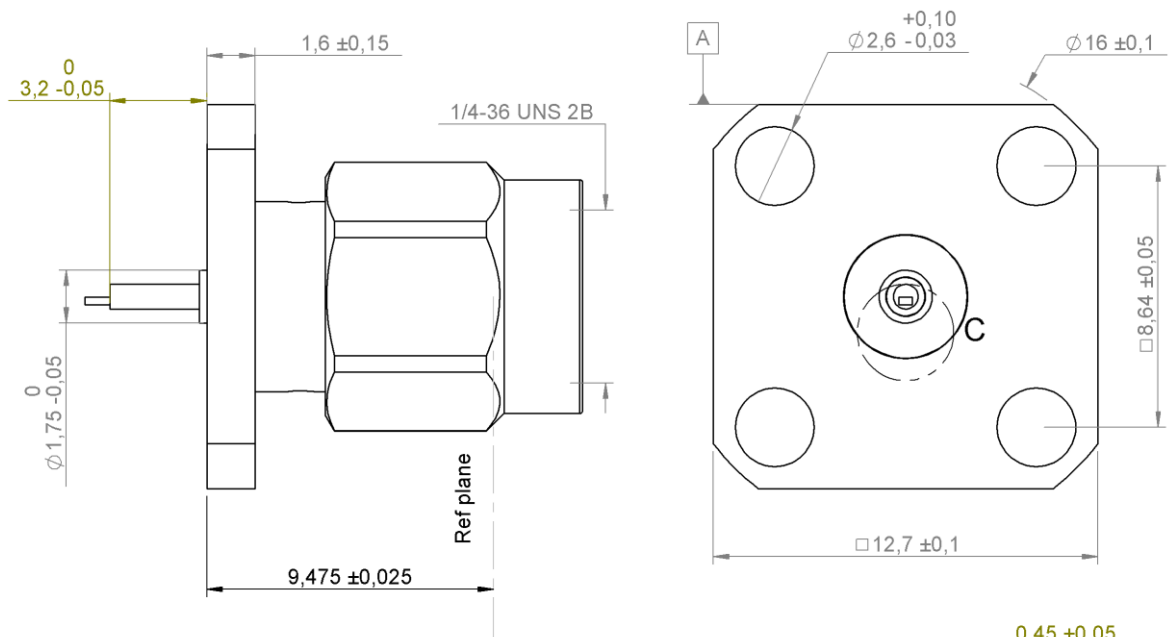

PANEL CUT OUT

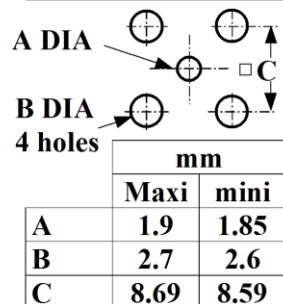

All dimensions are in mm.

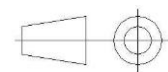

COMPONENTS	MATERIALS	PLATING (µm)
Body	X8CrNiS18-9 - S30300	PASSIVATED
Center contact	CuBe2Pb H - C17300	GOLD 1.3 OVER NICKEL2
Outer contact		
Insulator	PTFE	
Gasket	SILICONE 60 SHORE A, RED	
Others parts	X8CrNiS18-9 - S30300	PASSIVATED
-	-	-
-	-	-

PAGE 2/2

ISSUE **2029A**

SERIES **SMA-X**

PART NUMBER **R125500001X**

PACKAGING

Standard	Unit	Other
1	-	Contact us

ELECTRICAL CHARACTERISTICS

Impedance	50	Ω
Frequency	0-18	GHz
VSWR	1.06 + 0,0025	x F(GHz) Maxi
Insertion loss	0.02+0.07*	\sqrt{F} (GHz) dB Maxi
RF leakage	- (60	- F(GHz)) dB Maxi
Voltage rating	500	Vrms Maxi
Dielectric withstanding voltage	1000	Vrms mini
Insulation resistance	5000	M Ω mini

MECHANICAL CHARACTERISTICS

Center contact retention		
Axial force – Mating End	27	N mini
Axial force – Opposite end	27	N mini
Torque	2.8	N.cm mini
Recommended torque		
Mating	80-120	N.cm
Panel nut	NA	N.cm
Mating life	500	Cycles Maxi
Weight	4,4000	g Maxi

ENVIRONMENTAL

Operating temperature	-65/+165	°C
Hermetic seal	NA	Atm.cm3/s
Panel leakage	NA	

SPECIFICATION

RAD-GEN-CONN 001
RAD-DET-CONN 002

OTHER CHARACTERISTICS

Assembly instruction:

Others: