

PAGE 1/2

ISSUE 2028A

SERIES SMA-X

PART NUMBER R125415000X

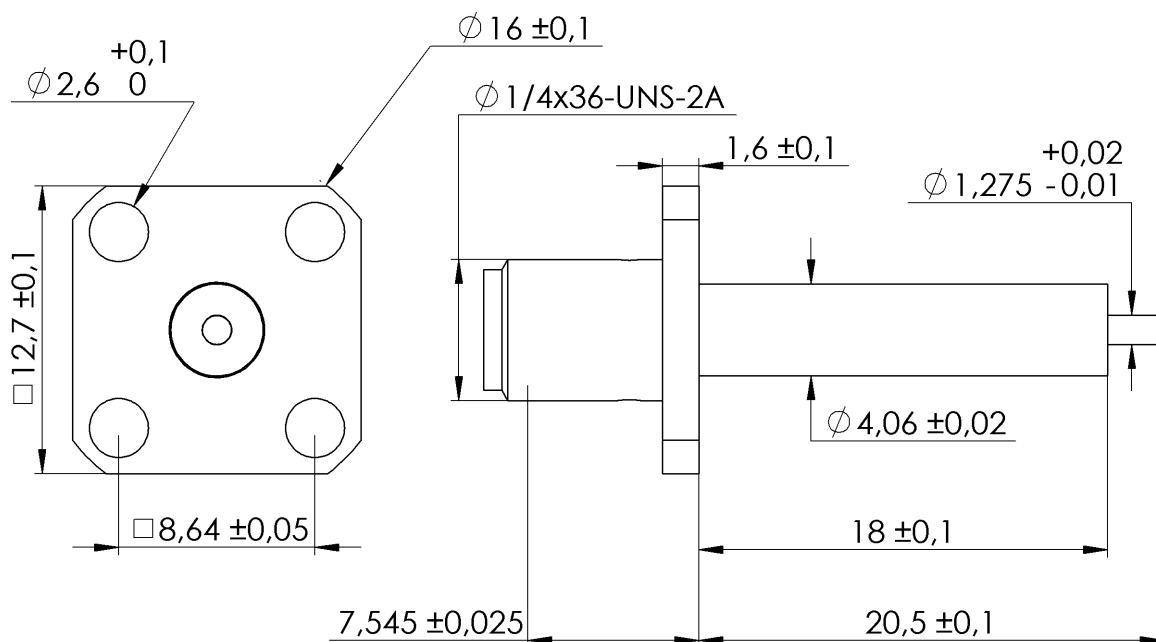

## PANEL CUT OUT

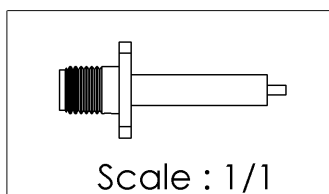
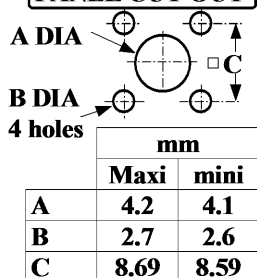

All dimensions are in mm.

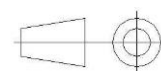

COMPONENTS	MATERIALS	PLATING (μm)
Body	STAINLESS STEEL	GOLD 1.3 OVER NICKEL 1.3
Center contact	BERYLLIUM COPPER	GOLD 1.3 OVER NICKEL 1.3
Outer contact		
Insulator	PTFE	
Gasket		
Others parts		
-	-	-
-	-	-

PAGE 2/2

ISSUE 2028A

SERIES SMA-X

PART NUMBER R125415000X

## PACKAGING

Standard	Unit	Other
1	-	Contact us

## ELECTRICAL CHARACTERISTICS

Impedance	50	Ω
Frequency	DC-18	GHz
VSWR	1.06 + 0,0020	x F(GHz) Maxi
Insertion loss	0.02+0.07*	√F(GHz) dB Maxi
RF leakage	- ( 60	- F(GHz)) dB Maxi
Voltage rating	500	Vrms Maxi
Dielectric withstanding voltage	1000	Vrms mini
Insulation resistance	5000	MΩ mini

## MECHANICAL CHARACTERISTICS

Center contact retention		
Axial force – Mating End	27	N mini
Axial force – Opposite end	27	N mini
Torque	2.8	N.cm mini
Recommended torque		
Mating	80-120	N.cm
Panel nut	NA	N.cm
Mating life	500	Cycles Maxi
Weight	4,5000	g Maxi

## ENVIRONMENTAL

Operating temperature	-65 +165	°C
Hermetic seal	NA	Atm.cm3/s
Panel leakage	NA	

## SPECIFICATION

RAD-GEN-CONN 001  
RAD-DET-CONN 002

## OTHER CHARACTERISTICS

Assembly instruction:

Others: