

PAGE 1/2

ISSUE **0549**

SERIES **SMA-X**

PART NUMBER **R125403001X**

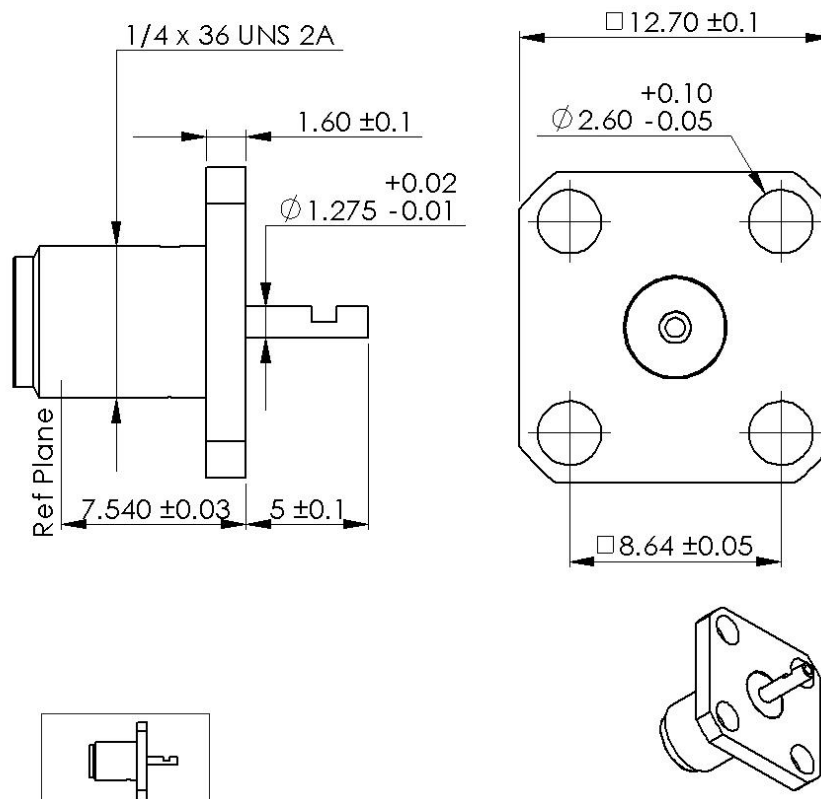

All dimensions are in mm.

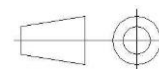

COMPONENTS	MATERIALS	PLATING (µm)
Body	<b>INOX</b>	<b>PASSIVATED.</b>
Center contact	<b>BERYLLIUM COPPER</b>	<b>GOLD 1.3 OVER NICKEL2</b>
Outer contact		
Insulator	<b>PTFE</b>	
Gasket		
Others parts		
-	-	-
-	-	-

PAGE 2/2

ISSUE **0549**

SERIES **SMA-X**

PART NUMBER **R125403001X**

### PACKAGING

Standard	Unit	Other
<b>1</b>	-	<b>Contact us</b>

### ELECTRICAL CHARACTERISTICS

Impedance	<b>50</b>	$\Omega$
Frequency	<b>0-18</b>	GHz
VSWR	<b>1.04 + 0,0040</b>	x F(GHz) Maxi
Insertion loss	<b>0.02+0.05</b>	$\sqrt{F}$ (GHz) dB Maxi
RF leakage	- ( <b>60</b> )	- F(GHz)) dB Maxi
Voltage rating	<b>500</b>	Vrms Maxi
Dielectric withstanding voltage	<b>1000</b>	Vrms mini
Insulation resistance	<b>5000</b>	M $\Omega$ mini

### MECHANICAL CHARACTERISTICS

Center contact retention		
Axial force – Mating End	<b>27</b>	N mini
Axial force – Opposite end	<b>27</b>	N mini
Torque	<b>2.8</b>	N.cm mini
Recommended torque		
Mating	<b>80-120</b>	N.cm
Panel nut		N.cm
Mating life	<b>500</b>	Cycles Maxi
Weight	<b>3,2000</b>	g Maxi

### ENVIRONMENTAL

Operating temperature	<b>-65 +165</b>	°C
Hermetic seal		Atm.cm3/s
Panel leakage		

### SPECIFICATION

**RAD-GEN-CONN 001**  
**RAD-DET-CONN 003**

### OTHER CHARACTERISTICS

Assembly instruction:

Others: