

PAGE 1/2

ISSUE **2028A**

SERIES **SMA-X**

PART NUMBER **R125403000X**

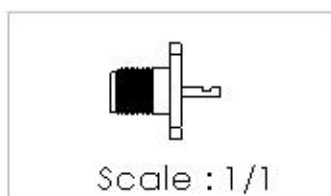
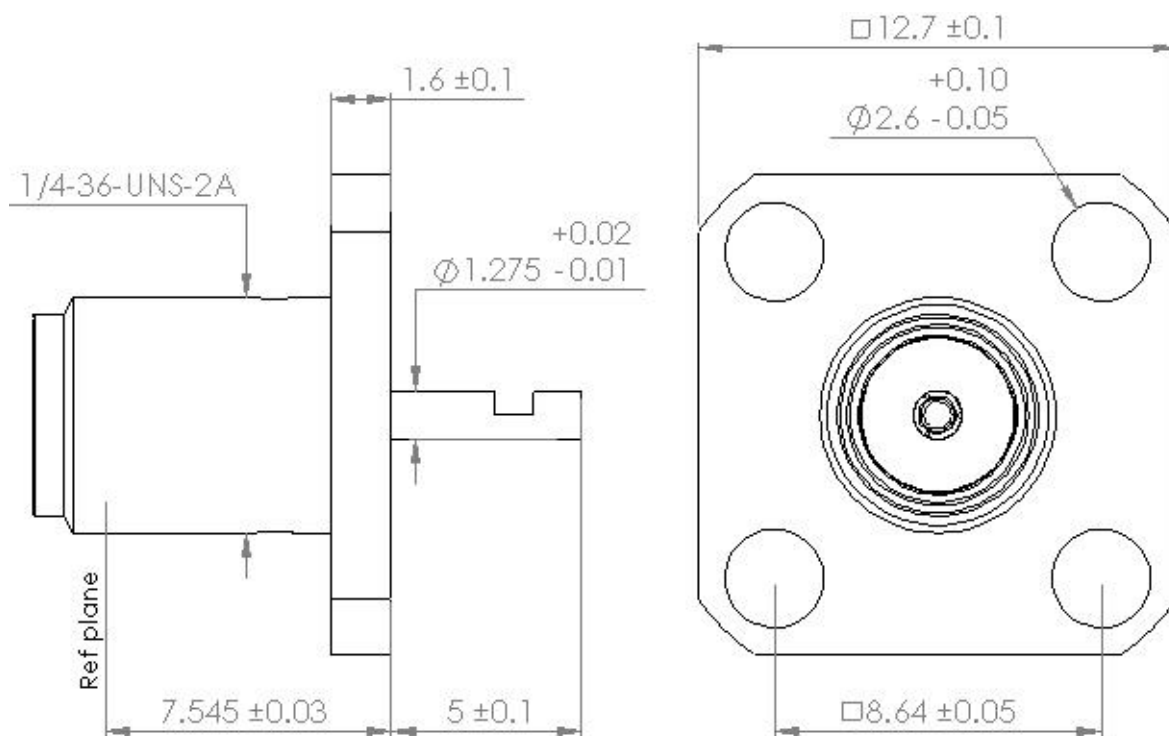

All dimensions are in mm.

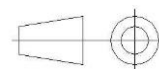

COMPONENTS	MATERIALS	PLATING (μm)
Body	<b>STAINLESS STEEL</b>	<b>GOLD 1.3 OVER NICKEL2</b>
Center contact	<b>BERYLLIUM COPPER</b>	<b>GOLD 1.3 OVER NICKEL2</b>
Outer contact		
Insulator	<b>PTFE</b>	
Gasket		
Others parts		
-	-	-
-	-	-

PAGE 2/2

ISSUE 2028A

SERIES SMA-X

PART NUMBER R125403000X

## PACKAGING

Standard	Unit	Other
1	-	Contact us

## ELECTRICAL CHARACTERISTICS

Impedance		50	Ω
Frequency		0-18	GHz
VSWR	1.04	+	0,0040 x F(GHz) Maxi
Insertion loss		0.02+0.05	√F(GHz) dB Maxi
RF leakage	- (	100	- F(GHz) dB Maxi
Voltage rating		500	Vrms Maxi
Dielectric withstanding voltage		1000	Vrms mini
Insulation resistance		5000	MΩ mini

## MECHANICAL CHARACTERISTICS

Center contact retention			
Axial force – Mating End		27	N mini
Axial force – Opposite end		27	N mini
Torque		2.8	N.cm mini
Recommended torque			
Mating		80-120	N.cm
Panel nut			N.cm
Mating life		500	Cycles Maxi
Weight		3,2000	g Maxi

## ENVIRONMENTAL

Operating temperature	-65 +165	°C
Hermetic seal		Atm.cm3/s
Panel leakage		

## SPECIFICATION

**RAD-GEN-CONN 001**  
**RAD-DET-CONN 003**

## OTHER CHARACTERISTICS

Assembly instruction:

Others: