

PAGE 1/2

ISSUE 22-03-22

SERIE : SPnT

PART NUMBER : R573152420

## RF CHARACTERISTICS

Number of ways : 4  
Frequency range : 0 - 12.4 GHz  
Impedance : 50 Ohms

Frequency (GHz)	DC - 3	3 - 8	8 - 12.4
VSWR max	1.20	1.35	1.50
Insertion loss max	0.20 dB	0.35 dB	0.50 dB
Isolation min	80 dB	70 dB	60 dB
Average power (*)	400 W	250 W	200 W

## ELECTRICAL CHARACTERISTICS

Actuator : LATCHING  
Nominal current \*\* : 320 mA / RESET : 1280 mA \*\*\*\*  
Actuator voltage (Vcc) : 12V (10.2 to 13V)  
Terminals : solder pins (250°C max. / 30 sec.)  
Indicator rating : 1 W / 30 V / 100 mA  
Self cut-off time : 40 ms < CT < 120 ms  
TTL inputs (E) - High level : 2.2 to 5.5 V / 800µA at 5.5 V  
- Low level : 0 to 0.8 V / 20µA at 0.8 V

## MECHANICAL CHARACTERISTICS

Connectors : N female per MIL-C 39012  
Life : 2 million cycles per position  
Switching Time\*\*\* : < 15 ms  
Construction : Splashproof  
Weight : < 460 g

## ENVIRONMENTAL CHARACTERISTICS

Operating temperature range : -40°C to +85°C  
Storage temperature range : -55°C to +85°C

(\* Average power at 25°C per RF Path)

(\*\* At 25° C ±10%)

(\*\*\* Nominal voltage ; 25° C)

(\*\*\*\* Reset : supply voltage time 1sec. max. / duty cycle 10%)



PAGE 2/2

ISSUE 22-03-22

SERIE : SPnT

PART NUMBER : R573152420

DRAWING

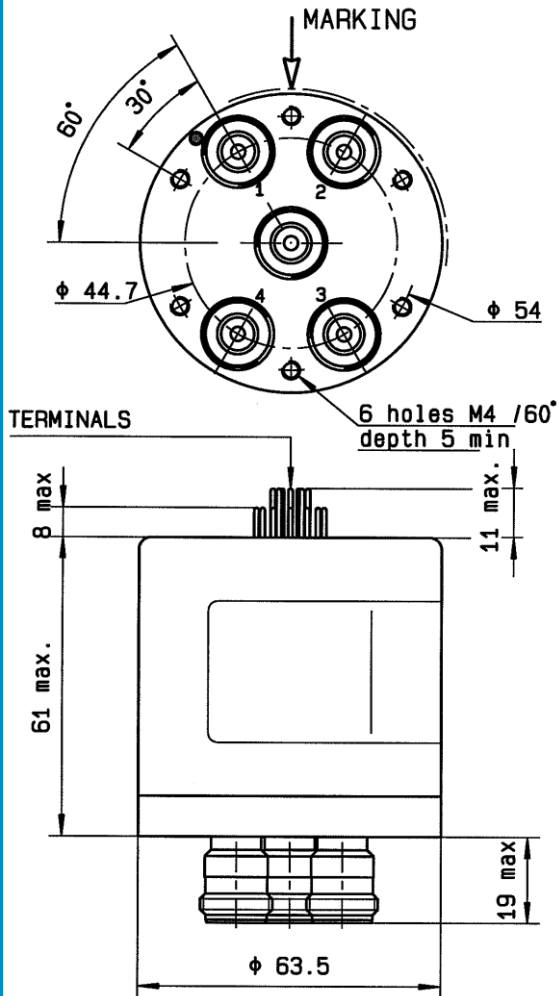

General tolerances :  $\pm 0,5$  mm [0,02 in]

TTL input	RF Continuity	Ind.
RESET = 1	All ports open	- -
E1 = 1	IN $\leftrightarrow$ 1	D.E
E2 = 1	IN $\leftrightarrow$ 2	D.F
E3 = 1	IN $\leftrightarrow$ 3	D.G
E4 = 1	IN $\leftrightarrow$ 4	D.H

LABEL

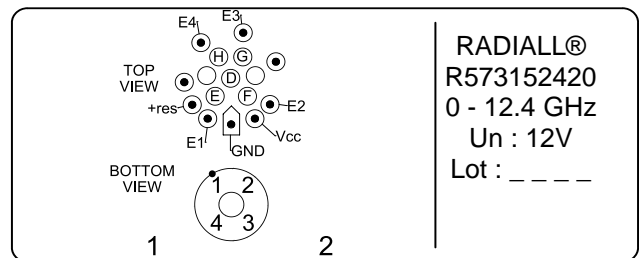

SCHEMATIC DIAGRAM

