

PAGE **1/2**

ISSUE **30.01.15**

SERIE : **SPnT**

PART NUMBER : **R573133605**

## RF CHARACTERISTICS

Number of ways : **6**  
 Frequency range : **0 - 12.4 GHz**  
 Impedance : **50 Ohms**

| Frequency (GHz)    | DC - 3         | 3 - 8          | 8 - 12.4       |
|--------------------|----------------|----------------|----------------|
| VSWR max           | <b>1.20</b>    | <b>1.35</b>    | <b>1.50</b>    |
| Insertion loss max | <b>0.20 dB</b> | <b>0.35 dB</b> | <b>0.50 dB</b> |
| Isolation min      | <b>80 dB</b>   | <b>70 dB</b>   | <b>60 dB</b>   |
| Average power (*)  | <b>400 W</b>   | <b>250 W</b>   | <b>200 W</b>   |

## ELECTRICAL CHARACTERISTICS

Actuator : **LATCHING**  
 Nominal current \*\* : **125 mA / RESET : 750 mA \*\*\*\***  
 Actuator voltage (Vcc) : **28V (24 to 30V) / NEGATIVE COMMON**  
 Terminals : **25 pins D-SUB male connector**  
 Indicator rating : **1 W / 30 V / 100 mA**

## MECHANICAL CHARACTERISTICS

Connectors : **N female per MIL-C 39012**  
 Life : **2.000.000 cycles per position**  
 Switching Time\*\*\* : **< 15 ms**  
 Construction : **Splashproof**  
 Weight : **< 460 g**

## ENVIRONMENTAL CHARACTERISTICS

Operating temperature range : **-40°C to +85°C**  
 Storage temperature range : **-55°C to +85°C**

(\* Average power at 25°C per RF Path)

(\*\* At 25° C ±10%)

(\*\*\* Nominal voltage ; 25° C)

(\*\*\*\* Reset : supply voltage time 1sec. max. / duty cycle 10%)



PAGE 2/2

ISSUE 30.01.15

SERIE : SPnT

PART NUMBER : R573133605

DRAWING

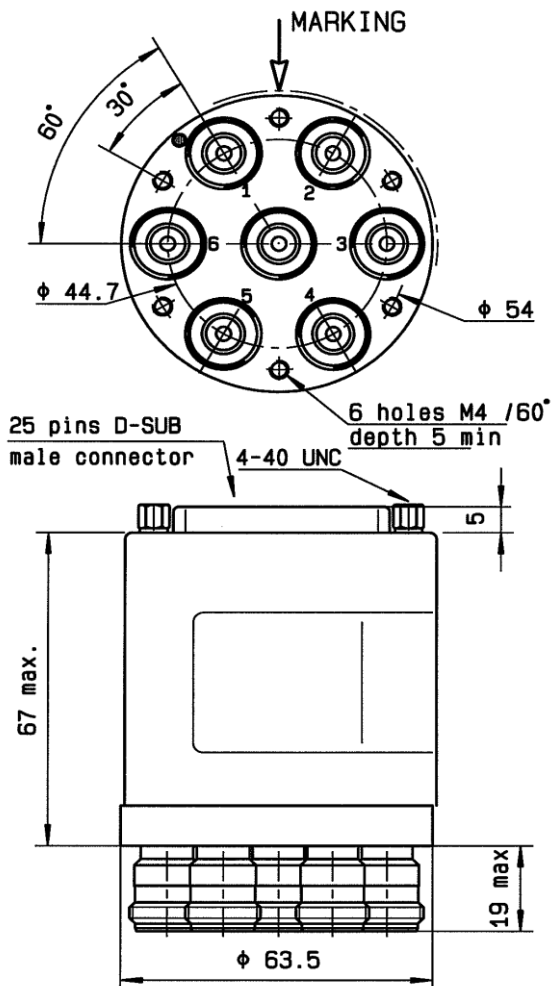

| Voltage   | RF Continuity  | Ind. |
|-----------|----------------|------|
| -C +RESET | All ports open | - -  |
| -C +1     | IN ↔ 1         | D.E  |
| -C +2     | IN ↔ 2         | D.F  |
| -C +3     | IN ↔ 3         | D.G  |
| -C +4     | IN ↔ 4         | D.H  |
| -C +5     | IN ↔ 5         | D.I  |
| -C +6     | IN ↔ 6         | D.J  |

**LABEL**

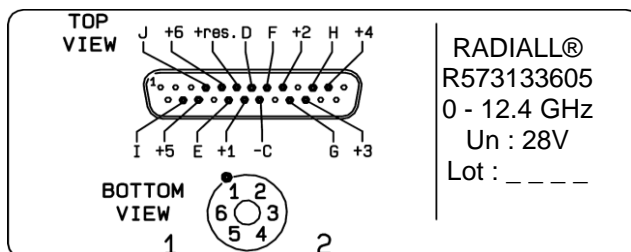

General tolerances : ±0.5 mm

SCHEMATIC DIAGRAM

