

PAGE 1/2

ISSUE 10-07-19

SERIE : DPDT

PART NUMBER : R577E32005

RF CHARACTERISTICS

Frequency range : 0 - 6 GHz
Impedance : 50 Ohms

Frequency (GHz)	DC - 3	3 - 6
VSWR max	1.20	1.30
Insertion loss max	0.20 dB	0.30 dB
Isolation min	80 dB	70 dB
Average power (*)	240 W	170 W

ELECTRICAL CHARACTERISTICS

Actuator : LATCHING
Nominal current ** : 320 mA
Actuator voltage (Vcc) : 12V (10.2 to 13V) / NEGATIVE COMMON
Terminals : 9 pins D-SUB male connector

MECHANICAL CHARACTERISTICS

Connectors : QMA female per MIL-C 39012
Life : 2.5 million cycles
Switching Time*** : < 15 ms
Construction : Splashproof
Weight : < 100 g

ENVIRONMENTAL CHARACTERISTICS

Operating temperature range : -40°C to +85°C
Storage temperature range : -55°C to +85°C

(*) Average power at 25°C per RF Path)

(** At 25° C ±10%)

(***) Nominal voltage ; 25° C)



PAGE 2/2

ISSUE 10-07-19

SERIE : DPDT

PART NUMBER : R577E32005

DRAWING

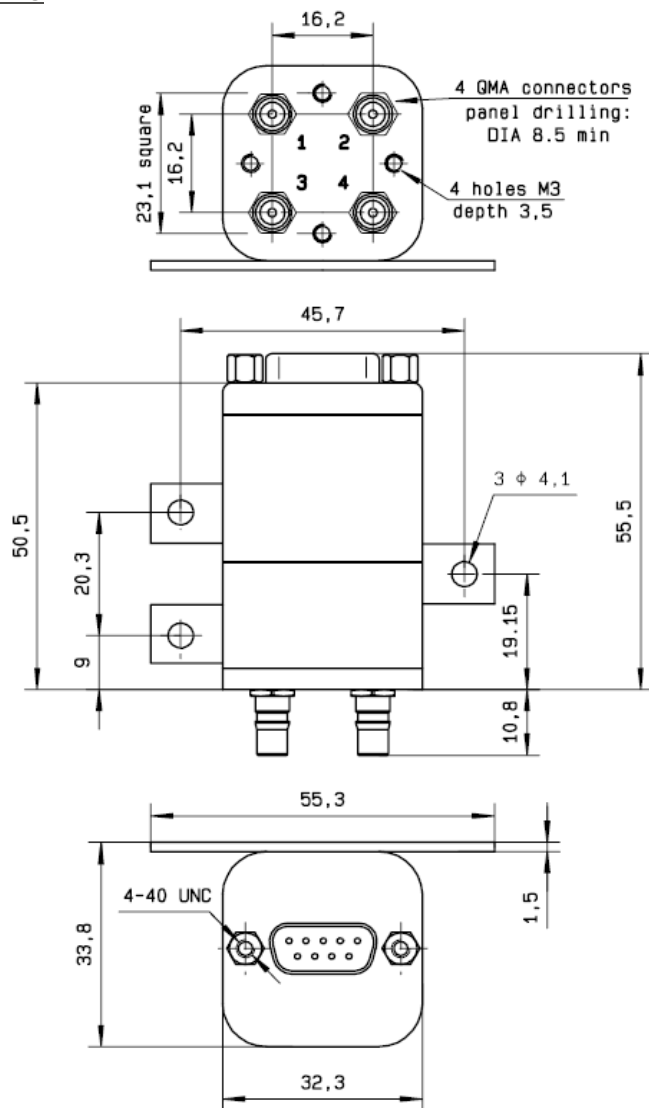

General tolerances : $\pm 0,5$ mm [0,02 in]

LABEL

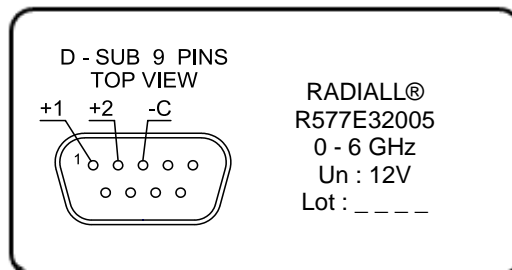

SCHEMATIC DIAGRAM

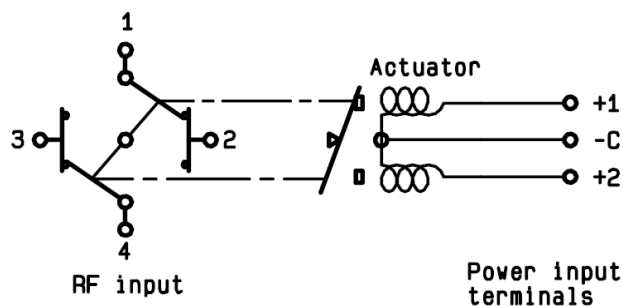

Voltage	RF Continuity
-C +1	1 ↔ 3 / 2 ↔ 4
-C +2	1 ↔ 2 / 3 ↔ 4