

PAGE 1/2

ISSUE 29-09-21A

SERIES SPPC

PART NUMBER SPPC-PWL-2.0-LS-L1-BR-S-150-M

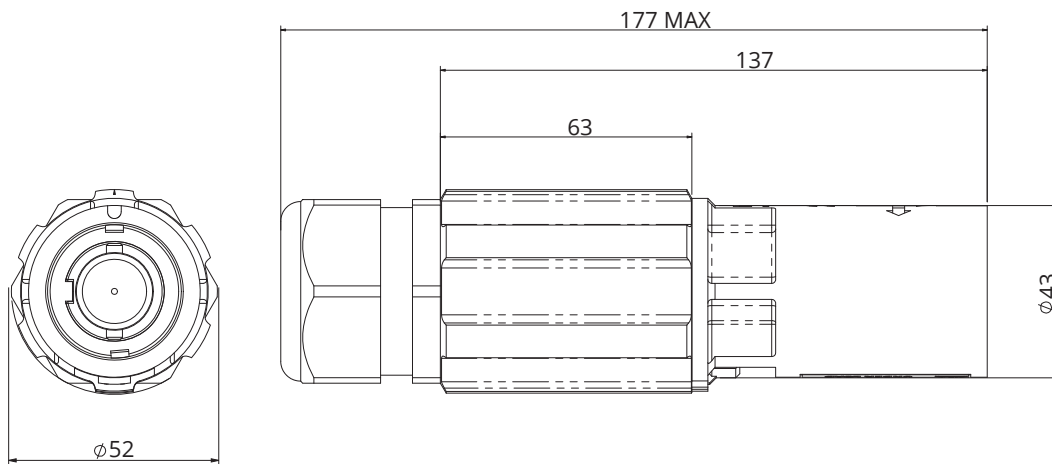
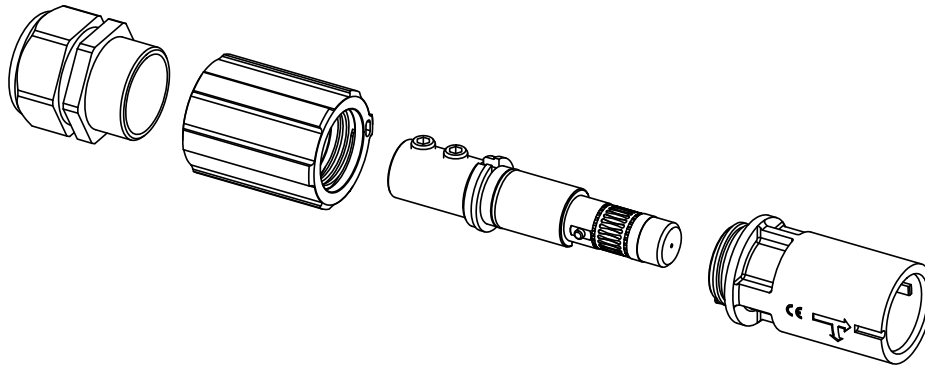

*Dimensions in mm*

### Code details

Series Code	SPPC-PWL-2.0	Single Pole Power connectors
Connector Type	LS	Cable/Line Source
Key Position	L1	Phase 1
Insulator Color	BR 	Brown
Contact Termination	S-150	Screw terminal – 500A up to 150mm <sup>2</sup>
Cable External diameter	M	19mm – 28mm
Contacts Type	-	Standard contacts
Customization	-	-

PAGE 2/2

ISSUE 29-09-21A

SERIES SPPC

PART NUMBER SPPC-PWL-2.0-LS-L1-BR-S-150-M

**Connector Type:**

Number of contacts: Single Pole  
 Cable/line Source connectors  
 Brown Color  
 Locking: Bayonet with secondary locking pin  
 Screw terminal contacts for wire up to 150mm<sup>2</sup>  
 Finger Touch protected contacts IP2X

**Reference Documents:**

- EN 61984
- EN 60529
- European Directive 2011/65/UE (RoHS)
- UL94

**General features:**

Operating temperatures: -30°C ÷ +125°C  
 Protection degree (mated connectors; according to EN 60529): IP66/67  
 Flammability: UL94-V0  
 Minimum Mating Cycles: 500

**Electrical specifications:**

Nominal Voltage: 1000 Vac / 1500 Vdc  
 Current Rating: 500A  
 Minimum Insulation Resistance: 5GΩ @ 500V  
 Contact Resistance: <0.1 mΩ  
 Rated Voltage to Earth: 2000Vac  
 Minimum Flashover (EN60309-1): 6.8kV AC – 1 minute  
 Test Voltage (Mated Condition): 5 kV– 1 minute @ 50Hz  
 Short Circuit Current – 1 second: 16kA  
 Short Circuit Current – 3 seconds: 12kA  
 Surge Current (DIN VDE 0102/1.90): 62kA – 10mseconds

**Others characteristics:**

Screws Tightening Torque (in-line connectors): 12Nm  
 Cable Gland Tightening Torque: 13Nm  
 Contact Retention in Insulator: 2.5kN Axial Load  
 Sleeves included, for cable conductor size 35 mm<sup>2</sup> - 50 mm<sup>2</sup> - 70 mm<sup>2</sup> - 95 mm<sup>2</sup> - 120/150 mm<sup>2</sup>

UL certified (File n° E483437)



COMPONENTS	MATERIALS	PLATING / FINISHES	ACCESSORIES (included)		
Shells	Thermoplastic	-	P/N	Description	Quantity
Contacts	Copper Alloy	Silver Plated	-	-	-
Panel Gasket	-	-	-	-	-
Others part	-	-	-	-	-

**PACKAGING**

Quantity	Type	Weight
1	Plastic Bags	-
-	Carton Box	-

Radiall VanSystem S.r.l. | www.radiall.com