

PAGE 1/2

ISSUE 06-07-21D

SERIES SPPC

PART NUMBER SPPC-PWL-LS-N-BU-C-185-OS

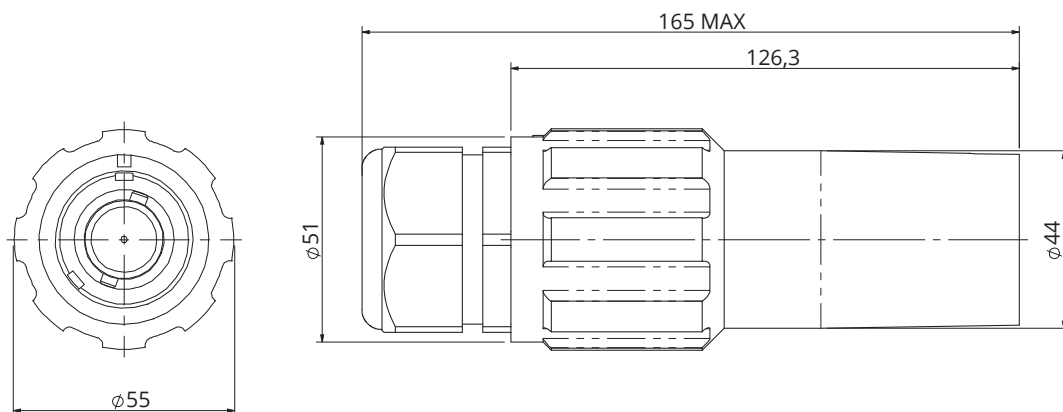
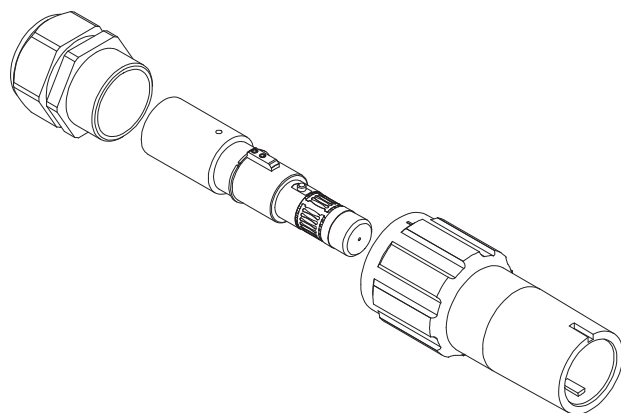

*Dimensions in mm*

#### Code details

<b>Series Code</b>	<b>SPPC-PWL</b>	Single Pole Power connectors
<b>Connector Type</b>	<b>LS</b>	Cable/Line Source
<b>Key Position</b>	<b>N</b>	Neutral
<b>Insulator Color</b>	<b>BU</b> 	Blue
<b>Contact Termination</b>	<b>C-185</b>	Crimp contacts – 750A 185 mm <sup>2</sup>
<b>Cable External diameter</b>	<b>OS</b>	22mm – 32mm
<b>Contacts Type</b>	-	Standard contacts
<b>Customization</b>	-	-

PAGE 2/2

ISSUE 06-07-21D

SERIES SPPC

PART NUMBER SPPC-PWL-LS-N-BU-C-185-OS

**Connector Type:**

Number of contacts: Single Pole  
 Cable/line Source connectors  
 Blue Color  
 Locking: Bayonet with secondary locking pin  
 Crimp terminal contacts for wire 185 mm<sup>2</sup>  
 Finger Touch protected contacts IP2X

**Reference Documents:**

- EN 61984
- EN 60529
- European Directive 2011/65/UE (RoHS)
- UL94

**General features:**

Operating temperatures: -30°C ÷ +125°C  
 Protection degree (mated connectors; according to EN 60529): IP66/67  
 Flammability: UL94-V0  
 Minimum Mating Cycles: 500

**Electrical specifications:**

Nominal Voltage: 1000 Vac / 1500 Vdc  
 Current Rating: 750A  
 Minimum Insulation Resistance: 5GΩ @ 500V  
 Contact Resistance: <0.1 mΩ  
 Rated Voltage to Earth: 2000Vac  
 Minimum Flashover (EN60309-1): 6.8kV AC – 1 minute  
 Test Voltage (Mated Condition): 5 kV– 1 minute @ 50Hz  
 Short Circuit Current – 1 second: 16kA  
 Short Circuit Current – 3 seconds: 12kA  
 Surge Current (DIN VDE 0102/1.90): 62kA – 10mseconds

**Others characteristics:**

Cable Gland Tightening Torque: 13Nm  
 Contact Retention in Insulator: 2.5kN Axial Load

VDE Certified



COMPONENTS	MATERIALS	PLATING / FINISHES
Shells	Thermoplastic	-
Contacts	Copper Alloy	Silver Plated
Panel Gasket	-	-
Others part	-	-

Cable Size	185mm <sup>2</sup>	185mm <sup>2</sup>
	Class 2	Class 5
Insulation Strip (dim L)	40mm	40mm
Recommended Number of Crimps	2	2
Hand Operated Crimp Tool	HT120 HT131-C	HT120 HT131-C
Crimp Die Set	ME48-C	ME48-C
Contact Removal Tool	VS390039	VS390039

**PACKAGING**

Quantity	Type	Weight
1	Plastic Bags	-
-	Carton Box	-