

PAGE 1/2	ISSUE 07-11-18B	SERIES R2CT	PART NUMBER R2CT157000
----------	-----------------	-------------	------------------------

Dimensions in mm

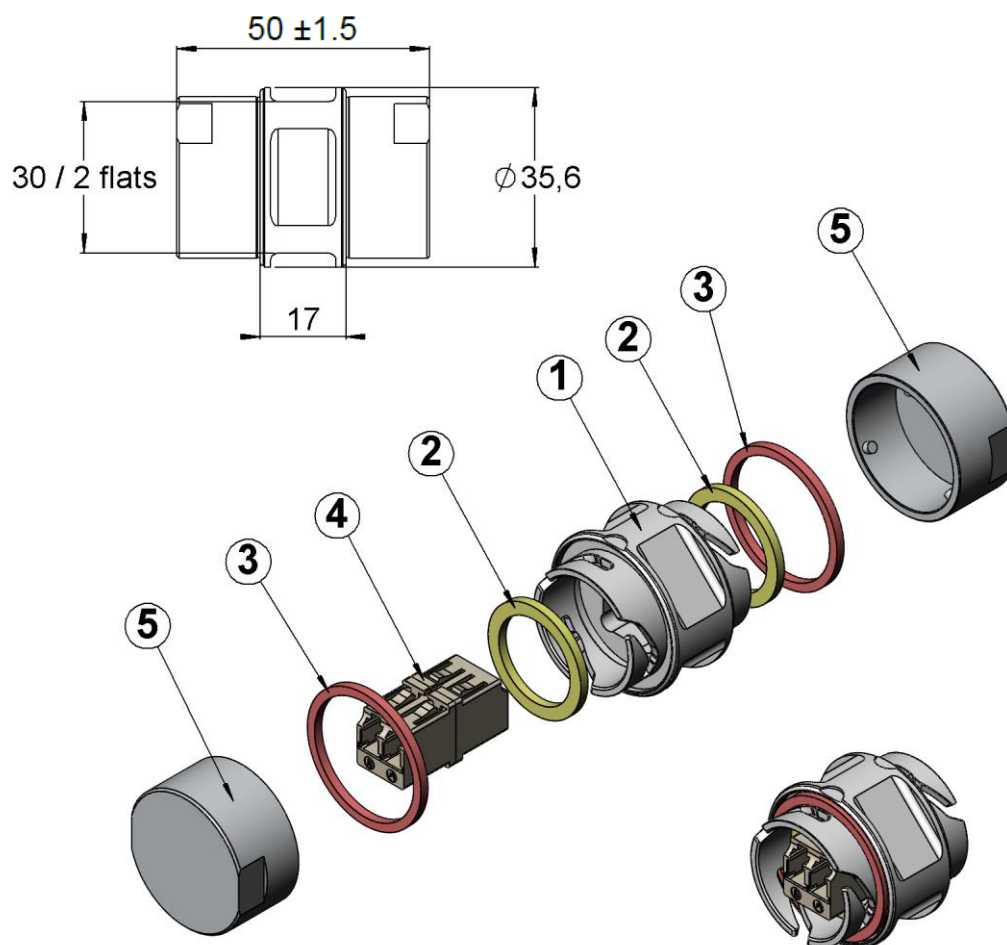

DESCRIPTION

REP	COMPONENT	MATERIALS	PLATING
1	ADAPTOR BODY	ALUMINIUM	-
2	GASKET PANEL SEALING	SILICONE	-
3	GASKET CONNECTION SEALING	SILICONE	-
4	MM LC DUPLEX ADAPTOR (BEIGE)	-	-
5	PROTECTION CAP	ALUMINIUM	-

PAGE 2/2	ISSUE 07-11-18B	SERIES R2CT	PART NUMBER R2CT157000
----------	------------------------	--------------------	-------------------------------

Dimensions in mm

GENERAL CHARACTERISTICS

Mechanical Endurance Vibrations	IEC 613000-2-2 In accordance with IEC 61300-2-1 IEC 60721-3-4 class 4M5 ETSI EN 300 019-2-4	100 mating cycles compliant
Optical Signal Alignment sleeve Other information	- - -	Multimode Zirconia See technical data sheet F727.750.700 (LC DPLX MM ADAPTOR)
Environmental Protection class Operating temperature	IEC 60529 IEC 61300-2-22	IP65 -40°C to +85°C
Weight	61.45 g	
Packaging	30 pieces in one cardboard box (volume = 5 L)	