

C-MTITAN™ INSPECTION GUIDE FOR MICROSCOPE TIP

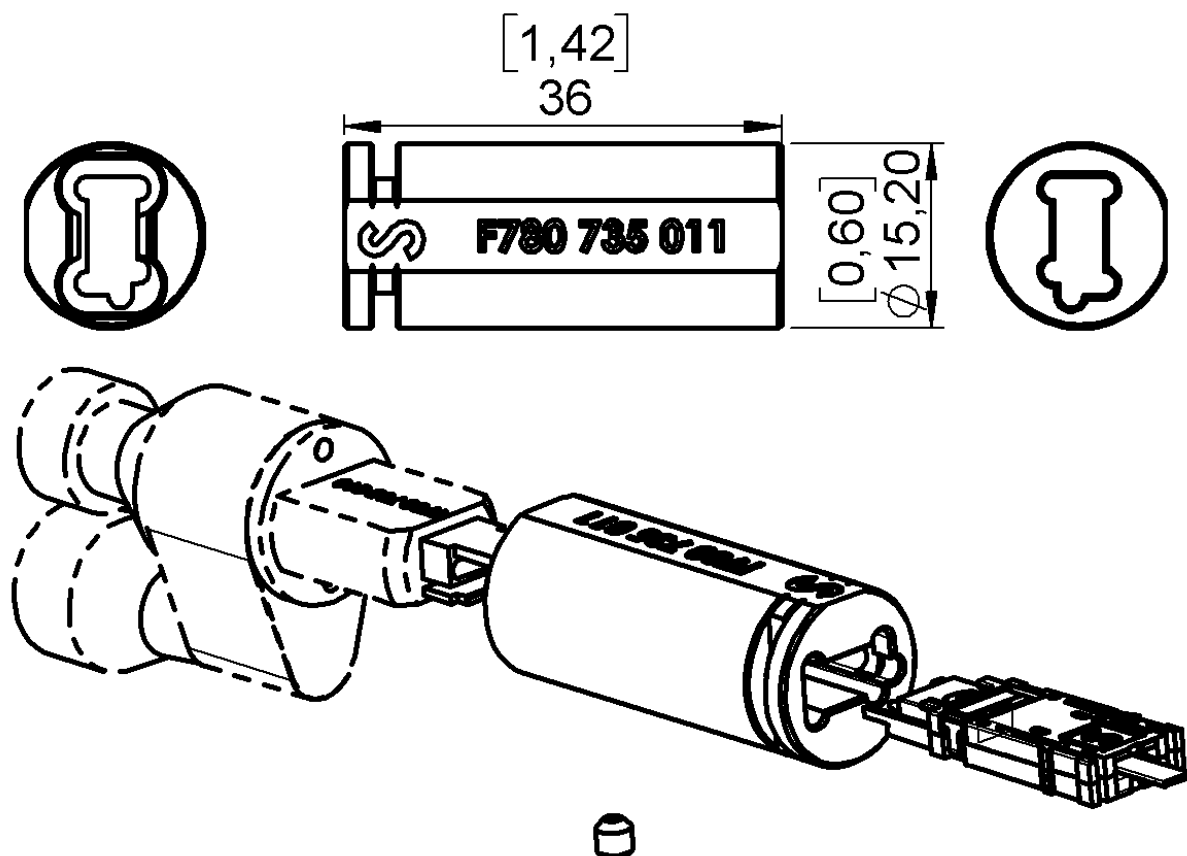

Dimensions in mm [inch]

The inspection guide enables a fast and convenient inspection of the optical end-face of C-MTitan™ contacts. It has to be used with the dedicated tips F780735010 mounted on the microscope probe.

FEATURES:

- Inspection guide for C-MTitan™ visual inspection and F780 735 010
- Compatible with MT ferrule IEC 61754-5 and RADIALL C-MTitan™ cartridges (F735 1xx xxx)
- Refer to Radiall Inspection and cleaning procedure for C-MTitan™: 503 08 830 for further information
- Require allen key 1.5mm (not supplied)

PAGE 2/2

ISSUE 2018/02/20

SERIES C-MTITAN™

PART NUMBER **F780 735 011**

MATERIAL:

Body and screw: stainless steel

ASSEMBLY INSTRUCTION:

Insert the inspection guide on the microscope tip

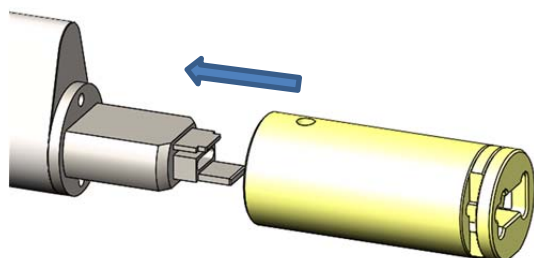

Screw

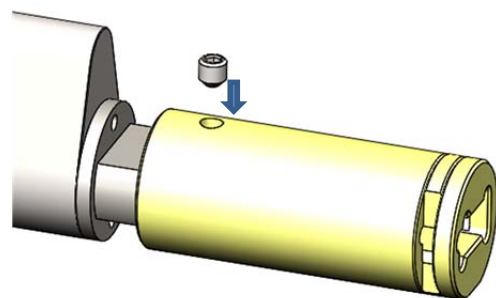

Insert the C-MTitan (align « S »)

