



Series
Adapt.

LC-LUXCIS ML SINGLEMODE PC
DUPLEX ADAPTOR NO FLANGE

Issue:
Nov.26, 2004

Page
1/1

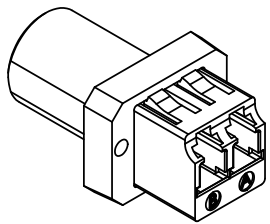
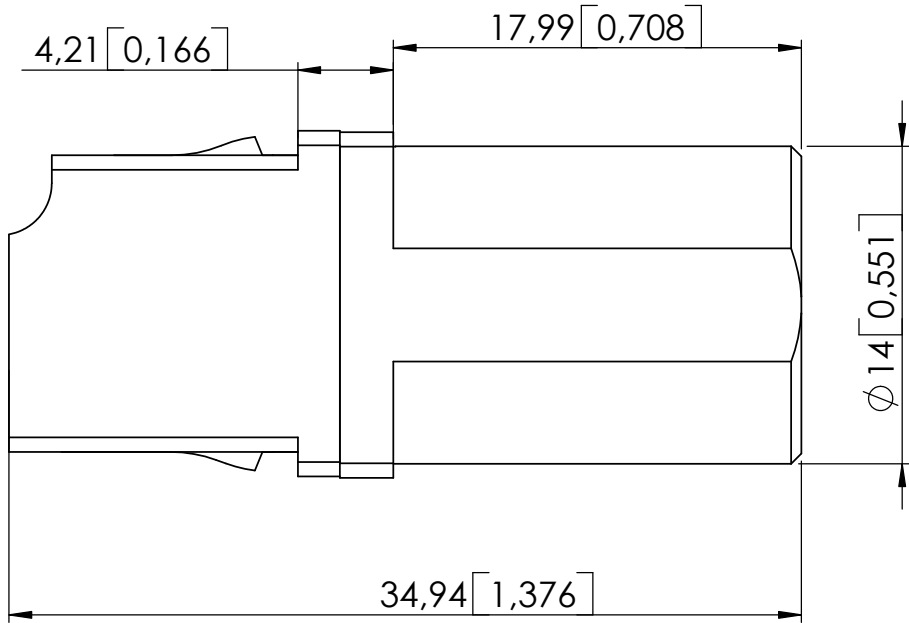
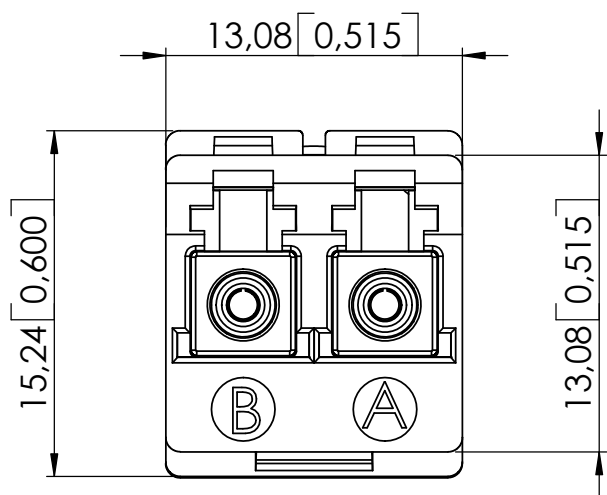

Sca: 1:1

GENERAL

TYPE: Inter series adaptor LC-LUXCIS ML SINGLEMODE PC
LC : IEC 61754-20 (LC)
RJ-45 latching system
LUXCIS : LuxCis ML contact, mono key
Zirconia alignment sleeve

INSERTION/EXTRACTION TOOL: 282 546 (standard M81969/1.03)

PANEL DIMENSIONS: See drawing

CHARACTERISTICS (Depending on fiber or cable construction)

MECHANICAL: - Mechanical endurance : 200 mating cycles

ENVIRONMENTAL: - Storage temperature -40[°C] to +85[°C]
- Operating temperature -40[°C] to +70[°C]

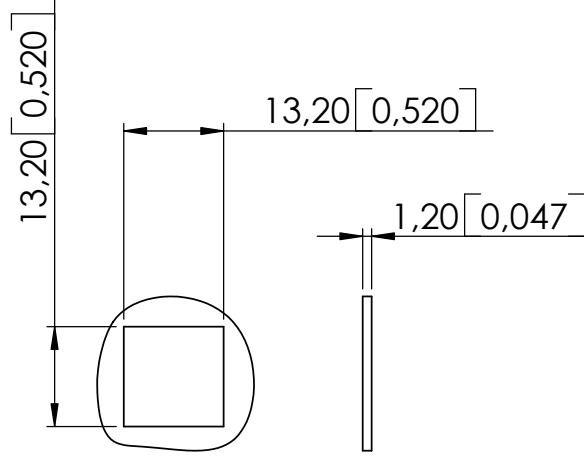

DIMENSIONS: mm (inch) -

CREATION				
PEN: M030400059A				
NAME: PHILIPPEAU S				
DATE: April.14,2004	11/26/04	Change design	PHILIPPEAU	MANNEVY
APPR.: MARIE A.	07/07/04	Specified ML singlemode PC duplex and remove for loose cable structure	PHILIPPEAU	MANNEVY
	Issue	Revisions	Name	Approved