

Series
EPXB

Size 1 EPXB EMI BACKSHELL

Issue:
Feb 19, 2014

Page
1/1

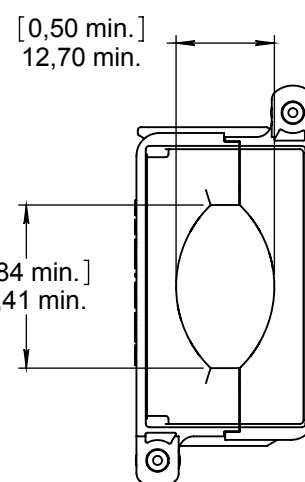
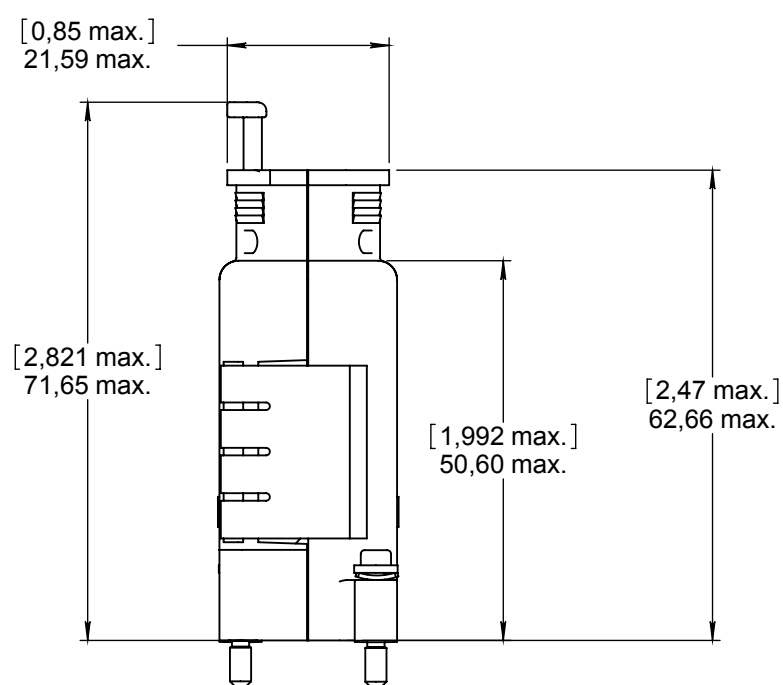
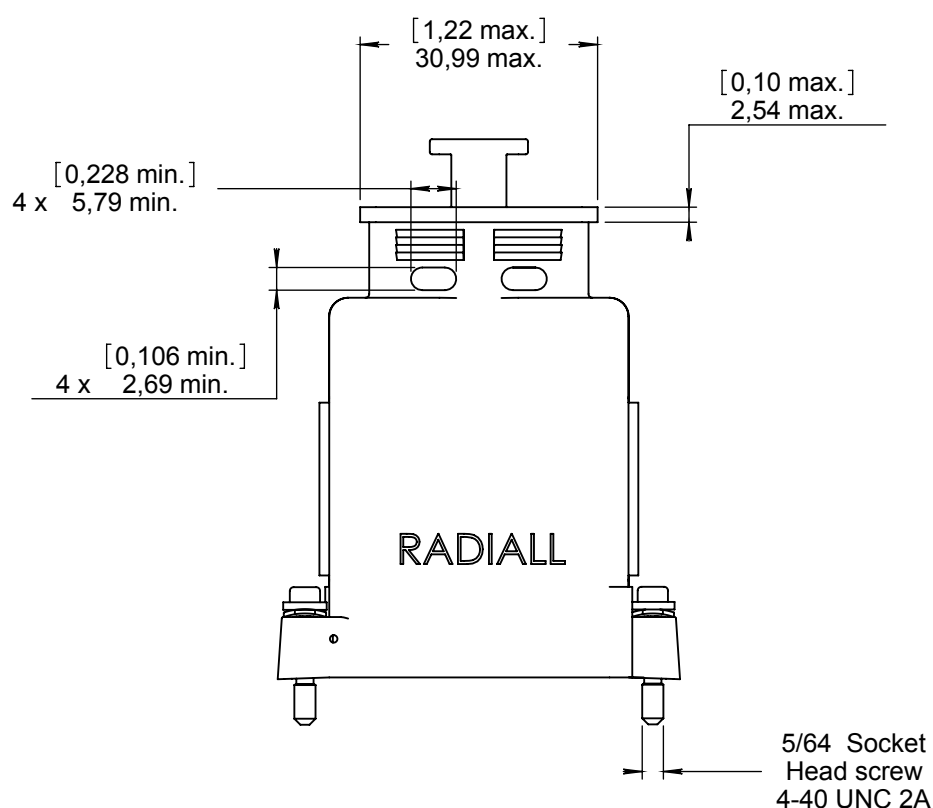
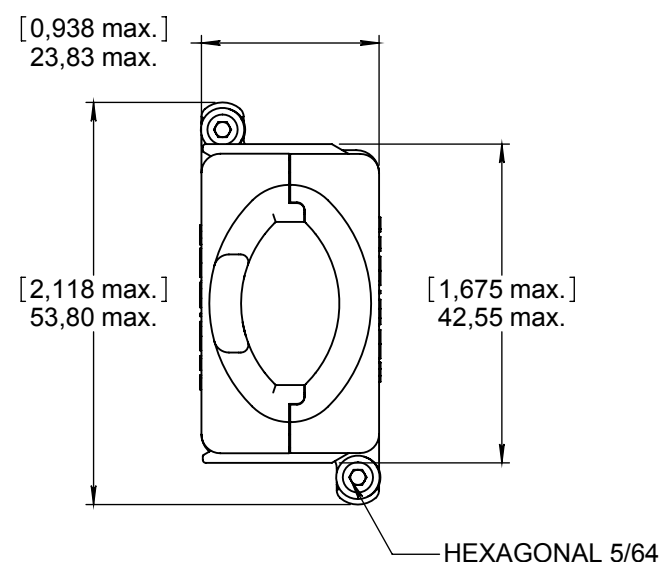
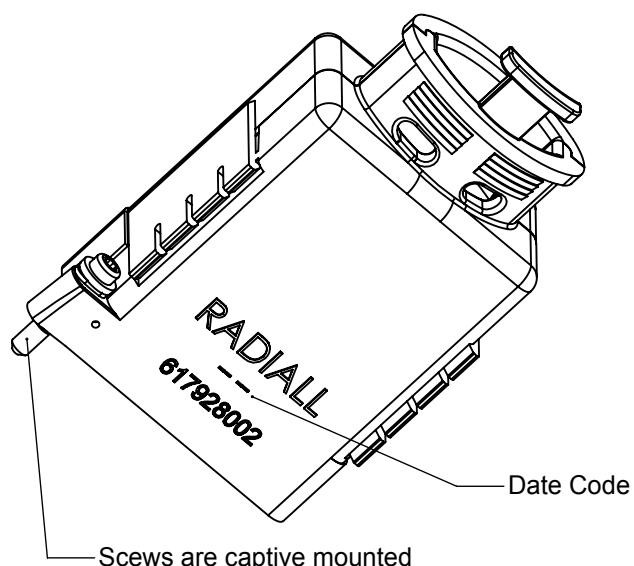

MATERIALS:

- BACKSHELL : HIGH GRADE THERMOPLASTIC PPS
- SCREWS : STAINLESS STEEL
- WASHER : BERYLIUM COPPER

FINISH:

- BACKSHELL : NICKEL PLATED

NOTA:

- 4-40 UNC captive screws locking torque : 0,8 N.m (7 inch. pound)
- Refer to MIBS1700016 for mounting instructions.

DIMENSIONS : mm (inch are given for information only)

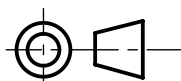

Estimated weight : 31.4 g

CREATION				
PEN: M060009454A				
NOM: REZE C	Feb 19, 2014	Dimension simplified	Ceberio	LeGloahec
DATE: Sep 09, 2007	Aug 24, 2012	Mounting instruction added	Chevreau	LeGloahec
APPR.: WADOUX P	Aug 10, 2012	Estimated weight updated	Chevreau	LeGloahec
	Sep 03, 2007	Dimensions modification	Moyon	Wadoux
	Issue	Revisions	Name	Approved

617928002EN

RADIALl PROPRIETARY INFORMATION