



Series
EPXA

Size 1 EPXA 45° strain relief.

Issue:
Aug 25, 2003

Page
1 / 1

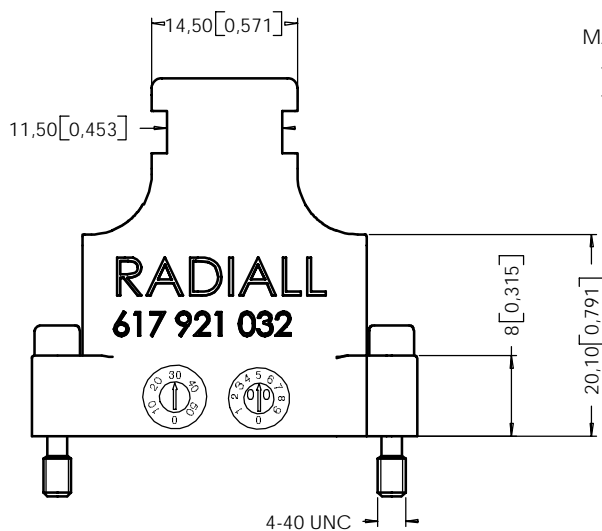
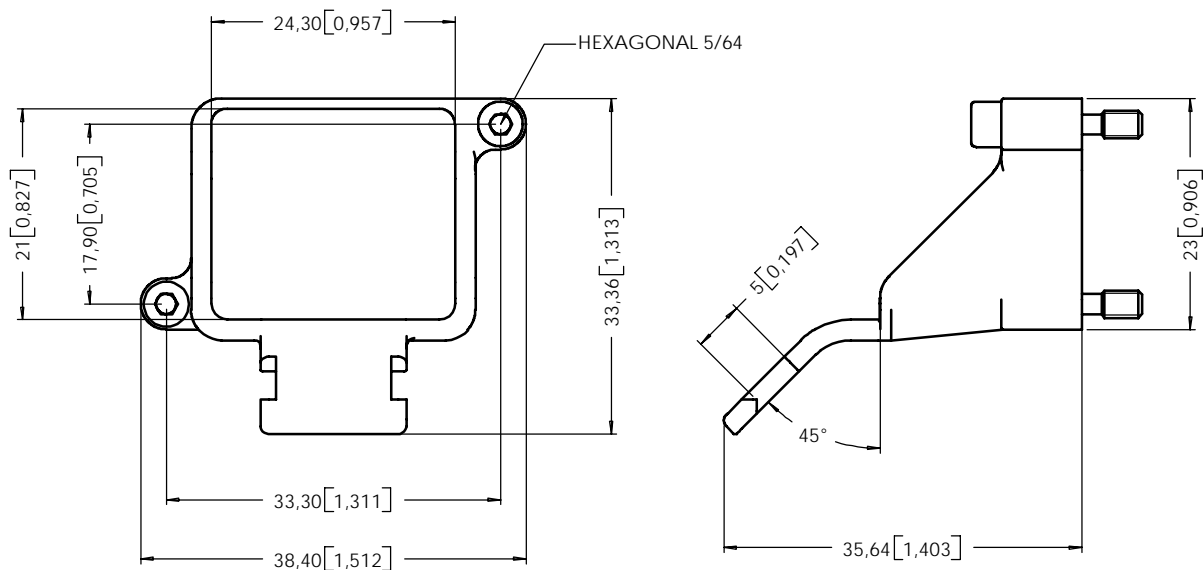

MATERIALS :

- BACKSHELL : HIGH GRADE THERMOPLASTIC
- SCREWS : STAINLESS STEEL 303

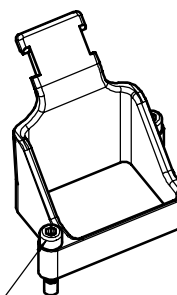

Screws are captive mounted
locking torque for
4-40 screw = 0,8 Nm [7 inchpound]

DIMENSIONS : mm (inch) -

CREATION				
PEN:				
NOM: Marques				
DATE: Aug 25, 03				
APPR.: L.Garcia				
Issue	Revisions	Name	Approved	

617921032EN