



Series  
EPXA

Size 1 EPXA straight strain relief.

Issue:  
Aug 25, 2003

Page  
1 / 1

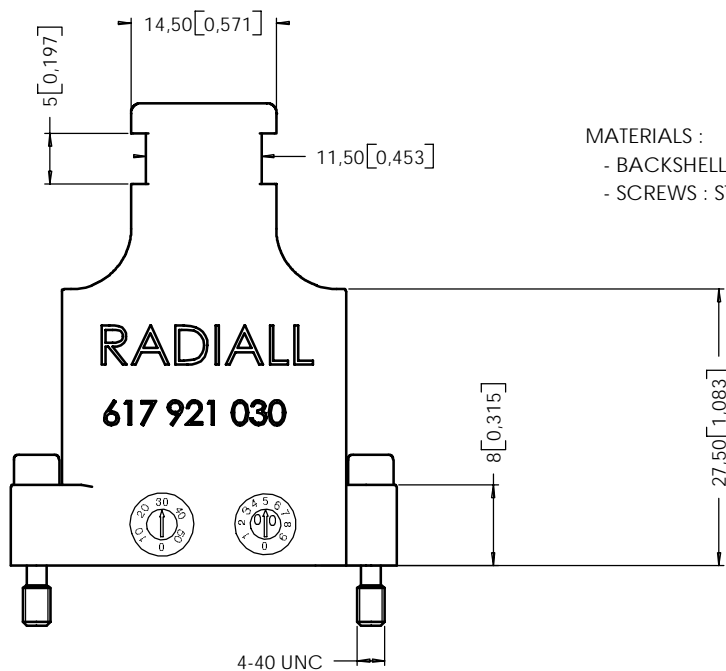
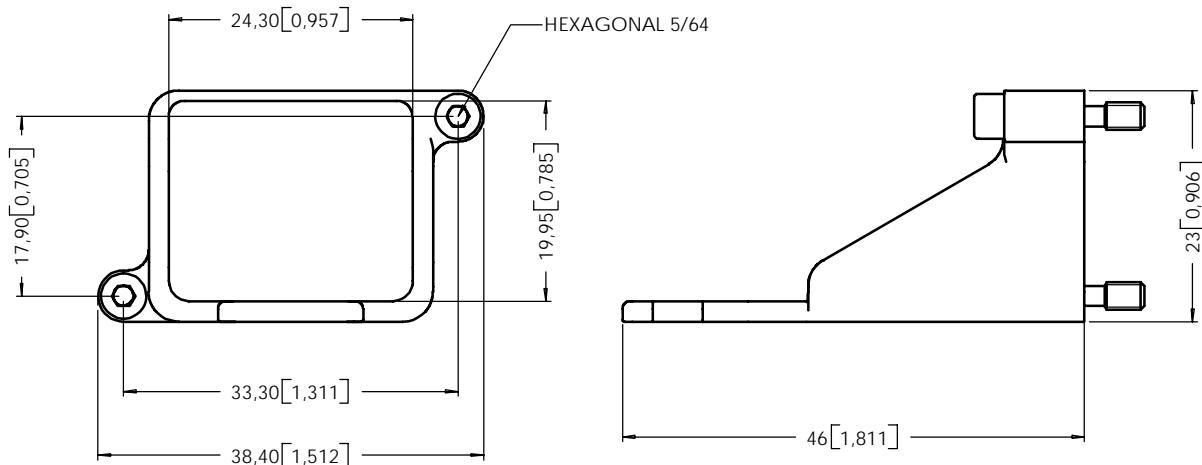

**MATERIALS :**

- BACKSHELL : HIGH GRADE THERMOPLASTIC
- SCREWS : STAINLESS STEEL 303

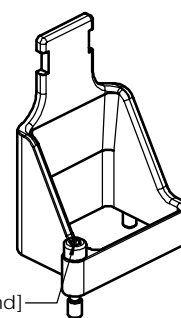

Screws are captive mounted  
locking torque for  
4-40 screw=0,8 Nm [7 inchpound]

DIMENSIONS : mm (inch) -

CREATION				
PEN:				
NOM: Marques				
DATE: Aug 25, 03				
APPR.: L.Garcia				
Issue	Revisions	Name	Approved	

617921030EN