

Series  
EPXB

ENVIRONMENTAL SIZE 8  
CRIMP PIN TRIAX CONTACTS  
FOR TWINAX CABLES MIL C 17/17600002

Issue:  
Apr 05th, 2013

Page  
1/1

## PIN BODY CONTACT WITH SOCKET INTERMEDIATE CONTACT SUBASSEMBLY

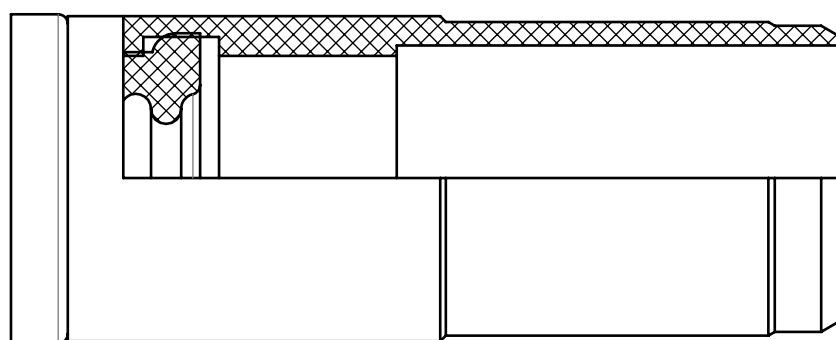
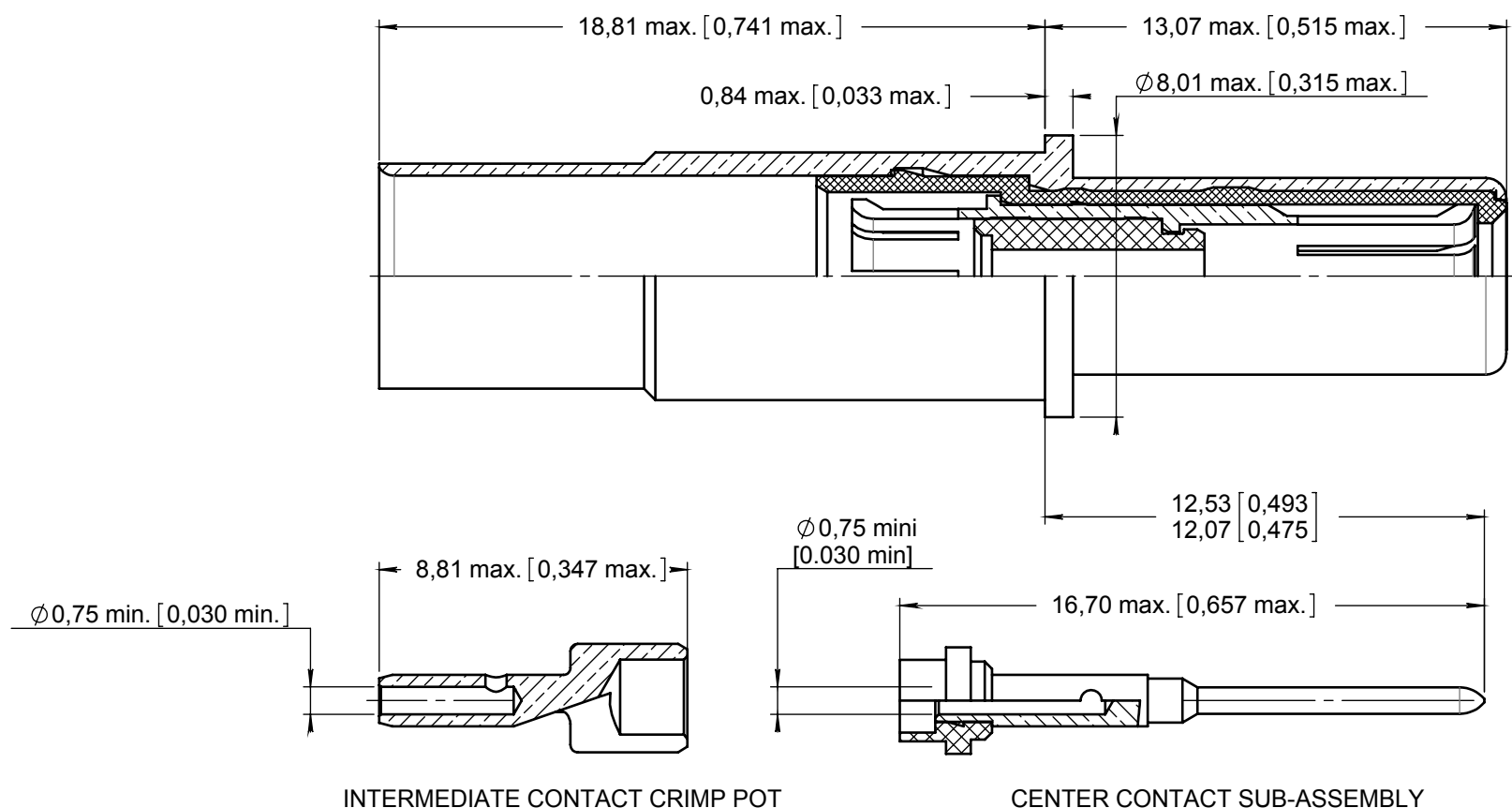

SEALING BOOT

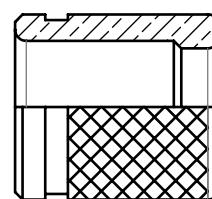

INNER FERRULE

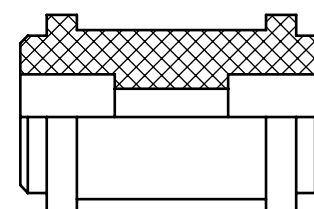

DIELECTRIC SLEEVE

MATERIAL:  
OUTER CONTACT: BRASS  
INTERMEDIATE CONTACT: BERYLLIUM COPPER  
CENTER CONTACT AND INTERMEDIATE CONTACT CRIMP POT: COPPER ALLOY  
INNER FERRULE: BRASS  
DIELECTRIC PARTS DIELECTRIC SLEEVE: PTFE OR EQUIVALENT  
SEALING BOOT: THERMOPLASTIC AND FLUOROSILICONE

FINISH:  
ALL METAL PARTS: GOLD OVER NICKEL PLATED

WIRING INSTRUCTION SEE RP 3364

EXTRACTION TOOL: M81969/28-03 (RADIAL 282 549 001)

DIMENSIONS : mm (inch are given for information only)

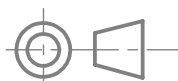

Estimated weight : 4.90 g

CREATION				
PEN: 1012222-1793				
NOM: SURAULT				
DATE: Dec 28th, 2012				
APPR.: LE GLOAHEC Y	Apr 05 <sup>th</sup> , 2013	Color bands removed	CHEVREAU M.	LE GLOAHEC Y.
	Issue	Revisions	Name	Approved

617165022EN

RADIAL PROPRIETARY INFORMATION