

Series  
EPX

SIZE 8 SOCKET BMA CONTACT  
FLOAT MOUNT - FOR UT 085 CABLE

Issue:  
Aug. 27, 2018

Page  
1/1

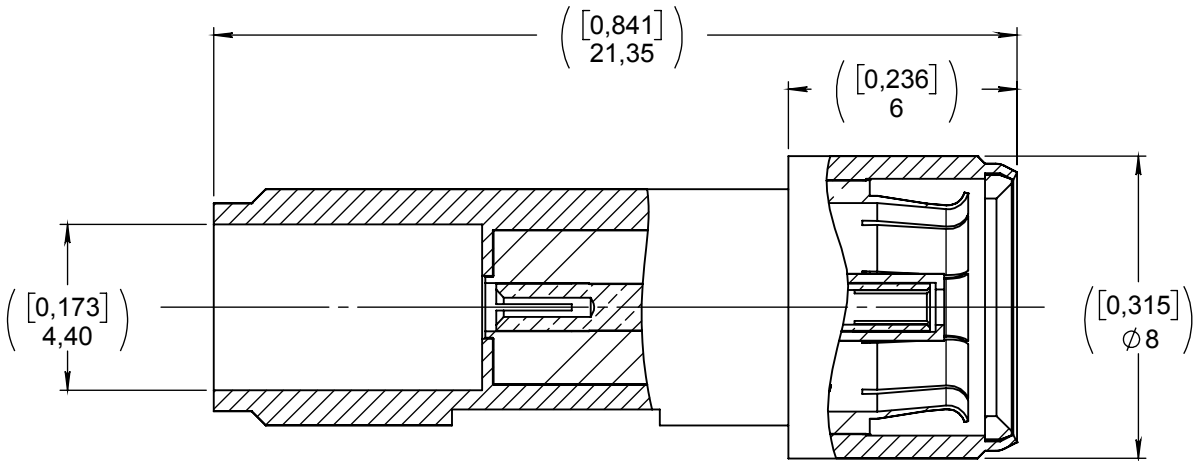

SOCKET CONTACT SUB-ASSEMBLY

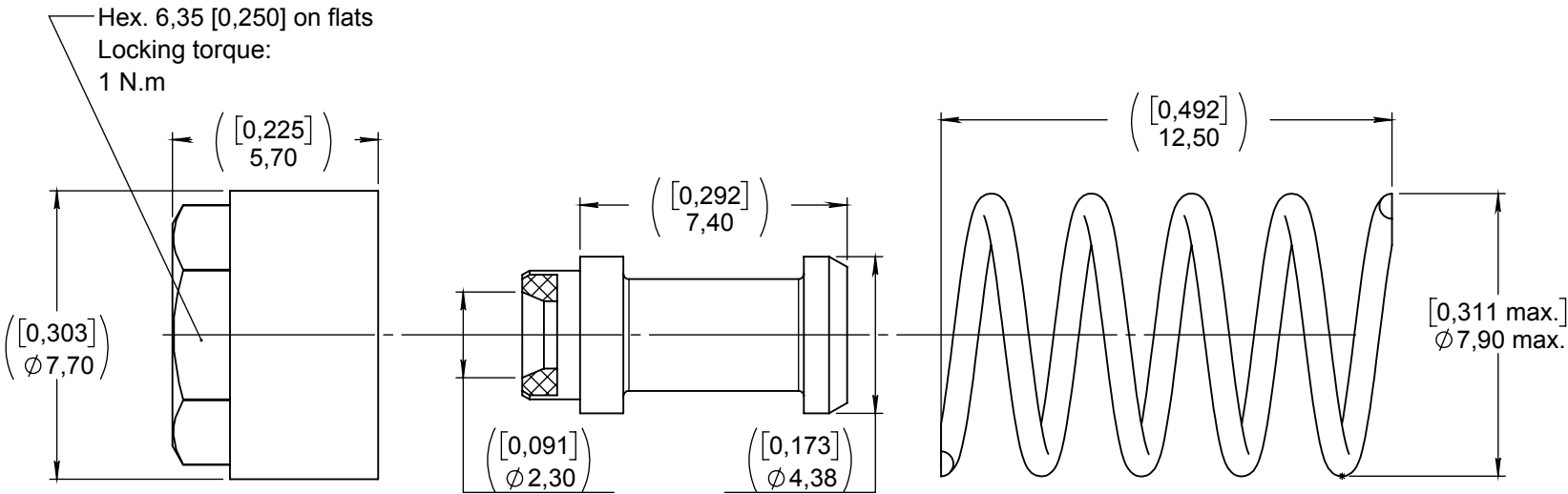

RETAINING NUT

FERRULE

SPRING

MATERIALS & FINISHES :

- OUTER CONTACT : Stainless steel, with Beryllium copper clip, gold over nickel,
- CENTER CONTACT : Copper alloy, Gold over nickel,
- INSULATOR : PTFE or equivalent,
- FERRULE : Brass, gold over Nickel,
- RETAINING NUT, SPRING : Stainless steel.

WIRING INSTRUCTIONS: RP6180

NOTES :

- EXTRACTION TOOL : M81969/28-03 or M81869/14-06 (RADIALL : 282 549 001)

DIMENSIONS : mm (inch are given for information only)

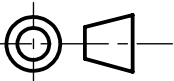

Estimated weight : 29 g

4112_9311	CREATION				
	PEN: 88073				
	NOM: JB				
	DATE: Sep. 18, 1989				
	APPR.:				
	Issue		Revisions	Name	Approved
	Aug. 27, 18		Redrawn on new format	Weihs H.	López C.