

Series  
DSX

FEMALE #5 ADAPTOR  
FOR CT EN4531-101

Issue:  
09/01/2012

Page  
1/1

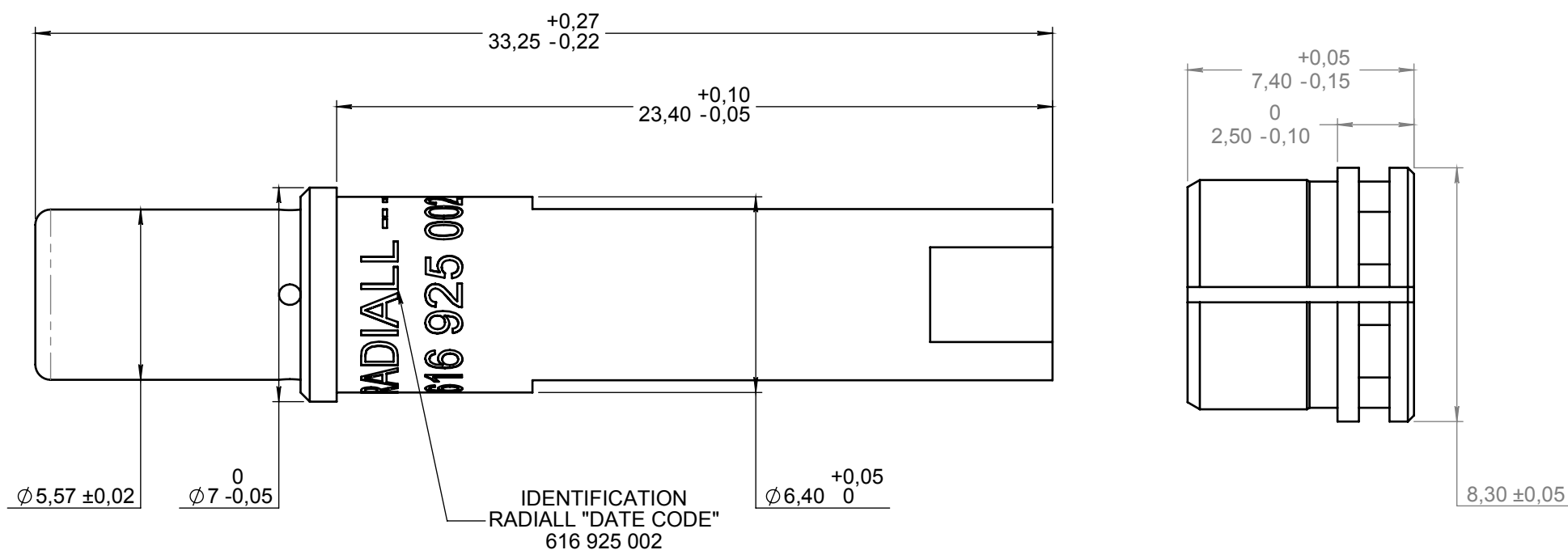

**MATERIAL:**

- SIZE 5 ADAPTATOR : ARCAP AP1D PER UNS C79350
- SET COLLAR : BERYLLIUM COPPER PER ASTM-B-196

REAR EXTRACTION TOOL FOR SIZE 5 ADAPTATOR P/N : 282946 (NOT SUPPLIED)

INSERTION / EXTRACTION TOOL FOR SET COLLAR P/N : 282549038 (NOT SUPPLIED)

- MOUNTING INSTRUCTION : SEE MI AC 16 00000
- FEMALE #5 ADAPTOR WILL BE MOUNTED INTO PIN CONTACT INSERT

**MARKING :**

- PACKAGING MUST BE MARKED WITH : P/N 616925002 + DATE CODE
- INDIVIDUAL PACKAGING

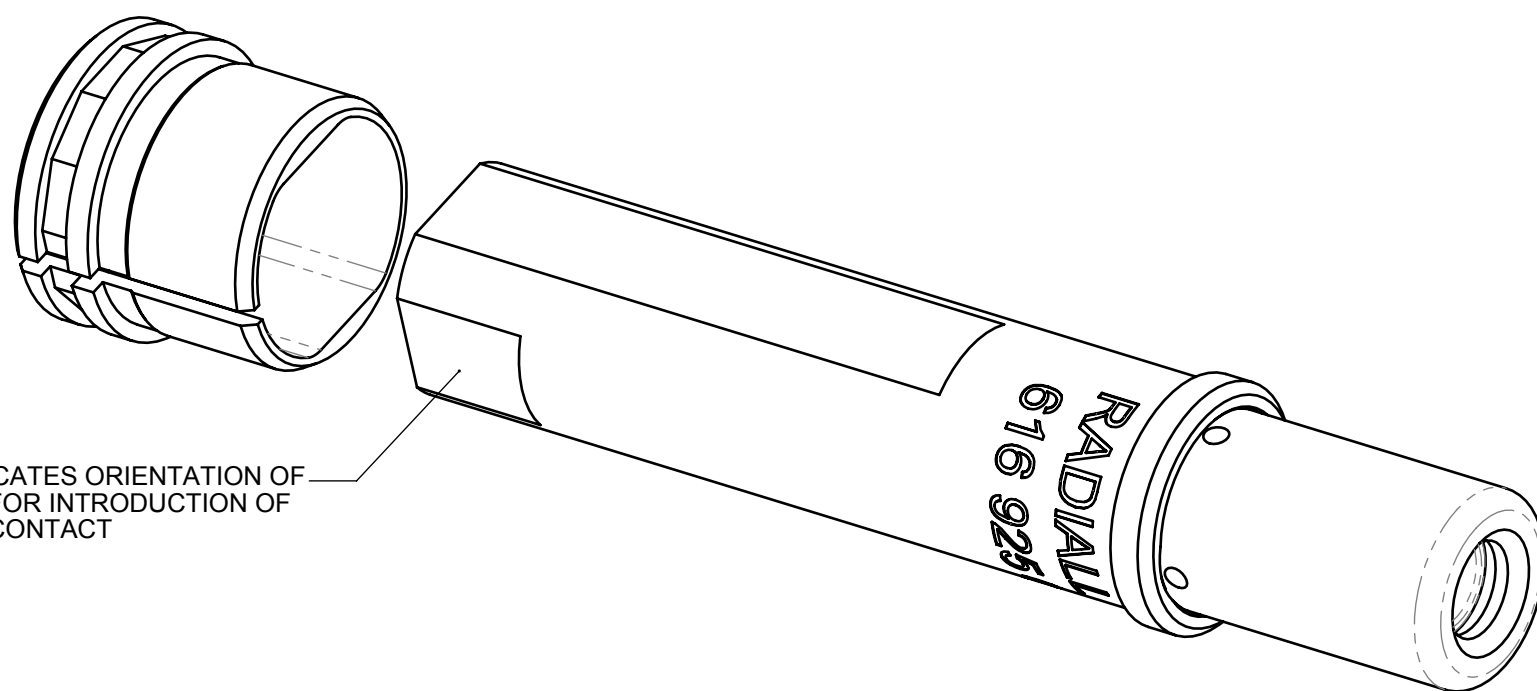

DIMENSIONS : mm (inch are given for information only)

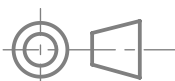

CREATION				
PEN: 2008-11-2139	09/01/12	FLAT ADDED ON REAR OUTER AREA	MOUGIN	/
	07/12/10	WHERE TO BE MOUNTED ADDED	MOUGIN	/
NOM: MOUGIN S.	01/04/10	QUALIFICATION DONE, PRODUCT QUALIFIED	MOUGIN	/
DATE: 30/04/2009	12/02/10	INSERTION/EXTRACTION TOOL AND MOUNTED INSTRUCTION ADDED NEW SET COLLAR AND NEW SECURED ADAPTOR	MOUGIN	/
APPR.:	03/11/09	IDENTIFICATION ADDED	MOUGIN	/
	Issue	Revisions	Name	Approved

616925002EN

RADIAL PROPRIETARY INFORMATION