

PAGE 1/2	ISSUE 13-03-24K	SERIES THT-20	PART NUMBER R331803000
----------	--------------------	---------------	------------------------

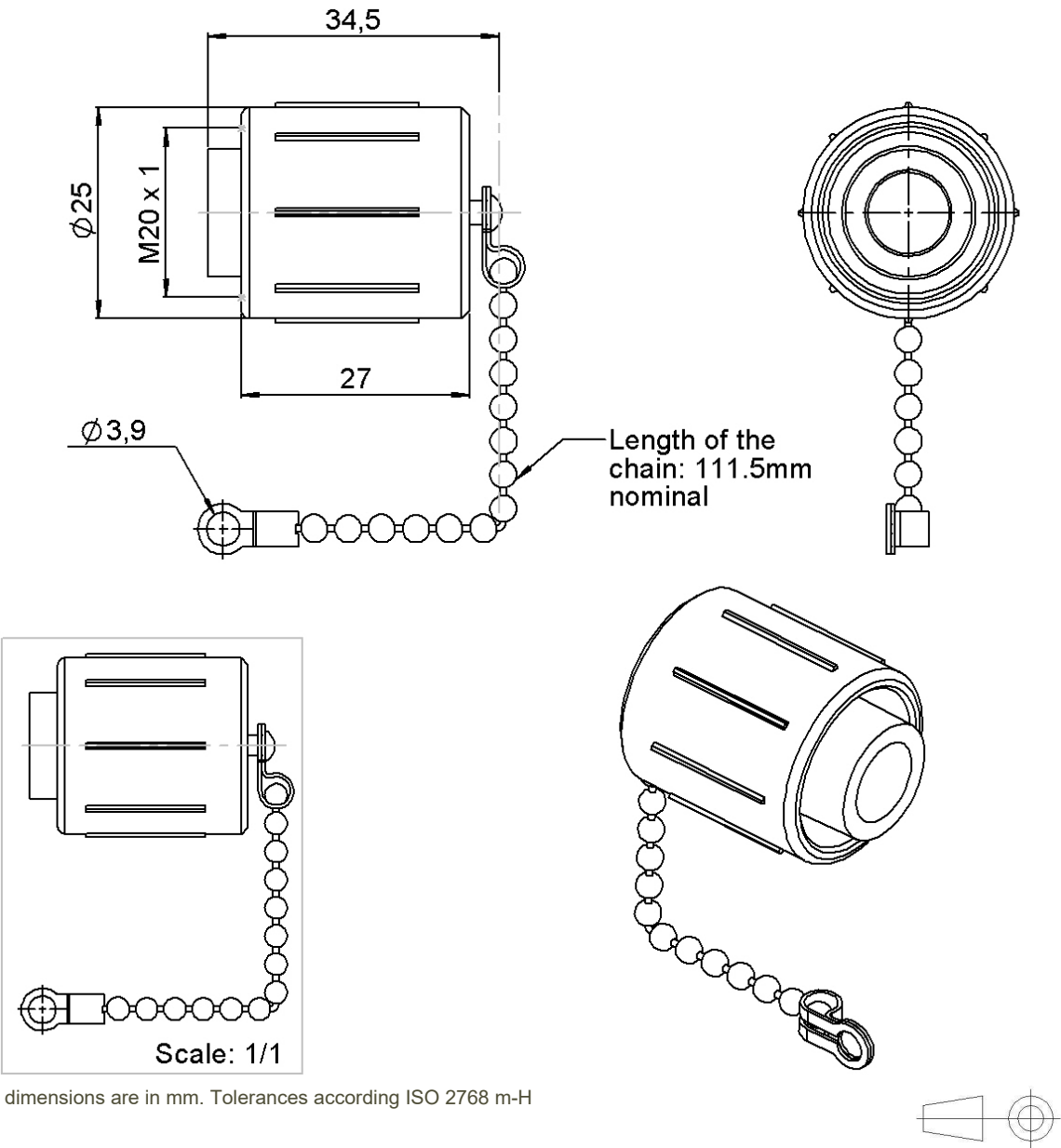

All dimensions are in mm. Tolerances according ISO 2768 m-H

COMPONENTS	MATERIALS	PLATING (µm)
Body	POLYSTYRENE LC88 420.47.089	
Center contact		
Outer contact		
Insulator		
Gasket		
Others parts	BRASS	NICKEL
-	-	-
-	-	-

PAGE 2/2

ISSUE
13-03-24K

SERIES **THT-20**

PART NUMBER **R331803000**

PACKAGING

Standard	Unit	Other
1	Contact us	Contact us

ELECTRICAL CHARACTERISTICS

Impedance	NA	Ω
Frequency	NA	GHz
VSWR	NA + 0,000	x F(GHz) Maxi
Insertion loss	NA	\sqrt{F} (GHz) dB Maxi
RF leakage	- (NA	- F(GHz)) dB Maxi
Voltage rating	NA	Veff Maxi
Dielectric withstanding voltage	NA	Veff mini
Insulation resistance	NA	M Ω mini

MECHANICAL CHARACTERISTICS

Center contact retention		
Axial force – Mating End	NA	N mini
Axial force – Opposite end	NA	N mini
Torque	NA	N.cm mini

Recommended torque		
Mating	50	N.cm
Panel nut	NA	N.cm

Mating life	500	Cycles mini
Nominal Weight (Add +15% for max weight)	10,960	g

ENVIRONMENTAL

Operating temperature	-35/+70	°C
Hermetic seal	NA	Atm.cm3/s
Panel leakage	NA	

SPECIFICATION

OTHER CHARACTERISTICS

Assembly instruction:

Others: