

PAGE 1/4

ISSUE  
15-09-21B

SERIES SMPM-L

PART NUMBER R201L00010

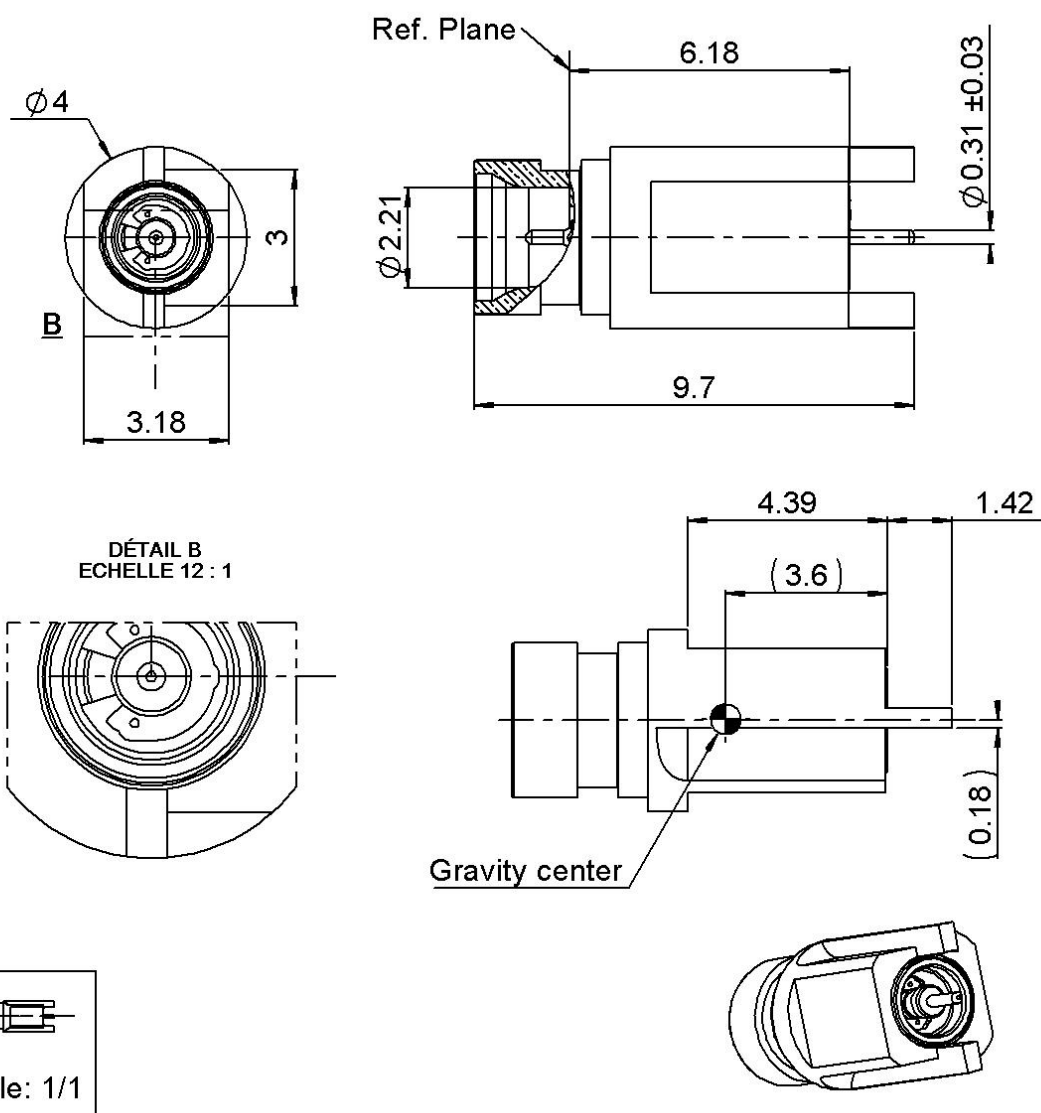

All dimensions are in mm. Tolerances according ISO 2768 m-H

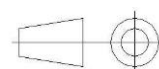

COMPONENTS	MATERIALS	PLATING (µm)
Body	<b>BERYLLIUM COPPER; BRASS</b>	<b>N2PGR</b>
Center contact	<b>BERYLLIUM COPPER</b>	<b>N2PGR</b>
Outer contact		
Insulator	<b>PEEK</b>	
Gasket		
Others parts		
-	-	-
-	-	-

PAGE 2/4

ISSUE  
**15-09-21B**

SERIES **SMPM-L**

PART NUMBER **R201L00010**

### PACKAGING

Standard	Unit	Other
<b>500</b>	<b>Contact us</b>	<b>Contact us</b>

### ELECTRICAL CHARACTERISTICS

Impedance	<b>50</b>	$\Omega$
Frequency	<b>0-65</b>	GHz
VSWR	<b>* 0,00</b>	x F(GHz) Maxi
Insertion loss	<b>*.012</b>	$\sqrt{F}$ (GHz) dB Maxi
RF leakage	<b>NA</b>	- F(GHz) dB Maxi
Voltage rating	<b>125</b>	Veff Maxi
Dielectric withstanding voltage	<b>250</b>	Veff mini
Insulation resistance	<b>5000</b>	M $\Omega$ mini

### MECHANICAL CHARACTERISTICS

Center contact retention		
Axial force – Mating End	<b>6.7</b>	N mini
Axial force – Opposite end	<b>6.7</b>	N mini
Torque	<b>NA</b>	N.cm mini

Recommended torque		
Mating	<b>NA</b>	N.cm
Panel nut	<b>NA</b>	N.cm

Mating life	<b>500</b>	Cycles mini
Nominal Weight (Add +15% for max weight)	<b>0,51</b>	g

### RECOMMENDED SOLDERING PARAMETERS

Solder paste deposit: Sn (96.5) - Ag (3.0) - Cu (0.5)  
 Granulometry from 25 to 36 micrometer  
 Deposit thickness: 100 micrometer  
 Flux: low residue  
 Soldering T°C according to IEC 61760-1  
 and max 10s at max 260°C

### ENVIRONMENTAL

Operating temperature	<b>-65/+165</b>	°C
Hermetic seal	<b>NA</b>	Atm.cm3/s
Panel leakage		

### SPECIFICATION

### OTHER CHARACTERISTICS

Assembly instruction:

Others:

**\* 1.15 (DC-26.5 GHz) 1.35 (26.5-40 GHz)**

**\* Coaxial transmission line only**

**\* RF performances highly depend on PCB adaptation**

PAGE 3/4

ISSUE  
15-09-21B

SERIES **SMPM-L**

PART NUMBER **R201L00010**

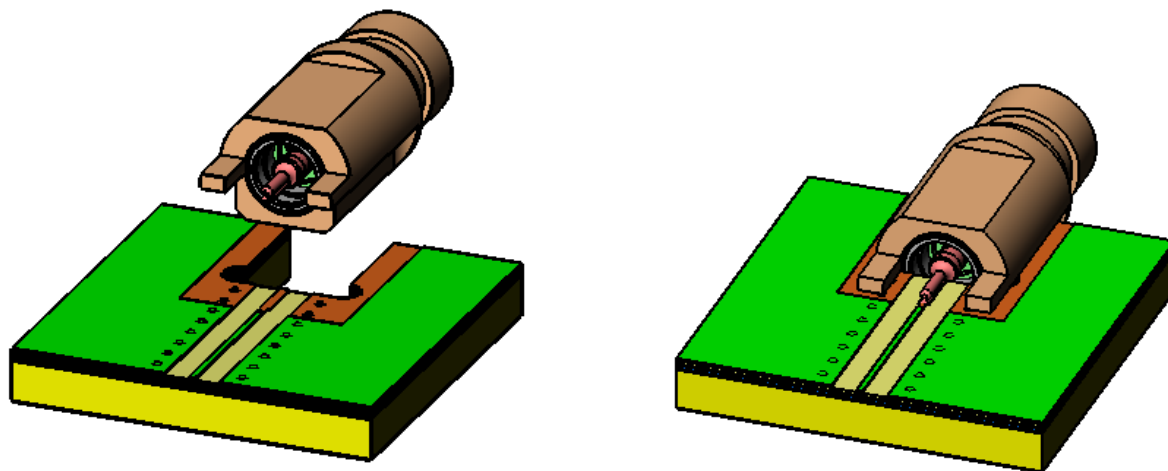

### PCB (nominal dimensions)

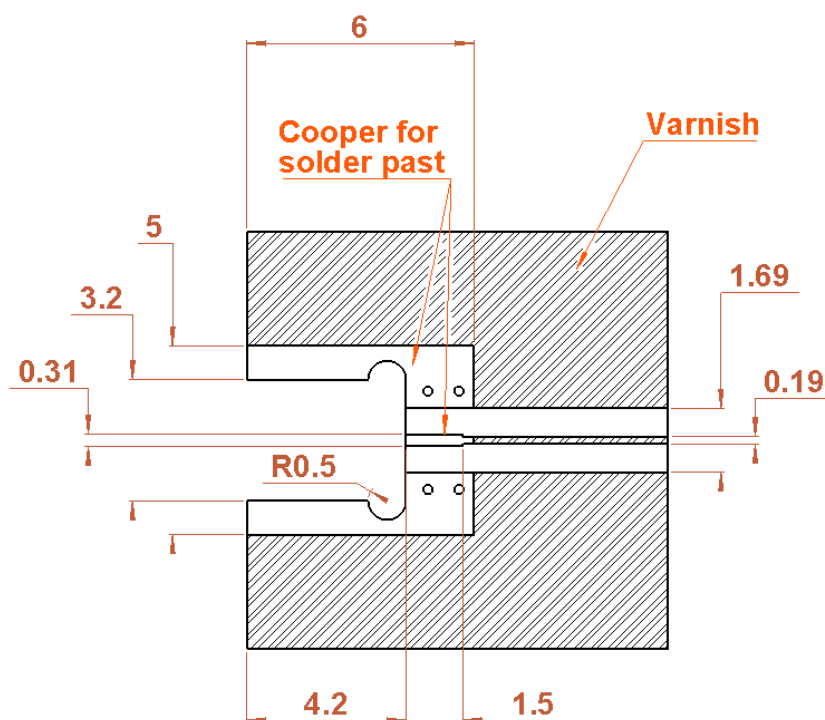

PAGE 4/4

ISSUE  
15-09-21B

SERIES SMPM-L

PART NUMBER R201L00010

## PACKAGING

