

PAGE 1/2

ISSUE 04-07-24A

SERIES SMPM

PART NUMBER R201561721

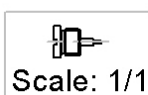
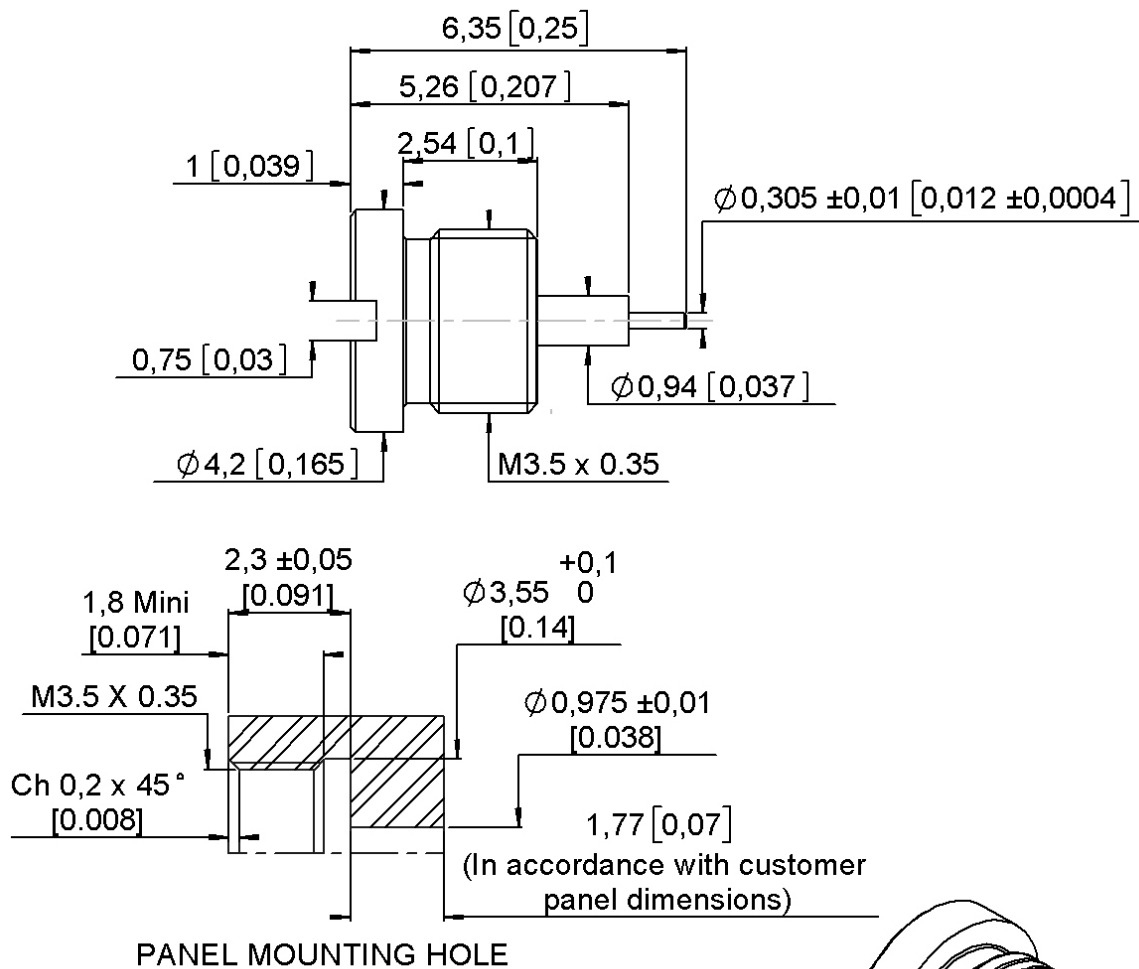

All dimensions are in mm. Tolerances according ISO 2768 m-H

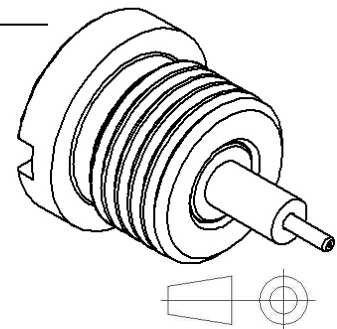

| COMPONENTS | MATERIALS | PLATING (μm) |
|----------------|------------------|----------------------------|
| Body | STAINLESS STEEL | PASSIVATED. |
| Center contact | BERYLLIUM COPPER | GOLD 1.27 OVER NICKEL 1.27 |
| Outer contact | | |
| Insulator | PTFE | |
| Gasket | | |
| Others parts | | |
| - | - | - |
| - | - | - |

PAGE 2/2

ISSUE **04-07-24A**

SERIES **SMPM**

PART NUMBER **R201561721**

PACKAGING

| Standard | Unit | Other |
|------------|-------------------|-------------------|
| 100 | Contact us | Contact us |

ELECTRICAL CHARACTERISTICS

| | | | |
|---------------------------------|--------------|--------------|----------------------------|
| Impedance | | 50 | Ω |
| Frequency | | 0-65 | GHz |
| VSWR | *1.05 | + | 0,010 x F(GHz) Maxi |
| Insertion loss | | *0.12 | √F(GHz) dB Maxi |
| RF leakage | - (| NA | - F(GHz) dB Maxi |
| Voltage rating | | 335 | Veff Maxi |
| Dielectric withstanding voltage | | 500 | Veff mini |
| Insulation resistance | | 5000 | MΩ mini |

MECHANICAL CHARACTERISTICS

| | | | |
|----------------------------|--|-----------|-----------|
| Center contact retention | | | |
| Axial force – Mating End | | 4 | N mini |
| Axial force – Opposite end | | 4 | N mini |
| Torque | | NA | N.cm mini |

| | | | |
|--------------------|--|-----------|------|
| Recommended torque | | | |
| Mating | | NA | N.cm |
| Panel nut | | 25 | N.cm |

| | | | |
|---------------------------|--|--------------|-------------|
| Mating life | | 500 | Cycles mini |
| Nominal Weight | | 0,170 | g |
| (Add +15% for max weight) | | | |

ENVIRONMENTAL

| | | |
|-----------------------|-----------------|-----------|
| Operating temperature | -65/+165 | °C |
| Hermetic seal | NA | Atm.cm3/s |
| Panel leakage | NA | |

SPECIFICATION

OTHER CHARACTERISTICS

Assembly instruction:**NA**

Others:

***Coaxial transmission line only**

***DC-12GHz**