

**SMP-MAX FEMALE SLIDE TYPE - SMP FEMALE**  
**STRAIGHT ADAPTER**

**R191.996.100**

Série : ADAPTER

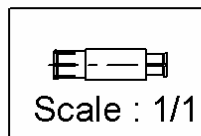
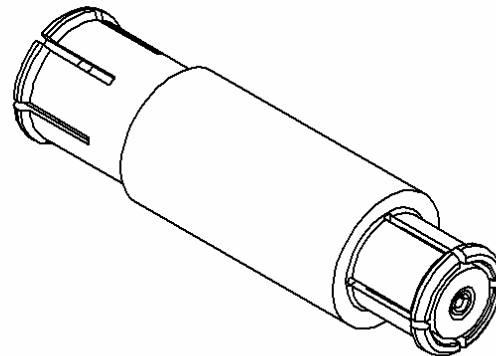
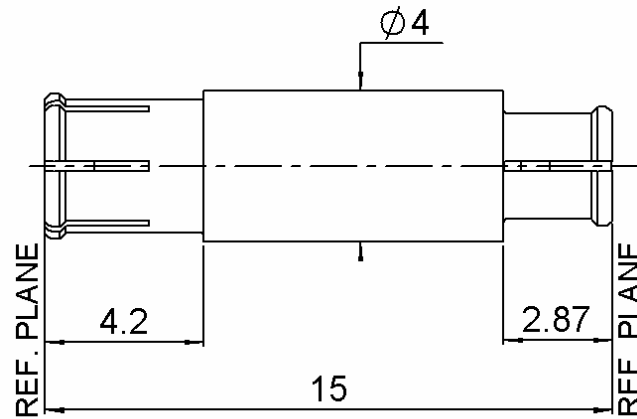

All dimensions are in mm.

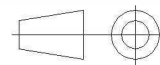

COMPONENTS	MATERIALS	PLATING (µm)
BODY	BERYLLIUM COPPER	NPGR
CENTER CONTACT	BERYLLIUM COPPER	NPGR
OUTER CONTACT		
INSULATOR	PTFE	
GASKET		
OTHERS PARTS		
-	-	-
-	-	-

Issue : 1139 A

In the effort to improve our products, we reserve the rights to make changes judged to be necessary.

**RADIAL** 

**SMP-MAX FEMALE SLIDE TYPE - SMP FEMALE****R191.996.100****STRAIGHT ADAPTER**Série : **ADAPTER****PACKAGING**

Standard	Unit	Other
<b>100</b>	<b>'W' option</b>	<b>Contact us</b>

**SPECIFICATION****ELECTRICAL CHARACTERISTICS**

Impedance	<b>50</b>	$\Omega$
Frequency	<b>0-6</b>	GHz
VSWR	<b>1.25* + 0,0000</b>	x F(GHz) Maxi
Insertion loss	<b>0.15*</b>	$\sqrt{F}(\text{GHz})$ dB Maxi
RF leakage	- ( <b>NA</b> )	- F(GHz)) dB Maxi
Voltage rating	<b>335</b>	Veff Maxi
Dielectric withstanding voltage	<b>500</b>	Veff mini
Insulation resistance	<b>5000</b>	M $\Omega$ mini

**ENVIRONMENTAL**

Operating	<b>-55/+125</b>	$^{\circ}\text{C}$
Hermetic seal	<b>NA</b>	Atm.cm3/s
Panel leakage	<b>NA</b>	

**MECHANICAL CHARACTERISTICS**

Center contact retention	
Axial force – Mating end	<b>7</b> N mini
Axial force – Opposite end	<b>7</b> N mini
Torque	<b>NA</b> N.cm mini

Recommended torque		
Mating	<b>SMP-MAX</b>	<b>0</b> N.cm
	<b>SMP-COM</b>	<b>0</b> N.cm
		<b>0</b> N.cm
Panel nut		<b>NA</b> N.cm

Mating life	<b>100</b>	Cycles mini
Weight	<b>0,8370</b>	g

**OTHER CHARACTERISTICS**

\*VSWR: up to 3GHz; 3-6GHz, 1.35max  
 \*Coaxial Transmission Line Only  
 \*Slide type receptacle+Bullet+Snap type receptacle  
 Typical VSWR(Board to Board connection):  
 0-3GHz, 1.2max  
 Power handling (typical) : >120W@3GHz at 25°C  
 Radial working angle: 3°min  
 Axial working range : 2mm

Issue : **1139 A**

In the effort to improve our products, we reserve the rights to make changes judged to be necessary.

**RADIAL** 

## SMP-MAX FEMALE SLIDE TYPE - SMP FEMALE

## STRAIGHT ADAPTER

**R191.996.100**

Série : ADAPTER

## SMP-MAX connecting range

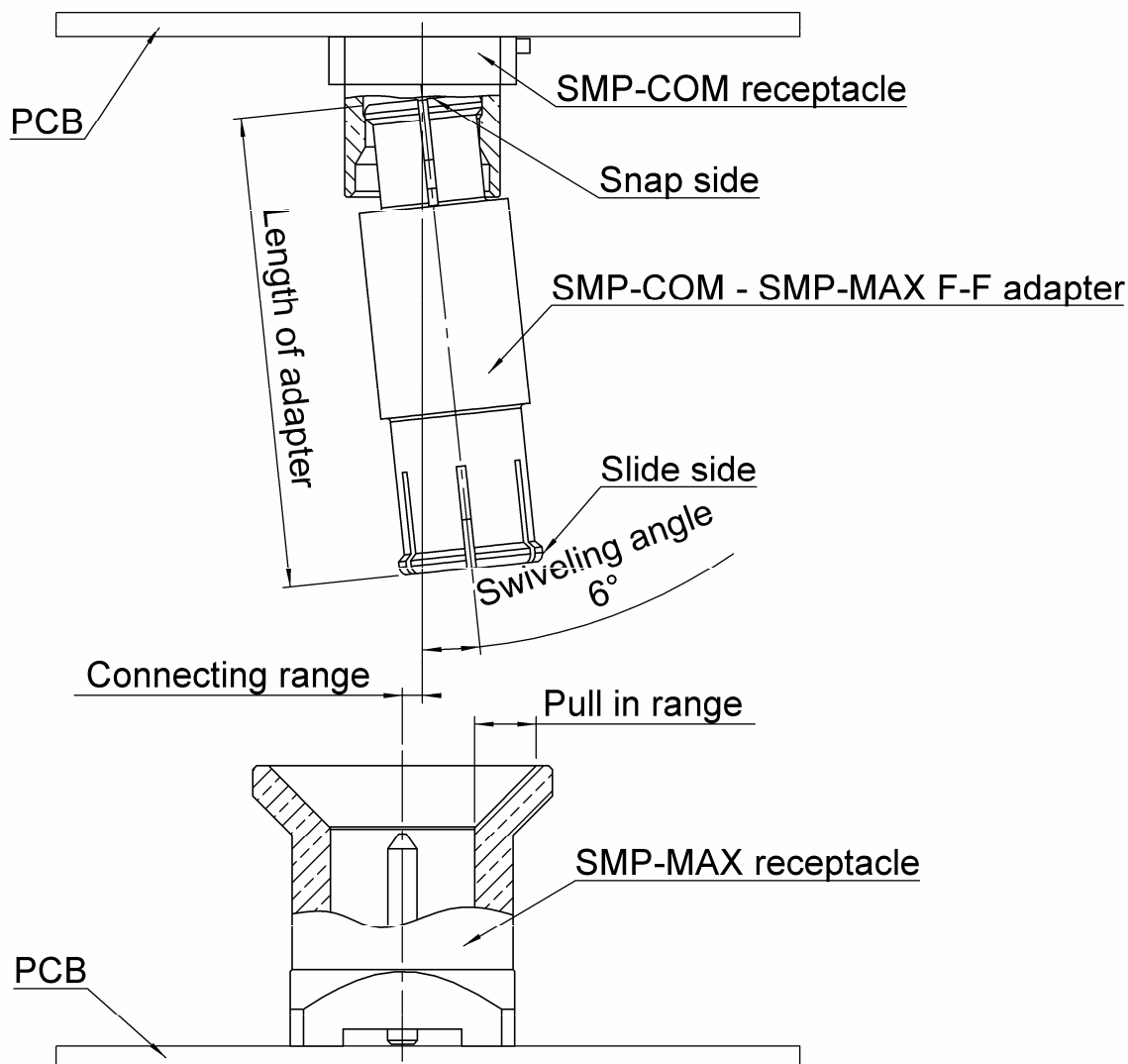

The connecting range represents the maximum misalignment during connection.

The swiveling angle is the maximum possible angle of the adapter in a snap receptacle.

A blind assembly is guaranteed if radial misalignment is smaller than connecting range. Otherwise a manual lead-in is necessary.

Issue : 1139 A

In the effort to improve our products, we reserve the rights to make changes judged to be necessary.

**RADIAL** 

SMP-MAX FEMALE SLIDE TYPE - SMP FEMALE

STRAIGHT ADAPTER

**R191.996.100**

Série : ADAPTER

## SMP-MAX radial and axial working range

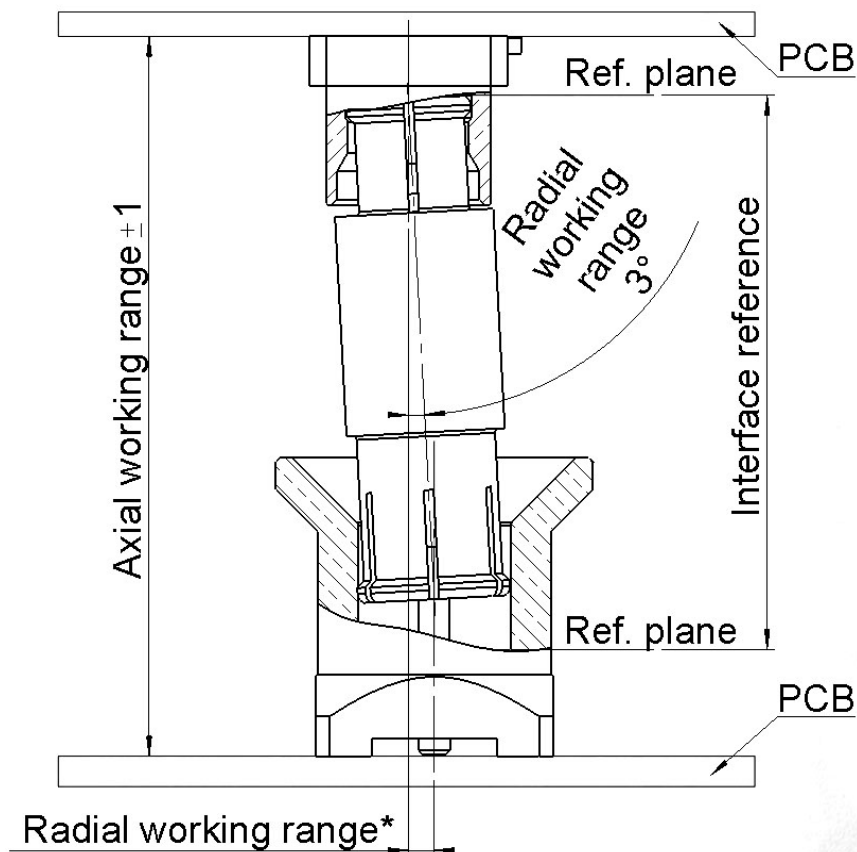

Electrical performance is achieved when radial and axial misalignments are within their working ranges.

\* Radial working range = (length of the adapter) \* Sin(radial working angle).

Issue : 1139 A

In the effort to improve our products, we reserve the rights to make changes judged to be necessary.

**RADIAL** 