

ADAPTOR QRE 3.5 MALE

FEMALE SMA 3.5

R191.944.700

Série : ADAPT-MES

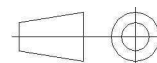
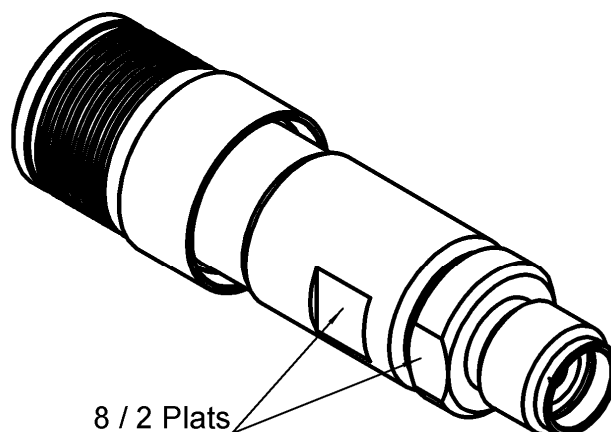
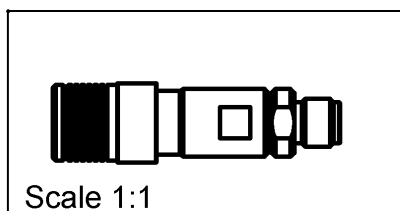
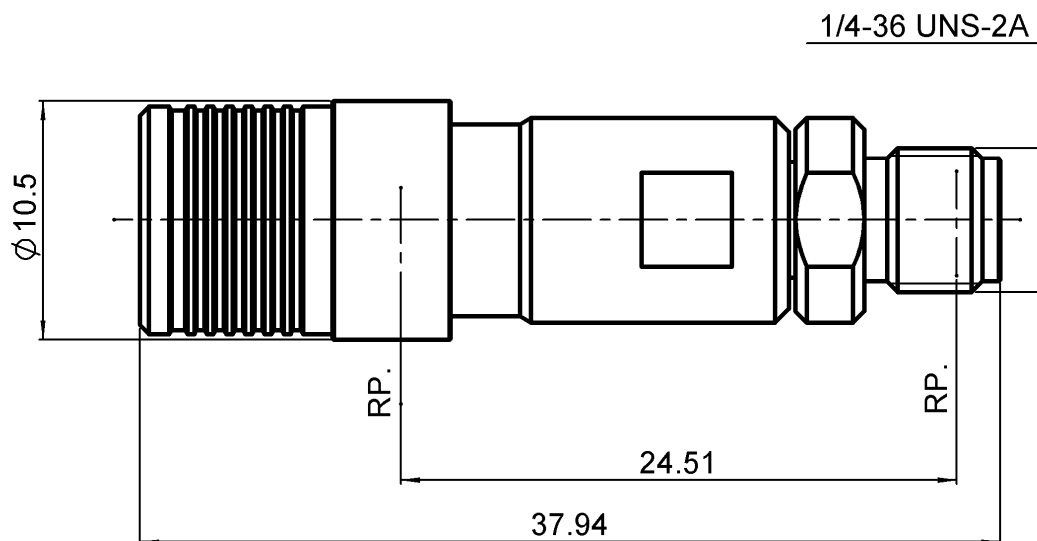

All dimensions are in mm.

COMPONENTS	MATERIALS	PLATING (µm)
BODY	STAINLESS STEEL 316L + 303L	PASSIVATED
CENTER CONTACT	BERYLLIUM COPPER	GOLD 1.3 OVER NICKEL2
OUTER CONTACT	BERYLLIUM COPPER	NPGR
INSULATOR	Q200-5	
GASKET	FLUORO SILICON RUBBER	
OTHERS PARTS	STAINLESS STEEL (316L)	PASSIVATED
.	.	.

Issue : 0940 A

In the effort to improve our products, we reserve the rights to make changes judged to be necessary.

RADIAL 

ADAPTOR QRE 3.5 MALE**FEMALE SMA 3.5****R191.944.700**

Série : ADAPT-MES

PACKAGING

Standard	Unit	Other
1	-	Contact us

SPECIFICATION**ELECTRICAL CHARACTERISTICS**

Impedance	50	Ω
Frequency	0-12.4	GHz
VSWR	1.07 + 0,0060	x F(GHz) Maxi
Insertion loss	0.07	$\sqrt{F}(\text{GHz})$ dB Maxi
RF leakage	- (* - F(GHz)) dB Maxi
Voltage rating	500	Veff Maxi
Dielectric withstanding voltage	1000	Veff mini
Insulation resistance	5000	M Ω mini

ENVIRONMENTAL

Operating	-40/+80	$^{\circ}\text{C}$
Hermetic seal	NA	Atm.cm3/s
Panel leakage	NA	

MECHANICAL CHARACTERISTICS

Center contact retention		
Axial force – Mating end	27	N mini
Axial force – Opposite end	27	N mini
Torque	NA	N.cm mini

Recommended torque

Mating	QRE 3.5	NA	N.cm
	SMA3.5	0	N.cm
		0	N.cm
Panel nut			N.cm

Mating life	100	Cycles mini
Weight	13,1290	g

OTHER CHARACTERISTICS

*RF leakage: 95 @ 3GHz / 80 @ 12.4 GHz

Issue : 0940 A

In the effort to improve our products, we reserve the rights to make changes judged to be necessary.

