

QN MALE - 7/16 MALE ADAPTER

R191.925.000

Série : ADAPT

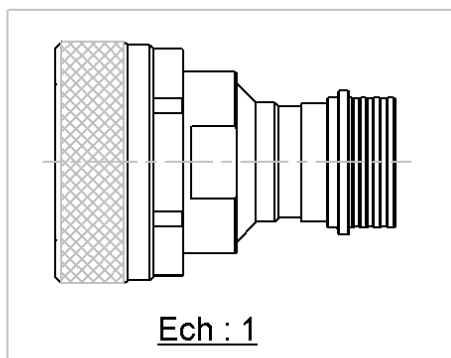
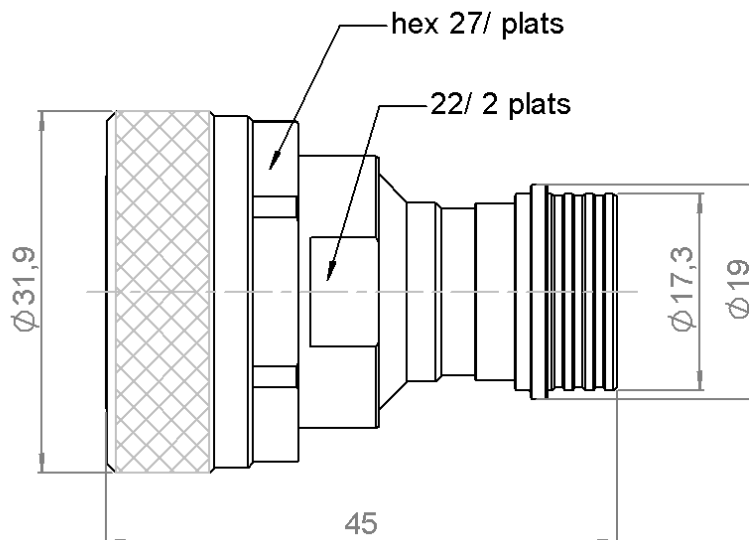

Ech : 1

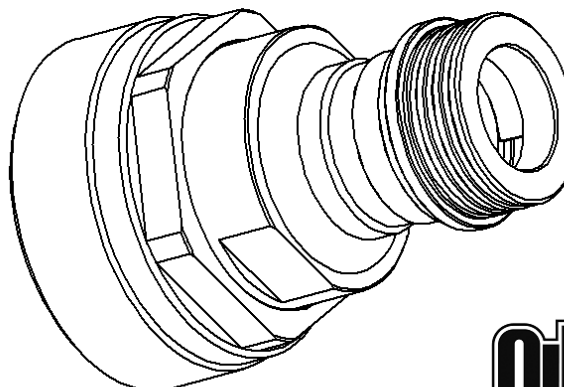

QF®

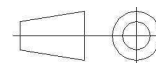

All dimensions are in mm.

COMPONENTS	MATERIALS	PLATING (μm)
BODY	BRASS	BBR 0.5 OVER SILVER 3
CENTER CONTACT	BRASS	SILVER 5 PASSIVATED OVER COPPER 0.5
OUTER CONTACT	BERYLLIUM COPPER	NPGR
INSULATOR	PTFE	
GASKET	EPDM	
OTHERS PARTS	BRASS	BBR 2
.	.	.
.	.	.

Issue : 1309 D

In the effort to improve our products, we reserve the rights to make changes judged to be necessary.

This document contains proprietary information and such information shall not be disclosed to any third party for any purpose whatsoever or used for manufacturing purposes without prior written agreement from RADIALL

Radiall 

QN MALE - 7/16 MALE ADAPTER**R191.925.000**

Série : ADAPT

PACKAGING

Standard	Unit	Other
1		Contact us

SPECIFICATION**ELECTRICAL CHARACTERISTICS**

Impedance	50	Ω
Frequency	0-6*	GHz
VSWR	1.05 + 0,0250	x F(GHz) Maxi
Insertion loss	0.048	$\sqrt{F}(\text{GHz})$ dB Maxi
RF leakage	- (**90)	- F(GHz)) dB Maxi
Voltage rating	1400	Veff Maxi
Dielectric withstanding voltage	2500	Veff mini
Insulation resistance	5000	M Ω mini

ENVIRONMENTAL

Operating	-55/+125	$^{\circ}\text{C}$
Hermetic seal	NA	Atm.cm3/s
Panel leakage	NA	

MECHANICAL CHARACTERISTICS

Center contact retention		
Axial force – Mating end	68	N mini
Axial force – Opposite end	68	N mini
Torque	NA	N.cm mini

Recommended torque

Mating	7-16	3000	N.cm
	QN	0	N.cm
		0	N.cm
Panel nut			N.cm

Mating life	100	Cycles mini
Weight	95,6950	g

OTHER CHARACTERISTICS

* Usable 7.5GHz

**RF Leakage : -80dB min 3<F<6GHz

***PIM3: -112dBm (2 x 20W at 1.8GHz)

Issue : 1309 D

In the effort to improve our products, we reserve the rights to make changes judged to be necessary.

This document contains proprietary information and such information shall not be disclosed to any third party for any purpose whatsoever or used for manufacturing purposes without prior written agreement from RADIALL

