

PAGE 1/3	ISSUE 1419B	SERIES ADAPT	PART NUMBER R191553800
----------	-------------	--------------	------------------------

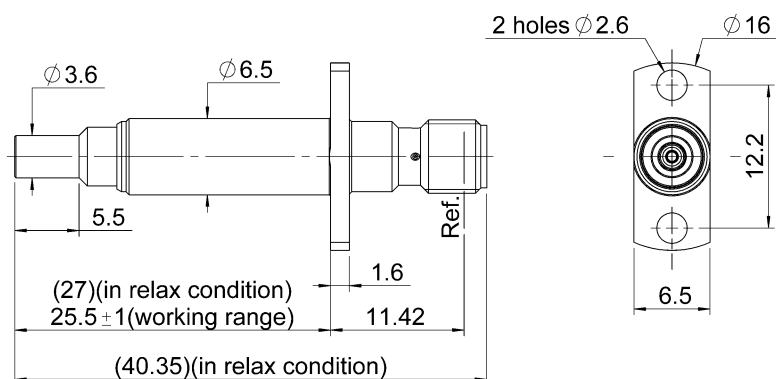

### PANEL CUT OUT

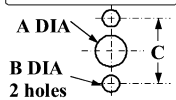

	mm	
	Maxi	mini
A	6.8	6.75
B	2.7	2.6
C	12.25	12.15

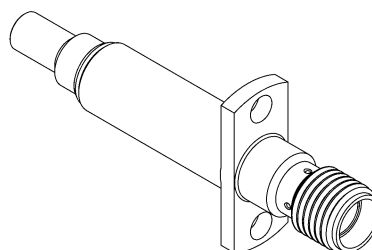
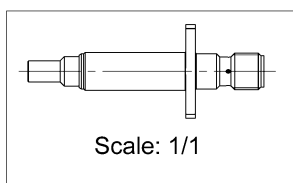

All dimensions are in mm.

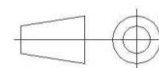

COMPONENTS	MATERIALS	PLATING (μm)
Body	<b>BRASS</b>	<b>GOLD OVER NICKEL, NPGR</b>
Center contact	<b>BERYLLIUM COPPER, BRASS</b>	<b>GOLD OVER NICKEL, NPGR</b>
Outer contact		
Insulator	<b>PTFE</b>	
Gasket		
Others parts	<b>STAINLESS STEEL</b>	
-	-	-
-	-	-

PAGE <b>2/3</b>	ISSUE <b>1419B</b>	SERIES <b>ADAPT</b>	PART NUMBER <b>R191553800</b>
-----------------	--------------------	---------------------	-------------------------------

### PACKAGING

Standard	Unit	Other
<b>10</b>	<b>Contact us</b>	<b>Contact us</b>

### ELECTRICAL CHARACTERISTICS

Impedance		<b>50</b>	$\Omega$
Frequency		<b>0-6</b>	GHz
VSWR	<b>1.25*</b>	<b>+</b>	<b>0.000</b> x F(GHz) Maxi
Insertion loss			<b>0.15*</b> $\sqrt{F}$ (GHz) dB Maxi
RF leakage		<b>- (</b>	<b>NA</b> - F(GHz)) dB Maxi
Voltage rating			<b>NA</b> Veff Maxi
Dielectric withstanding voltage			<b>NA</b> Veff mini
Insulation resistance			<b>5000</b> M $\Omega$ mini

### MECHANICAL CHARACTERISTICS

Center contact retention			
Axial force – Mating End		<b>NA**</b>	N mini
Axial force – Opposite end		<b>NA</b>	N mini
Torque		<b>NA</b>	N.cm mini
Recommended torque			
Mating		<b>0</b>	N.cm
		<b>0</b>	N.cm
		<b>0</b>	N.cm
Panel nut			N.cm
Mating life		<b>100000</b>	Cycles mini
Weight		<b>6.630</b>	g

### ENVIRONMENTAL

Operating	<b>-40/+80</b>	°C
Hermetic seal	<b>NA</b>	Atm.cm3/s
Panel leakage	<b>NA</b>	

### SPECIFICATION

### OTHER CHARACTERISTICS

**\*VSWR: up to 3GHz; 3-6 GHz, 1.35maxi**

**\*Coaxial Transmission Line Only**

**\*\*Action mating force for the spring : 6N max**

PAGE <b>3/3</b>	ISSUE <b>1419B</b>	SERIES <b>ADAPT</b>	PART NUMBER <b>R191553800</b>
-----------------	--------------------	---------------------	-------------------------------

**INSTRUCTION FOR USE**

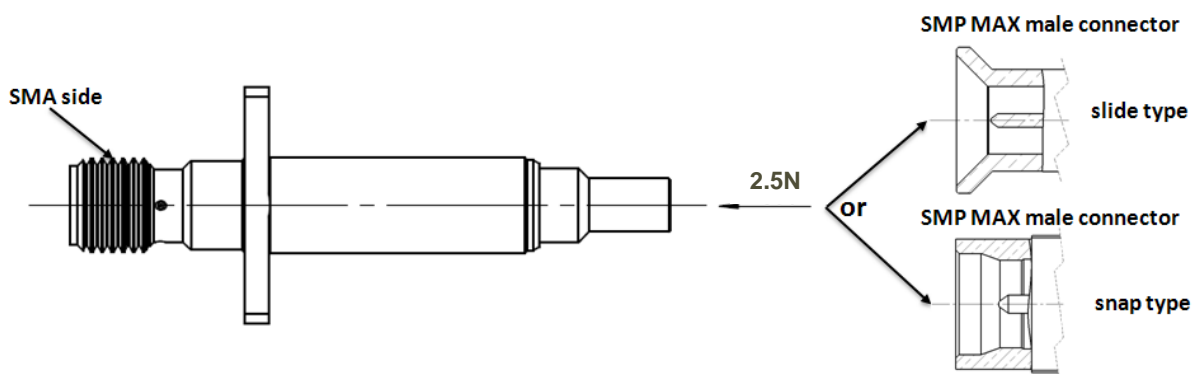

1. Connect the SMA side of the adapter with the measurement test equipment.
2. Mate the SMP-MAX connector with the adapter by pushing the SMP-MAX connector with a minimum force of 2.5N.