

PAGE 1/2	ISSUE 15-09-23A	SERIES TNC	PART NUMBER R143720000
----------	--------------------	-------------------	-------------------------------

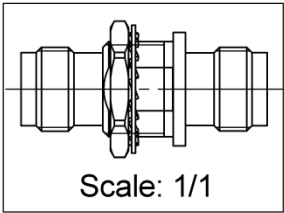

Scale: 1/1

PANEL CUT OUT

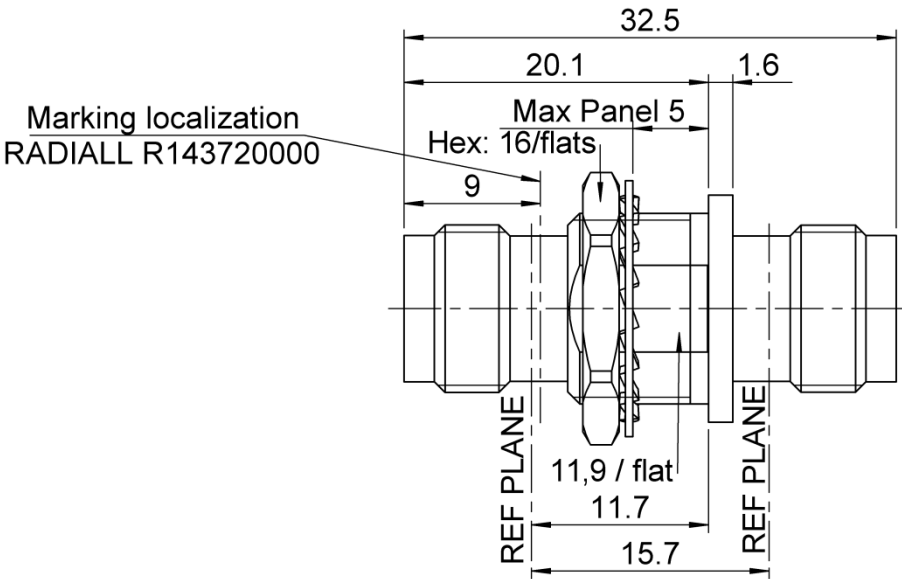
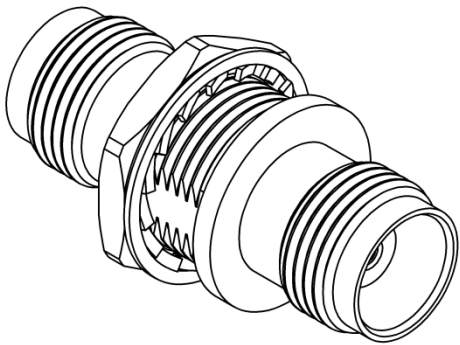
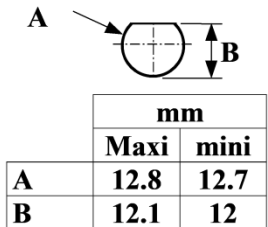

All dimensions are in mm. Tolerances according ISO 2768 m-H

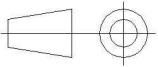

COMPONENTS	MATERIALS	PLATING (µm)
Body	BRASS	NICKEL
Center contact	BERYLLIUM COPPER	GOLD OVER NICKEL
Outer contact	-	-
Insulator	PTFE	-
Gasket	-	-
Others parts	BRASS	NICKEL
-	-	-
-	-	-

PAGE 2/2

ISSUE
15-09-23A

SERIES **TNC**

PART NUMBER **R143720000**

PACKAGING

Standard	Unit	Other
1	Contact us	Contact us

ELECTRICAL CHARACTERISTICS

Impedance	50	Ω
Frequency	0-11	GHz
VSWR	1.44 +	0 x F(GHz) Maxi
Insertion loss	0.06	\sqrt{F} (GHz) dB Maxi
RF leakage	- (57 - F(GHz)) dB Maxi
Voltage rating	500	Veff Maxi
Dielectric withstanding voltage	1500	Veff mini
Insulation resistance	5000	M Ω mini

MECHANICAL CHARACTERISTICS

Center contact retention		
Axial force – Mating End	18	N mini
Axial force – Opposite end	18	N mini
Torque	2.8	N.cm mini

Recommended torque		
Mating	NA	N.cm
Panel nut	370	N.cm

Mating life	500	Cycles mini
Nominal Weight (Add +15% for max weight)	17.08	g

ENVIRONMENTAL

Operating temperature	-65/+165	°C
Hermetic seal	NA	Atm.cm3/s
Panel leakage	NA	

SPECIFICATION

OTHER CHARACTERISTICS

Assembly instruction:**NA**

Others:

-