

PAGE 1/2

ISSUE 27-09-19B

SERIES SMA2.9

PART NUMBER R127017111

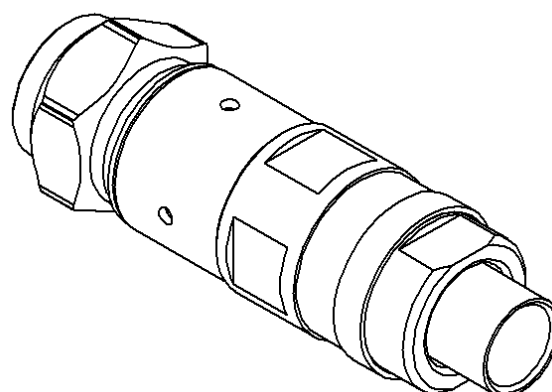
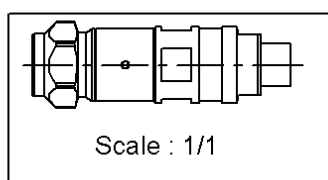
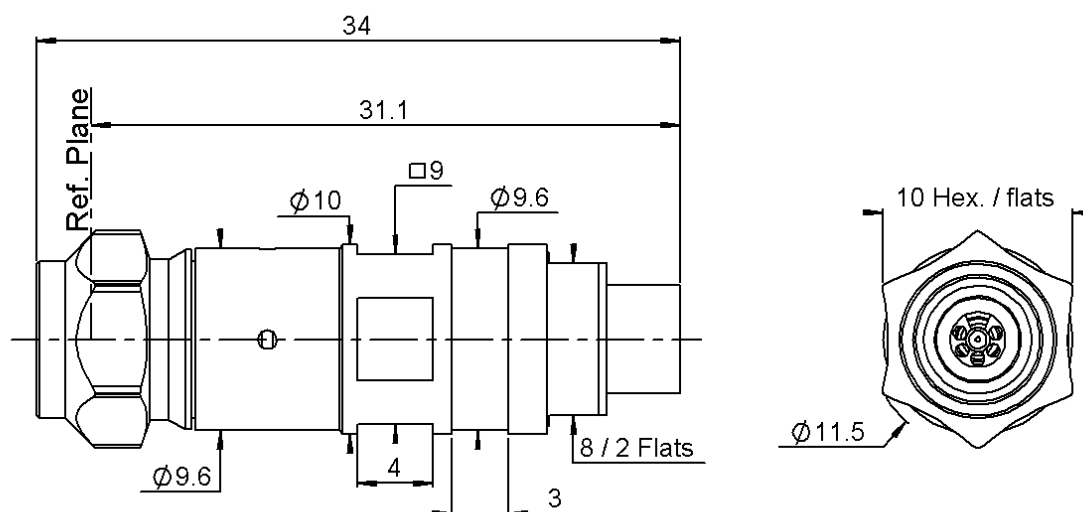

All dimensions are in mm.

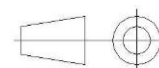

COMPONENTS	MATERIALS	PLATING (μm)
Body	STAINLESS STEEL (316L)	PASSIVATED
Center contact	BERYLLIUM COPPER	GOLD OVER NICKEL
Outer contact	BRASS	GOLD OVER NICKEL
Insulator	PEEK	
Gasket	FLUORO SILICON RUBBER	
Others parts	BRASS	GOLD OVER NICKEL
-	-	-
-	-	-

PAGE **2/2**

ISSUE **27-09-19B**

SERIES **SMA2.9**

PART NUMBER **R127017111**

PACKAGING

Standard	Unit	Other
1		Contact us

ELECTRICAL CHARACTERISTICS

Impedance	50	Ω
Frequency	0-32	GHz
VSWR	1.2 + 0,0000	x F(GHz) Maxi
Insertion loss	0.1	\sqrt{F} (GHz) dB Maxi
RF leakage	- (90**	- F(GHz)) dB Maxi
Voltage rating	350	Veff Maxi
Dielectric withstanding voltage	750	Veff mini
Insulation resistance	5000	M Ω mini

MECHANICAL CHARACTERISTICS

Center contact retention		
Axial force – Mating End	27	N mini
Axial force – Opposite end	27	N mini
Torque	NA	N.cm mini
Recommended torque		
Mating	90	N.cm
Panel nut	NA	N.cm
Clamp nut	240	N.cm
A/F clamp nut	8,0000	mm
Mating life	500	Cycles mini
Weight	12,6600	g

ENVIRONMENTAL

Operating temperature	-65/+165	°C
Hermetic seal	NA	Atm.cm3/s
Panel leakage	IP67*	

SPECIFICATION

CABLE ASSEMBLY

Stripping	a	b	c	d	e	f
mm	0	0	0	0	0	0

Assembly instruction:

Recommended cable(s)

Characteristics indicated on this data sheet are those that can be achieved with the highest performance cable. Intrinsic limitations of the cable may diminish the performance of the assembly

Cable retention

- pull off	***	N mini
- torque	***	N.cm

TOOLING

Part Number	Description	Hexagon
.	.	.

OTHER CHARACTERISTICS

* Cabling with heatshrink sleeve

** Up to 18 GHz

*** See the TDS of the cable assembly