

TWO HOLES UNIVERSAL FLANGE RECEPTACLE

R127.843.111

Series : SMA 2.9

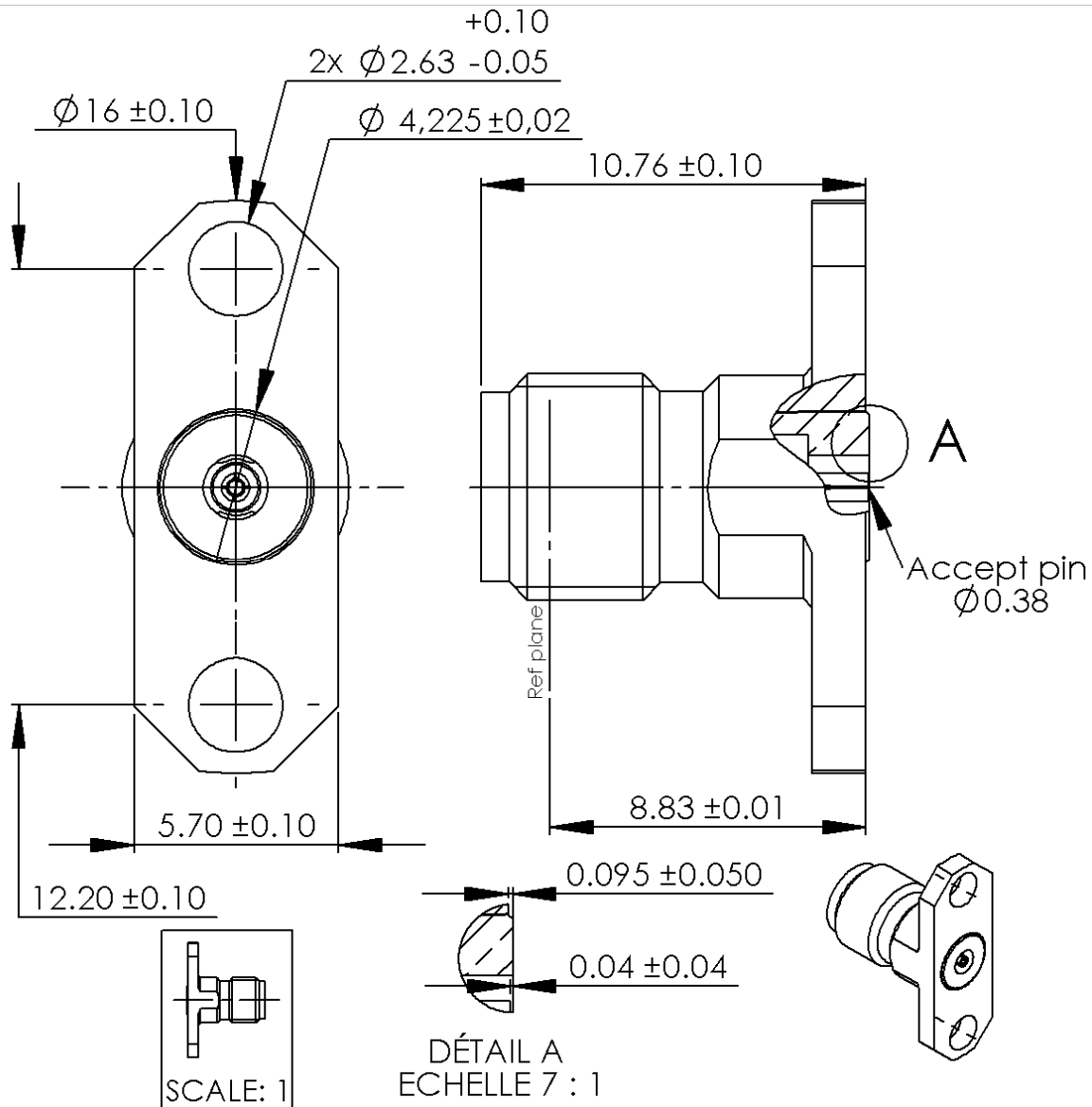

All dimensions are in mm.

COMPONENTS	MATERIALS	PLATING (μm)
BODY	STAINLESS STEEL	PASSIVATION
CENTER CONTACT	BERYLLIUM COPPER	GOLD 1.3 OVER NICKEL 2
OUTER CONTACT	BRASS	GOLD 1.3 OVER NICKEL 2
INSULATOR	ULTEM1000	
GASKET		
OTHERS PARTS		
-	-	-
-	-	-

Issue : 1140 A

In the effort to improve our products, we reserve the right to make changes judged to be necessary.

RADIAL 

TWO HOLES UNIVERSAL FLANGE RECEPTACLE**R127.843.111**

Series : SMA 2.9

PACKAGING

Standard	Unit	Other
	'W' option	Contact us

SPECIFICATION**ELECTRICAL CHARACTERISTICS**

Impedance	50	Ω
Frequency	0-40	GHz
VSWR	1.05 + 0,0050	x F(GHz) Maxi
Insertion loss	.03	$\sqrt{F}(\text{GHz})$ dB Maxi
RF leakage	- (90)	- F(GHz)) dB Maxi
Voltage rating	335	Veff Maxi
Dielectric withstanding voltage	750	Veff mini
Insulation resistance	5000	M Ω mini

ENVIRONMENTAL

Operating temperature	-65/+165	$^{\circ}\text{C}$
Hermetic seal	-	Atm.cm3/s
Panel leakage	-	

OTHER CHARACTERISTICS

Assembly instruction

Others :

MECHANICAL CHARACTERISTICS

Center contact retention		
Axial force – Mating end	27	N mini
Axial force – Opposite end	27	N mini
Torque	NA	N.cm mini
Recommended torque		
Mating	80-120	N.cm
Panel nut	-	N.cm
Mating life	500	Cycles mini
Weight	2,1800	g

Issue : 1140 A

In the effort to improve our products, we reserve the right to make changes judged to be necessary.

RADIAL 