

RIGHT ANGLE PLUG CRIMP OR SOLDER TYPE

R125.172.000

CABLE 2.6/50 S

Series : SMA

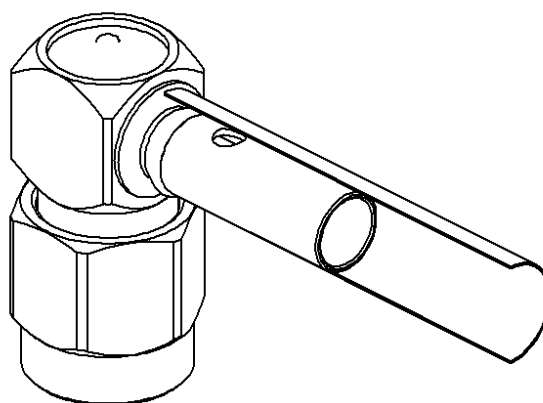
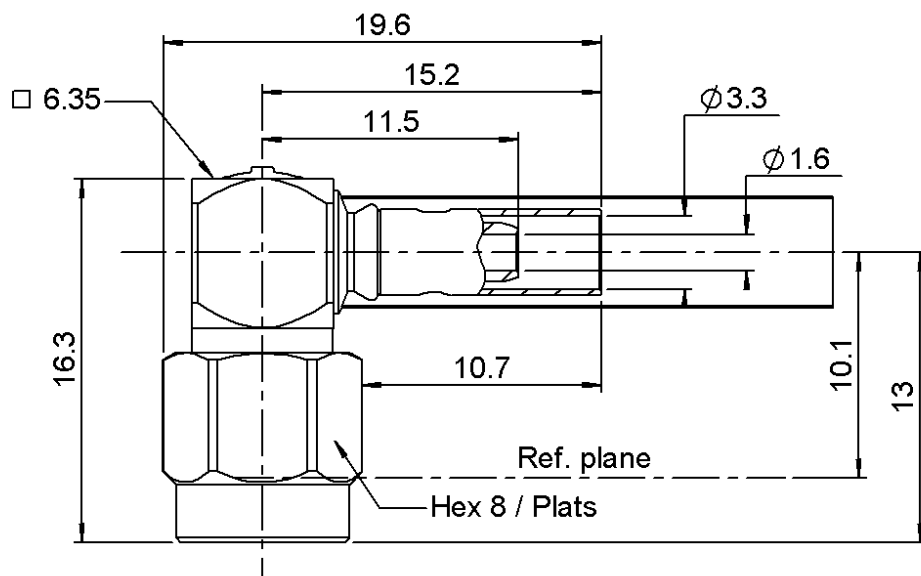

CECC 22111-810-01

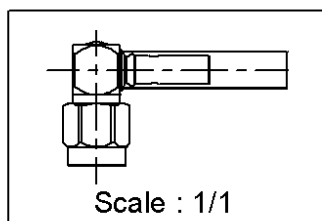

All dimensions are in mm.

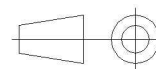

| COMPONENTS | MATERIALS | PLATINGS (µm) |
|----------------|-----------------|------------------------|
| BODY | STAINLESS STEEL | GOLD 0.5 OVER NICKEL 2 |
| CENTER CONTACT | BRASS | GOLD 1.3 OVER NICKEL 2 |
| OUTER CONTACT | - | - |
| INSULATOR | PTFE | - |
| GASKET | FLUORE SILICONE | - |
| OTHERS PARTS | STAINLESS STEEL | GOLD 0.5 OVER NICKEL 2 |
| - | - | - |
| - | - | - |

Issue : 0539 G

In the effort to improve our products, we reserve the right to make changes judged to be necessary.



RADIALL®

RIGHT ANGLE PLUG CRIMP OR SOLDER TYPE**R125.172.000****CABLE 2.6/50 S**Series : **SMA****PACKAGING**

| Standard | Unit | Other |
|------------|-------------------|-------------------|
| 100 | 'W' option | Contact us |

SPECIFICATION**ELECTRICAL CHARACTERISTICS**

| | | | |
|---------------------------------|---------------|---------------|--------------------------|
| Impedance | | 50 | Ω |
| Frequency | | 0-12.4 | GHz |
| VSWR | 1.15 + | 0.03 | x F(GHz) Maxi |
| Insertion loss | | 0.15 | \sqrt{F} (GHz) dB Maxi |
| RF leakage | - (| 60 | - F(GHz)) dB Maxi |
| Voltage rating | | 250 | Veff Maxi |
| Dielectric withstanding voltage | | 750 | Veff mini |
| Insulation resistance | | 5000 | M Ω mini |

CABLE ASSEMBLY

| Stripping | a | b | c | d | e | f |
|-----------|-----|---|------|---|----|---|
| mm | 2.8 | 7 | 12.8 | 0 | 10 | 0 |

Assembly instruction :

Crimp 05

Recommended cable(s)

KX 3B
RG 188
RG 316
KX 22A
RG 174 FTX
RG 174
ECO 316

Characteristics indicated on this data sheet are those that can be achieved with the highest performance cable. Intrinsic limitations of the cable may diminish the performance of the assembly

Cable retention

- pull off **90** N mini
- torque **NA** N.cm

MECHANICAL CHARACTERISTICS

Center contact retention

| | | |
|----------------------------|------------|-----------|
| Axial force – Mating end | 27 | N mini |
| Axial force – Opposite end | 27 | N mini |
| Torque | 2.8 | N.cm mini |

Recommended torque

| | | |
|---------------|------------|------|
| Mating | 100 | N.cm |
| Panel nut | NA | N.cm |
| Clamp nut | NA | N.cm |
| A/F clamp nut | 0 | mm |

Mating life

500 Cycles mini

Weight

4.3 g**TOOLING**

| Part Number | Description | Hexagon |
|--------------|---------------|---------|
| R282.211.000 | CRIMPING TOOL | 3.25 |
| R282.235.003 | CRIMPING DIES | 3.25 |
| R282.293.000 | CRIMPING TOOL | |

OTHERS CHARACTERISTICS

-

ENVIRONMENTAL

| | | |
|-----------------------|-----------------|-----------|
| Operating temperature | -65/+165 | ° C |
| Hermetic seal | NA | Atm.cm3/s |
| Panel leakage | NA | |

Issue : **0539 G**

In the effort to improve our products, we reserve the right to make changes judged to be necessary.

**RADIALL®**