

SCREW ON FEMALE RECEPTACLE
HERMETIC-WITH CYLINDRICAL CONTACT

R125.609.192

Series : SMA

Body
Stainless Steel
Passivated

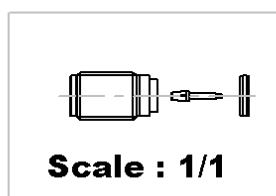
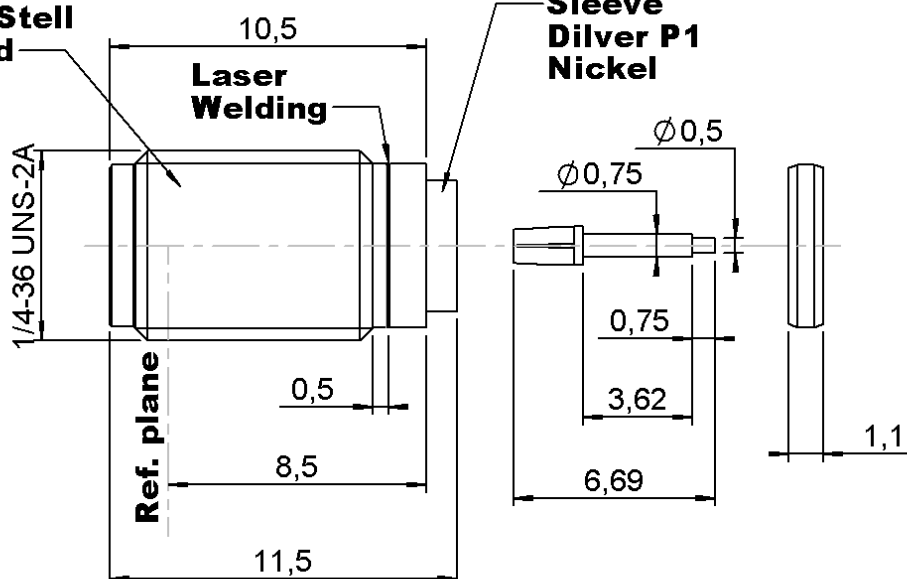

All dimensions are in mm.

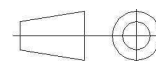

COMPONENTS	MATERIALS	PLATING (μm)
BODY	STAINLESS STEEL	PASSIVATION
CENTER CONTACT	BERYLLIUM COPPER	GOLD 1.3 OVER NICKEL2
OUTER CONTACT	-	-
INSULATOR	PTFE+GLASS BEAD	-
GASKET	A-G4MC	-
OTHERS PARTS	-	-
SLEEVE	DILVER P1	NICKEL2
GLASS BEAD AXIS	DILVER P1	GOLD 0.2 OVER NICKEL2

Issue : 1942 B

In the effort to improve our products, we reserve the right to make changes judged to be necessary.

RADIAL 

SCREW ON FEMALE RECEPTACLE
HERMETIC-WITH CYLINDRICAL CONTACT

R125.609.192

Series : SMA

PACKAGING

Standard	Unit	Other
100	'W' option	Contact us

SPECIFICATION**ELECTRICAL CHARACTERISTICS**

Impedance	50	Ω
Frequency	0-26.5	GHz
VSWR	1.1 + 0,0100	x F(GHz) Maxi
Insertion loss	0.3	$\sqrt{F}(\text{GHz})$ dB Maxi
RF leakage	90*	- F(GHz)) dB Maxi
Voltage rating	500	Veff Maxi
Dielectric withstanding voltage	1000	Veff mini
Insulation resistance	5000	M Ω mini

ENVIRONMENTAL

Operating temperature	-65/+165	$^{\circ}\text{C}$
Hermetic seal	10-8	Atm.cm ³ /s
Panel leakage	NA	

OTHER CHARACTERISTICS

Assembly instruction

Others :

*Coaxial transmission line only

MECHANICAL CHARACTERISTICS

Center contact retention	
Axial force – Mating end	27 N mini
Axial force – Opposite end	27 N mini
Torque	2.8 N.cm mini
Recommended torque	
Mating	NA N.cm
Panel nut	280 N.cm
Mating life	500 Cycles mini
Weight	1,6400 g

Issue : 1942 B

In the effort to improve our products, we reserve the right to make changes judged to be necessary.

RADIAL 

SCREW ON FEMALE RECEPTACLE
HERMETIC-WITH CYLINDRICAL CONTACT

R125.609.192

Series : SMA

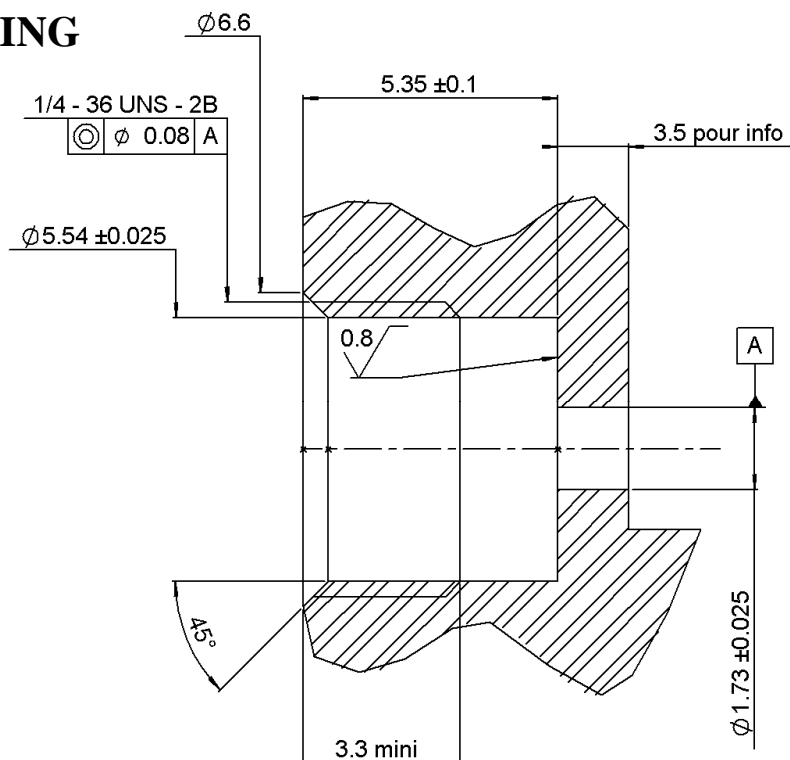
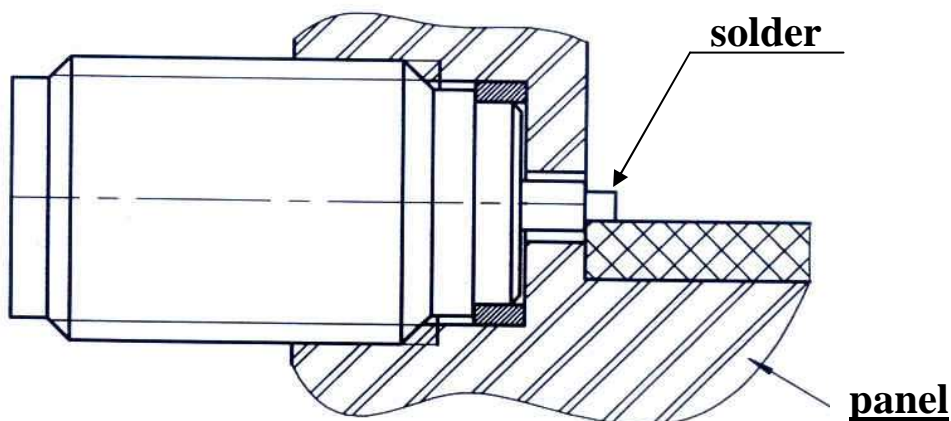
PANEL DRILLING**MOUNTING**

Mount metal gasket onto connector. Screw the whole into the housing. Tighten the connector up to 280Ncm+or-10Ncm(use special tooling set RADIALL R282.341.012)Thus the connexion hermeticity is guaranteed at 10-8cc/sec.

Then solder the pin on the track.

Beware there is not too much solder.

Issue : 1942 B

In the effort to improve our products, we reserve the right to make changes judged to be necessary.

RADIALL 