

PAGE 1/3

ISSUE 1942A

SERIES SMA

PART NUMBER R125609171

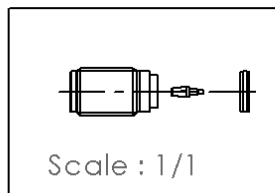
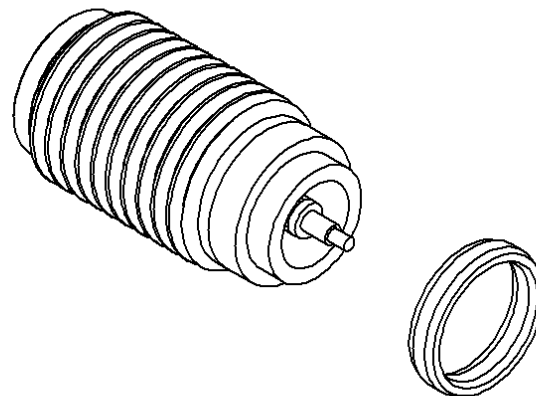
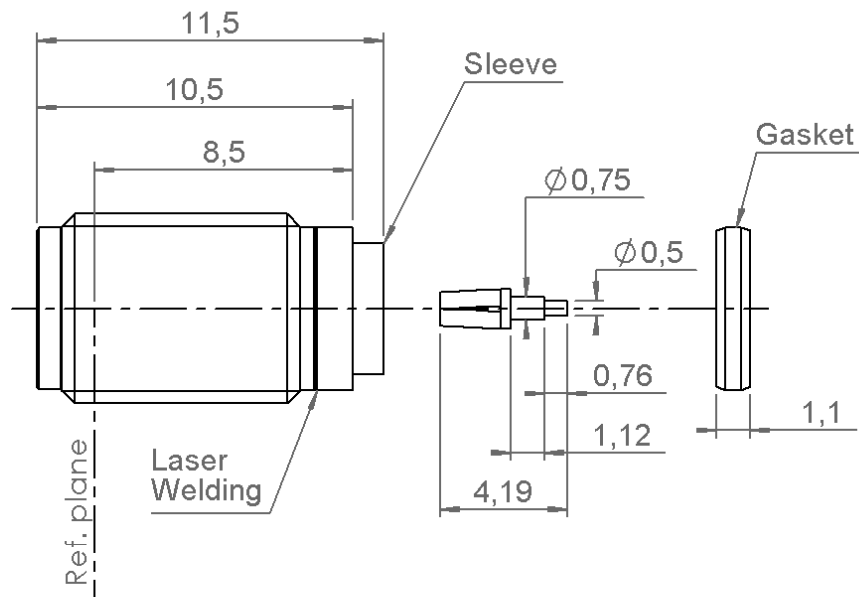

All dimensions are in mm.

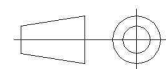

COMPONENTS	MATERIALS	PLATING (µm)
Body	<b>STAINLESS STEEL</b>	<b>PASSIVATED</b>
Center contact	<b>BERYLLIUM COPPER</b>	<b>GOLD 1.3 OVER NICKEL 2</b>
Outer contact	-	-
Insulator	<b>PTFE+GLASS BEAD</b>	-
Gasket	<b>A-G4MC</b>	-
Others parts	-	-
Sleeve	<b>DILVER P1</b>	<b>NICKEL2</b>
Glass bead axis	<b>DILVER P1</b>	<b>GOLD 0.2 OVER NICKEL2</b>

PAGE 2/3

ISSUE **1942A**

SERIES **SMA**

PART NUMBER **R125609171**

### PACKAGING

Standard	Unit	Other
<b>100</b>	<b>Contact us</b>	<b>Contact us</b>

### ELECTRICAL CHARACTERISTICS

Impedance		<b>50</b>	Ω
Frequency		<b>0-26.5</b>	GHz
VSWR	<b>1.1*</b> +	<b>0,0100</b>	x F(GHz) Maxi
Insertion loss		<b>0.3*</b>	√F(GHz) dB Maxi
RF leakage	- (	<b>90*</b>	- F(GHz) dB Maxi
Voltage rating		<b>500</b>	Veff Maxi
Dielectric withstanding voltage		<b>1000</b>	Veff mini
Insulation resistance		<b>5000</b>	MΩ mini

### ENVIRONMENTAL

Operating temperature	<b>-65/+165</b>	°C
Hermetic seal	<b>10-8</b>	Atm.cm3/s
Panel leakage	<b>NA</b>	

### MECHANICAL CHARACTERISTICS

Center contact retention			
Axial force – Mating End		<b>27</b>	N mini
Axial force – Opposite end		<b>27</b>	N mini
Torque		<b>2.8</b>	N.cm mini
Recommended torque			
Mating			N.cm
Panel nut			N.cm
Mating life		<b>500</b>	Cycles mini
Weight		<b>1,4000</b>	g

### SPECIFICATION

### OTHER CHARACTERISTICS

Assembly instruction:

Others:

**\*Coaxial Transmission Line Only**

## PANEL DRILLING

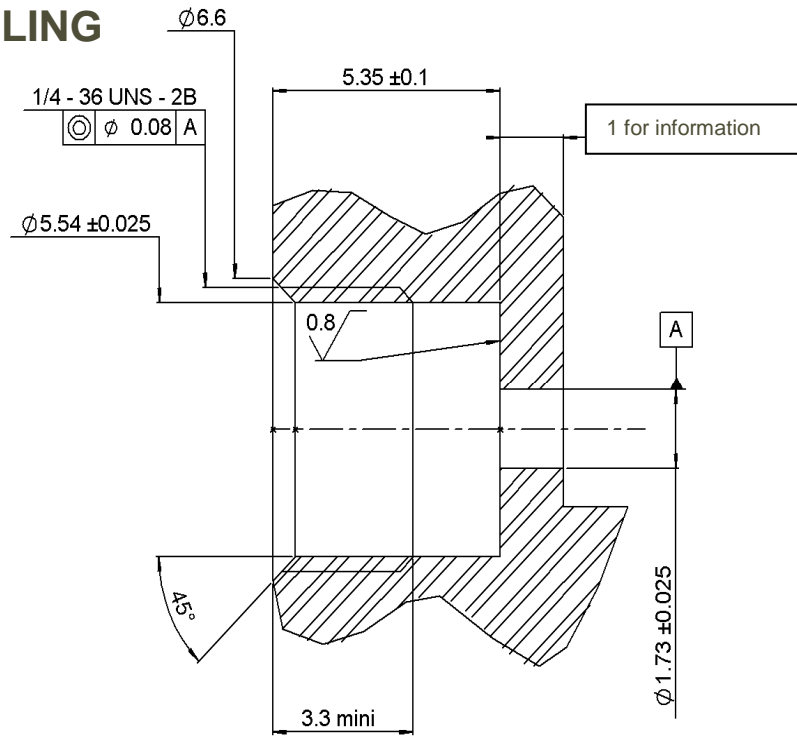

## MOUNTING

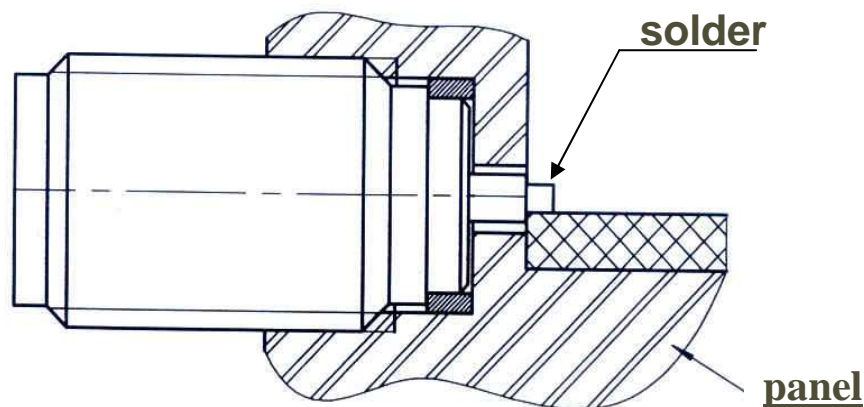

Mount metal gasket onto connector. Screw the whole into the housing. Tighten the connector up to 280Ncm+or-10Ncm(use special tooling set RADIALL R282.341.012 )Thus the connexion hermeticity is guaranteed at 10-8cc/sec.

Then solder the pin on the track.

Beware there is not too much solder.