

**SCREW ON FEMALE RECEPTACLE**  
**HERMETIC - WITH AUXILIARY CONTACT**

**R125.609.021**

Series : SMA

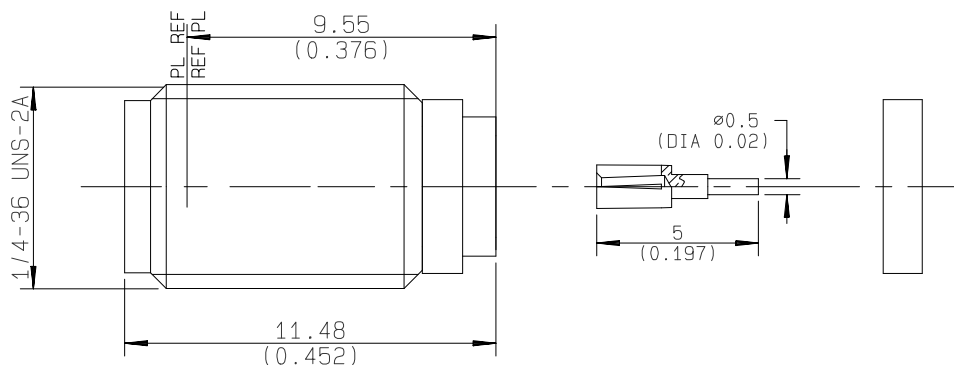

All dimensions are in mm.

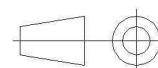

COMPONENTS	MATERIALS	PLATINGS (μm)
BODY	STAINLESS STEEL	PASSIVATED.
CENTER CONTACT	BERYLLIUM COPPER	GOLD 1.3 OVER NICKEL2
OUTER CONTACT	-	-
INSULATOR	PTFE	-
GASKET	ALUMINIUM ALLOY	GOLD 0.5 OVER NICKEL 2
OTHERS PARTS	BERYLLIUM COPPER	-
-	-	-
-	-	-

Issue : 1942 A

In the effort to improve our products, we reserve the right to make changes judged to be necessary.



**SCREW ON FEMALE RECEPTACLE**  
**HERMETIC - WITH AUXILIARY CONTACT**

**R125.609.021**

Series : SMA

**PACKAGING**

Standard	Unit	Other
<b>1</b>	<b>-</b>	<b>Contact us</b>

**SPECIFICATION****ELECTRICAL CHARACTERISTICS**

Impedance	<b>50</b>	$\Omega$
Frequency	<b>0-26.5</b>	GHz
VSWR	<b>1.10 + 0,0100</b>	x F(GHz) Maxi
Insertion loss	<b>0.3</b>	$\sqrt{F}(\text{GHz})$ dB Maxi
RF leakage	<b>NA</b>	- F(GHz)) dB Maxi
Voltage rating	<b>500</b>	Veff Maxi
Dielectric withstanding voltage	<b>1000</b>	Veff mini
Insulation resistance	<b>5000</b>	M $\Omega$ mini

**ENVIRONMENTAL**

Operating temperature	<b>-40/+100</b>	$^{\circ}\text{C}$
Hermetic seal	<b>10-5</b>	Atm.cm <sup>3</sup> /s
Panel leakage	<b>NA</b>	

**OTHERS CHARACTERISTICS**Assembly instruction **NA**

Others :

-

**MECHANICAL CHARACTERISTICS**

Center contact retention	
Axial force – Mating end	<b>27</b> N mini
Axial force – Opposite end	<b>27</b> N mini
Torque	<b>2.8</b> N.cm mini
Recommended torque	
Mating	<b>NA</b> N.cm
Panel nut	<b>280</b> N.cm
Mating life	<b>500</b> Cycles mini
Weight	<b>1,4000</b> g

Issue : 1942 A

In the effort to improve our products, we reserve the right to make changes judged to be necessary.



**SCREW ON FEMALE RECEPTACLE**  
**HERMETIC - WITH AUXILIARY CONTACT**

**R125.609.021**

Series : SMA

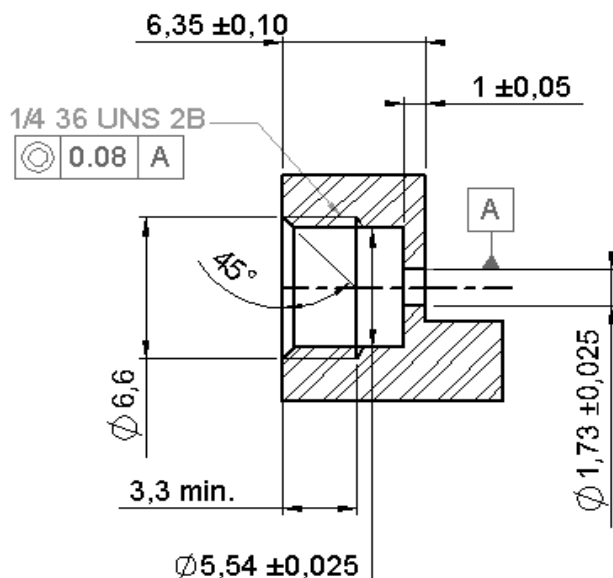
**PANEL DRILLING****RECOMMENDED MOUNTING HOLE DETAIL**

Panel deformation less than 25μ

Assemble metal gasket onto connector. Screw both parts into the housing.  
 Tighten the connector up to 280Ncm +or- 10Ncm (use special tooling set RADIALL R282 341 012).  
 Thus the connexion hermeticity is guaranteed at  $1 \cdot 10^{-5}$  atm. cm<sup>3</sup>/s.  
 Then solder the pin on the track.  
 Be careful not to put too much solder.

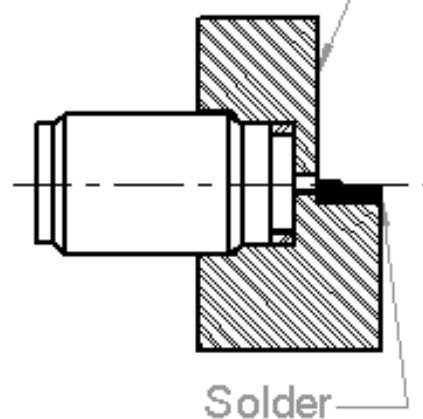
**Issue : 1942 A**

In the effort to improve our products, we reserve the right to make changes judged to be necessary.

