

PAGE 1/4

ISSUE 25-06-19B

SERIES IMP

PART NUMBER R107064930

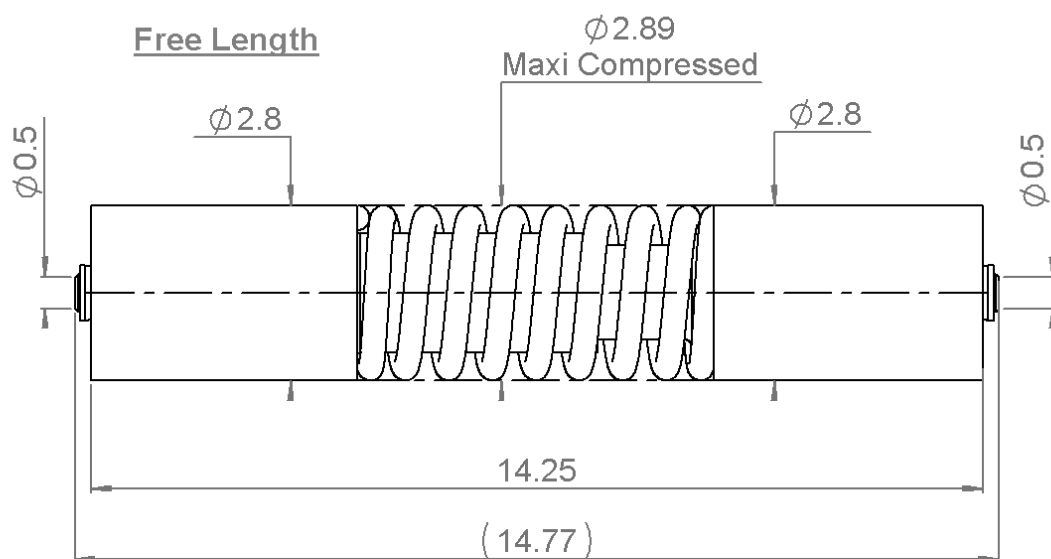

PANEL CUT OUT

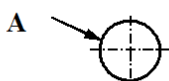

mm		
	Maxi	mini
A	2.93	2.91

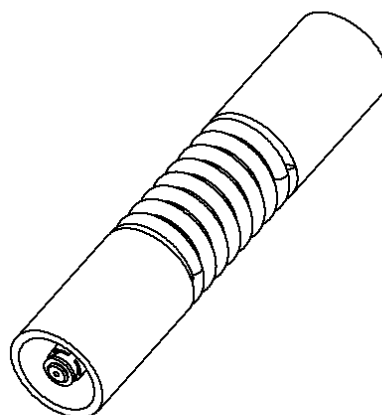

All dimensions are in mm.

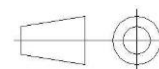

COMPONENTS	MATERIALS	PLATING (µm)
Body	BERYLLIUM COPPER	NPGR
Center contact	BERYLLIUM COPPER	NPGR
Outer contact		
Insulator	PEEK	
Gasket		
Others parts	STEEL	
-	-	-
-	-	-

PAGE 2/4

ISSUE **25-06-19B**

SERIES **IMP**

PART NUMBER **R107064930**

PACKAGING

Standard	Unit	Other
100	Contact us	Contact us

ELECTRICAL CHARACTERISTICS

Impedance	50	Ω
Frequency	0-20	GHz
VSWR	*1.4 + 0,0000	x F(GHz) Maxi
Insertion loss	0.2	\sqrt{F} (GHz) dB Maxi
RF leakage	- (TBT	- F(GHz)) dB Maxi
Voltage rating	225	Veff Maxi
Dielectric withstanding voltage	500	Veff mini
Insulation resistance	1000	M Ω mini

MECHANICAL CHARACTERISTICS

Center contact retention		
Axial force – Mating End	10	N mini
Axial force – Opposite end	10	N mini
Torque	NA	N.cm mini
Recommended torque		
Mating	NA	N.cm
Panel nut	NA	N.cm
Mating life	50	Cycles mini
Weight	0,3800	g

ENVIRONMENTAL

Operating temperature	-65/+165	°C
Hermetic seal	NA	Atm.cm3/s
Panel leakage	NA	

SPECIFICATION

OTHER CHARACTERISTICS

Assembly instruction:

Others:

*** (VSWR 1.4 - Compressed Nom 13.4)**

Minimum compression

Overall length: $L = 13.9$ Maxi
Load = 4.5 N min

Maximum Compression

Overall length: $L = 12.9$ mini
Load = About 10 N Max

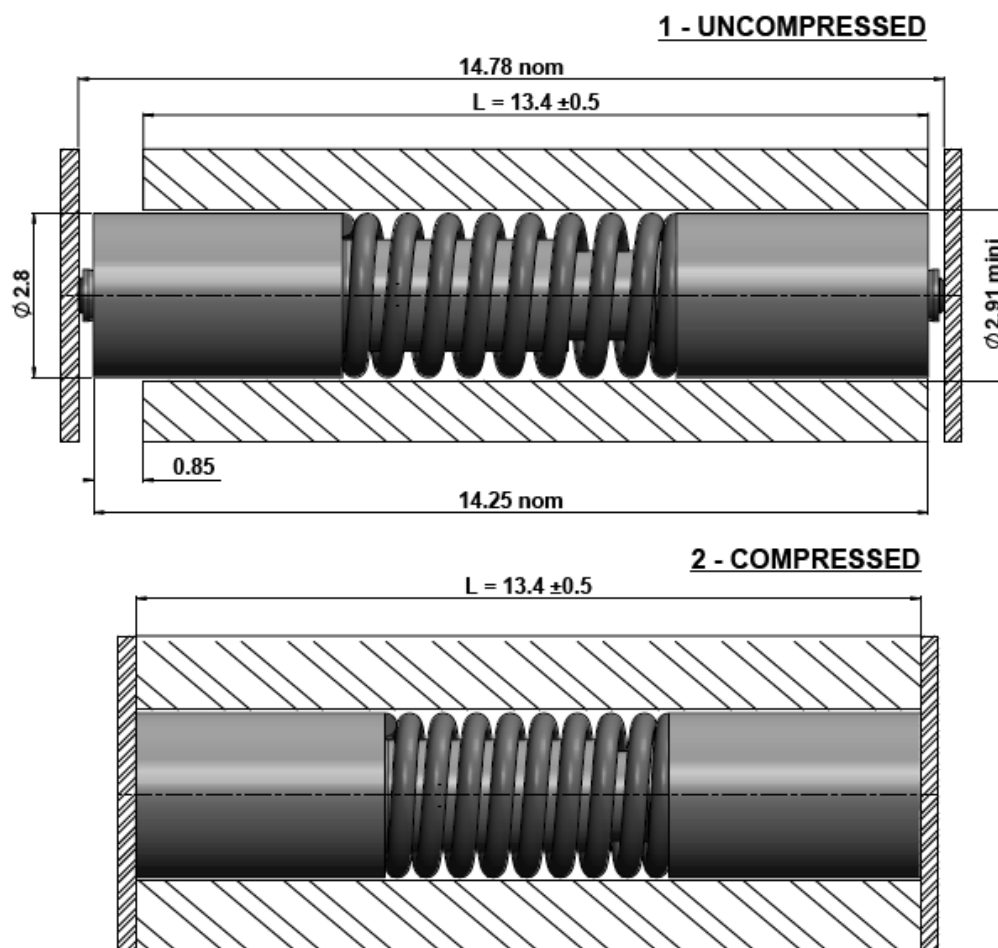

Printed Circuit Board Lay out

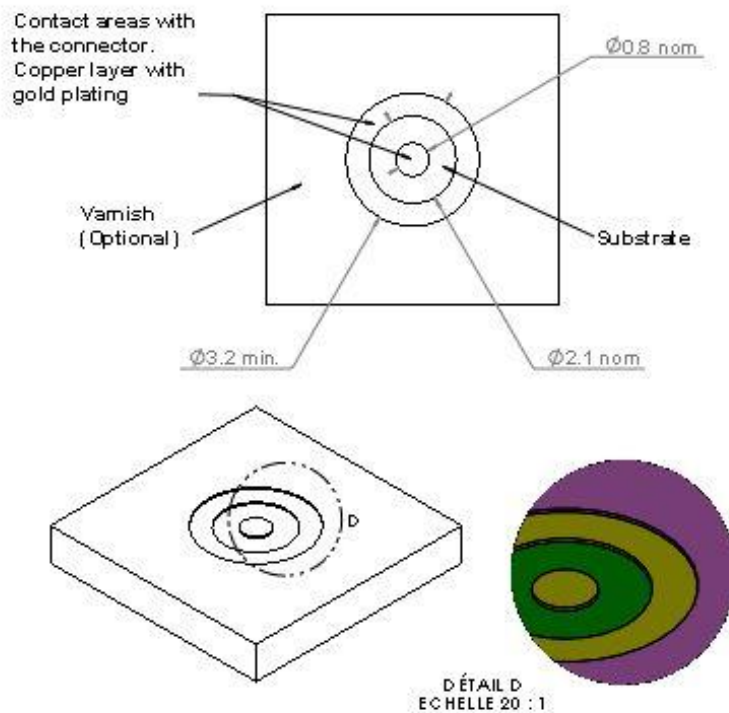

The dimensions defined the electricals contact areas to be mechanically compatible with the connector dimensions.

The PCB construction must be a multi layers design.