

PAGE 1/5

ISSUE 05-01-21A

SERIES IMP

PART NUMBER R107851000

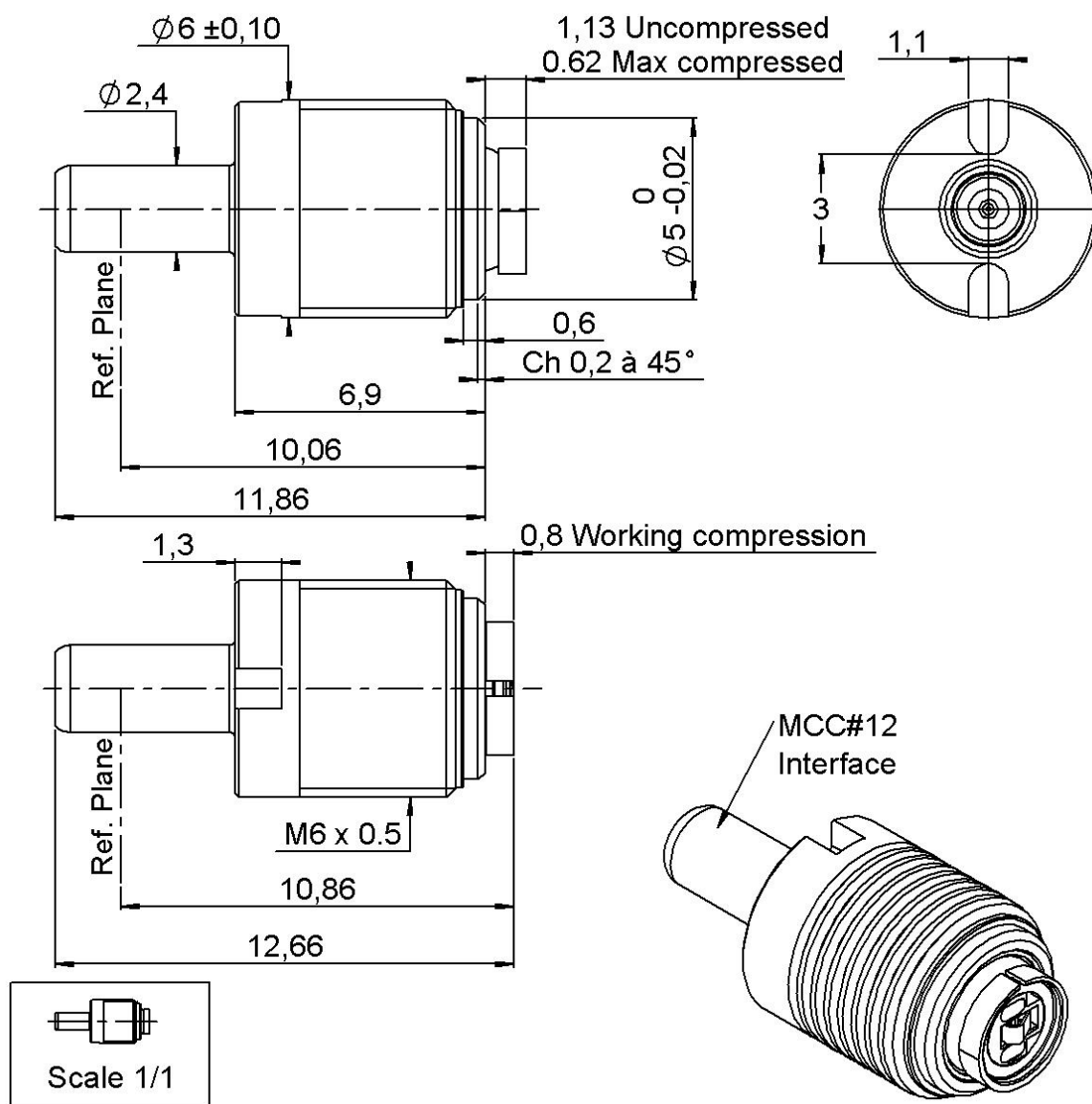

All dimensions are in mm. Tolerances according ISO 2768 m-H

COMPONENTS	MATERIALS	PLATING (μm)
Body	BRONZE	GOLD OVER NICKEL
Center contact	BERYLLIUM COPPER	GOLD OVER NICKEL
Outer contact		
Insulator	PTFE+PEEK	
Gasket		
Others parts	BRASS	GOLD OVER NICKEL
-	-	-
-	-	-

PAGE 2/5

ISSUE **05-01-21A**

SERIES **IMP**

PART NUMBER **R107851000**

PACKAGING

Standard	Unit	Other
1	Contact us	Contact us

ELECTRICAL CHARACTERISTICS

Impedance	50	Ω
Frequency	0-20	GHz
VSWR	0,00	x F(GHz) Maxi
Insertion loss	**	\sqrt{F} (GHz) dB Maxi
RF leakage	NA	- F(GHz)) dB Maxi
Voltage rating	225	Veff Maxi
Dielectric withstanding voltage	500	Veff mini
Insulation resistance	1000	M Ω mini

ENVIRONMENTAL

Operating temperature	-55/+125	°C
Hermetic seal	NA	Atm.cm3/s
Panel leakage	NA	

MECHANICAL CHARACTERISTICS

Center contact retention		
Axial force – Mating End	***	N mini
Axial force – Opposite end	***	N mini
Torque	NA	N.cm mini

Recommended torque		
Mating	NA	N.cm
Panel nut	90	N.cm

Mating life	50	Cycles mini
Nominal Weight	1,46	g
(Add +15% for max weight)		

SPECIFICATION

OTHER CHARACTERISTICS

Assembly instruction:

Others:

***1,18 typic DC-12Ghz / 1,26 typic 12 --> 18GHz**

****0,38dB max at 18GHz**

*****0.5N min for IMP LP / *6.7N min for MCC12**

******50 cycles min for IMP LP / 500 cycles min for MCC12**

PAGE 3/5

ISSUE 05-01-21A

SERIES IMP

PART NUMBER R107851000

ADDITIONAL INFORMATION
MOUNTING AND REPLACEMENT INSTRUCTIONS

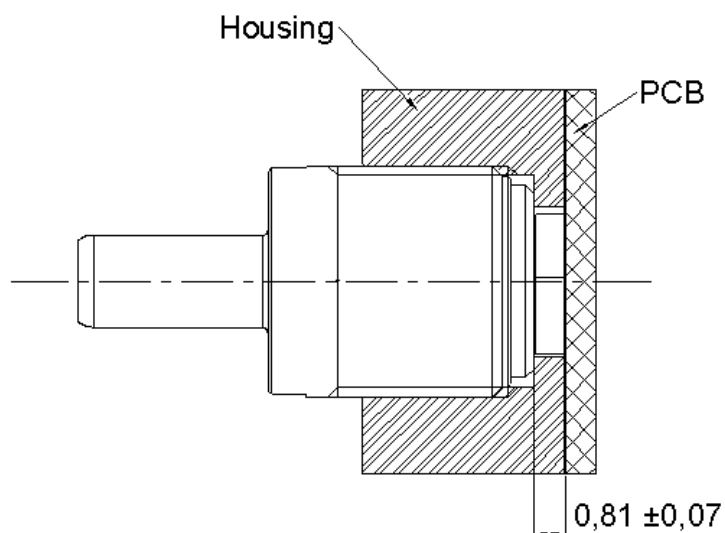
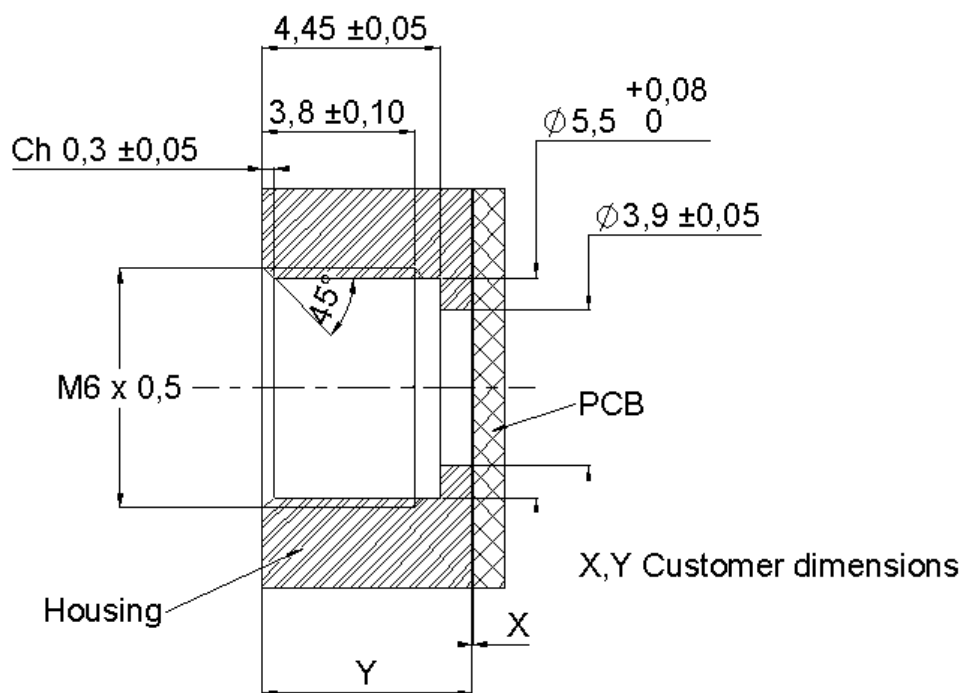

PAGE 4/5

ISSUE **05-01-21A**

SERIES **IMP**

PART NUMBER **R107851000**

- 1) Connector must be screwed or unscrewed with adapted torque driver R282343000, recommended coupling torque: 90N.cm.
- 2) Slide on the connector in F direction until it stops against the tool.

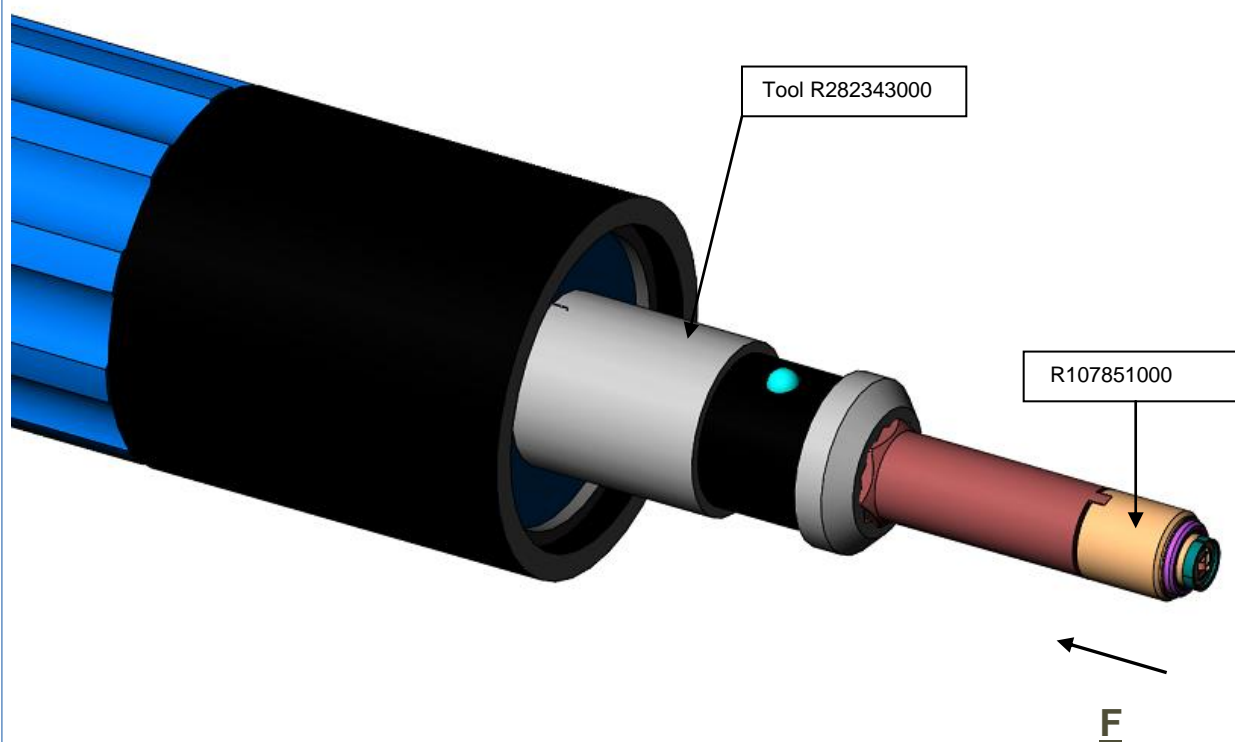

- 3) Screw the connector until it bottom against panel at the specified torque

PAGE 5/5

ISSUE **05-01-21A**

SERIES **IMP**

PART NUMBER **R107851000**

PAD recommended

