

PAGE 1/4

ISSUE 08-02-22A

SERIES IMP

PART NUMBER R107820320

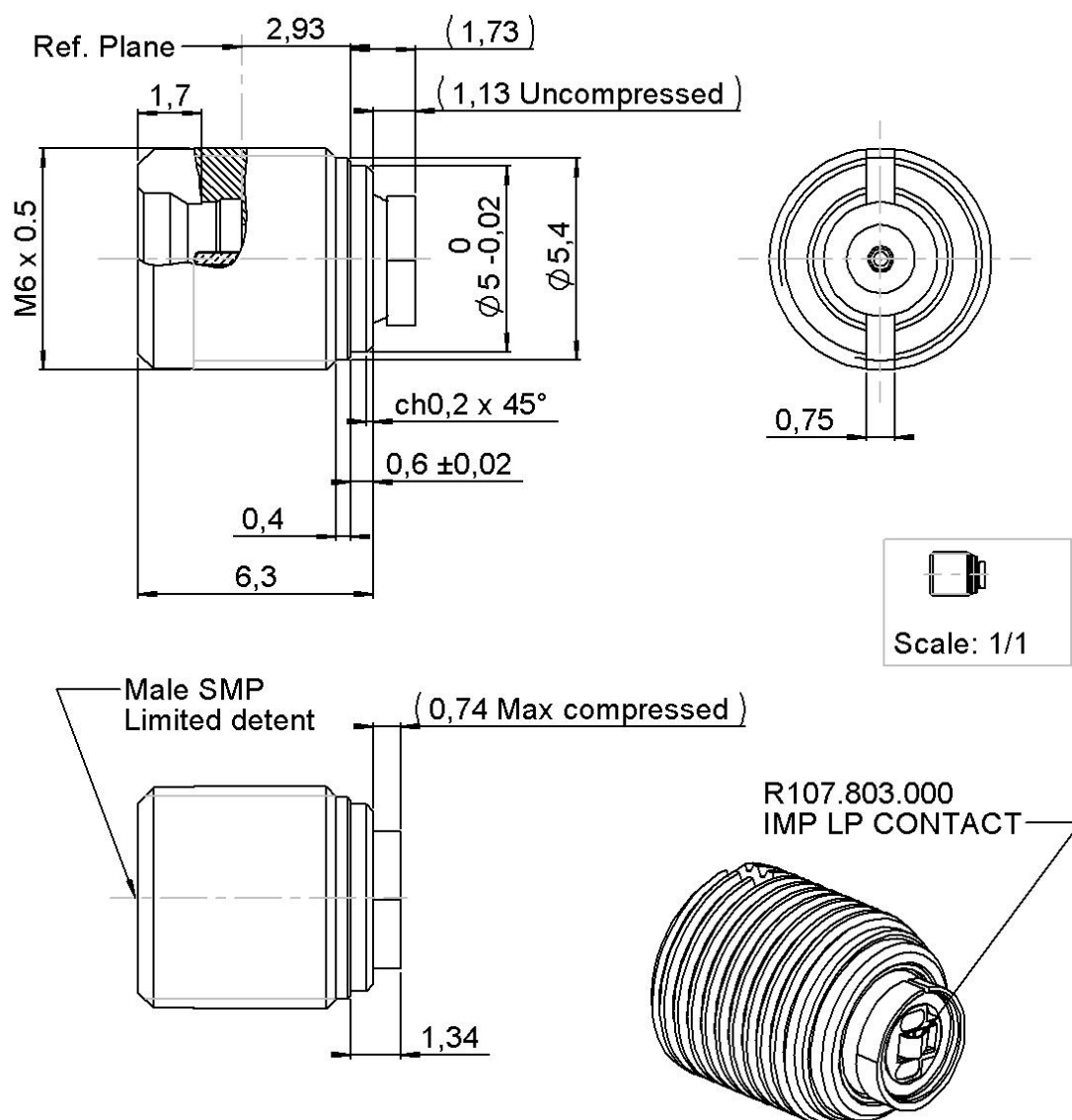

Scale: 1/1

All dimensions are in mm. Tolerances according ISO 2768 m-H

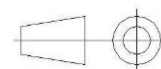

COMPONENTS	MATERIALS	PLATING (µm)
Body	STAINLESS STEEL	PASSIVATED
Center contact	BERYLLIUM COPPER,BRASS	GOLD OVER NICKEL
Outer contact		
Insulator	PTFE+PEEK	
Gasket		
Others parts	BERYLLIUM COPPER,BRASS	GOLD OVER NICKEL
-	-	-
-	-	-

PAGE 2/4

ISSUE **08-02-22A**

SERIES **IMP**

PART NUMBER **R107820320**

PACKAGING

Standard	Unit	Other
1	Contact us	Contact us

ELECTRICAL CHARACTERISTICS

Impedance	50	Ω
Frequency	0-18	GHz
VSWR	* + 0,000	x F(GHz) Maxi
Insertion loss	**	\sqrt{F} (GHz) dB Maxi
RF leakage	- (NA	- F(GHz)) dB Maxi
Voltage rating	225	Veff Maxi
Dielectric withstanding voltage	500	Veff mini
Insulation resistance	1000	M Ω mini

MECHANICAL CHARACTERISTICS

Center contact retention		
Axial force – Mating End	***	N mini
Axial force – Opposite end	***	N mini
Torque	NA	N.cm mini

Recommended torque		
Mating	NA	N.cm
Panel nut	90	N.cm

Mating life	50	Cycles mini
Nominal Weight	1,510	g
(Add +15% for max weight)		

ENVIRONMENTAL

Operating temperature	-55/+125	°C
Hermetic seal	NA	Atm.cm3/s
Panel leakage	NA	

SPECIFICATION

OTHER CHARACTERISTICS

Assembly instruction:

Others:

***VSWR: 1.10 typic DC-12GHz**

***VSWR: 1.35 typic 12-->18GHz**

****0.35dB max at 18GHz**

*****0.5N min for IMP LP**

*****6.7N min for SMP**

******50 cycles min for IMP LP**

******500 cycles for SMP**

PAGE 3/4

ISSUE 08-02-22A

SERIES IMP

PART NUMBER R107820320

ADDITIONAL INFORMATION
MOUNTING AND REPLACEMENT INSTRUCTIONS

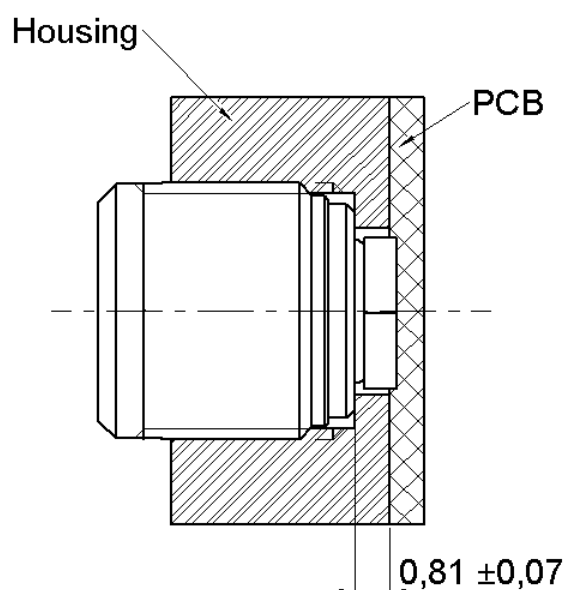
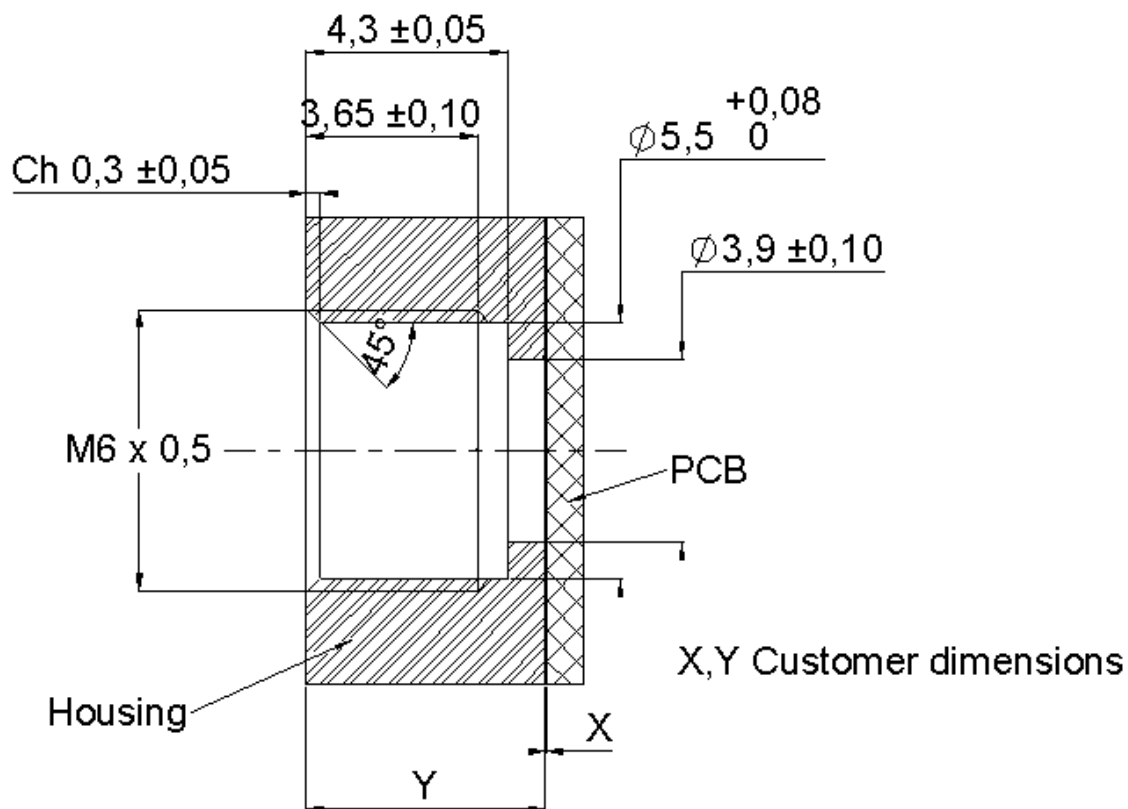

PAGE 4/4

ISSUE 08-02-22A

SERIES IMP

PART NUMBER R107820320

- 1) Connector must be screwed or unscrewed with adapted torque driver R282.339.002, recommended coupling torque: 90N.cm.
- 2) Slide on the connector in F direction until it stops against the tool.

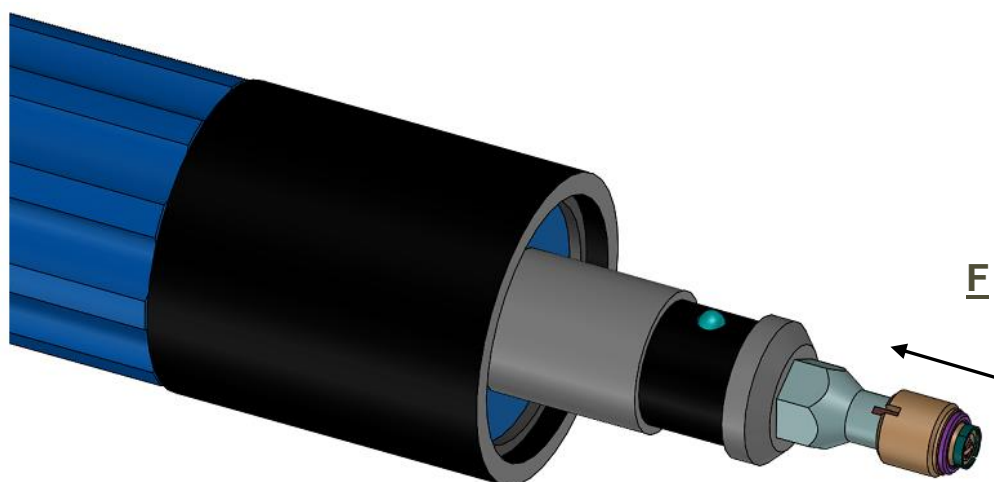

- 3) Screw the connector until it bottom against panel at the specified torque

PAD recommended

