

PAGE 1/3	ISSUE 01-03-21A	SERIES IMP	PART NUMBER R107803020
----------	-----------------	------------	------------------------

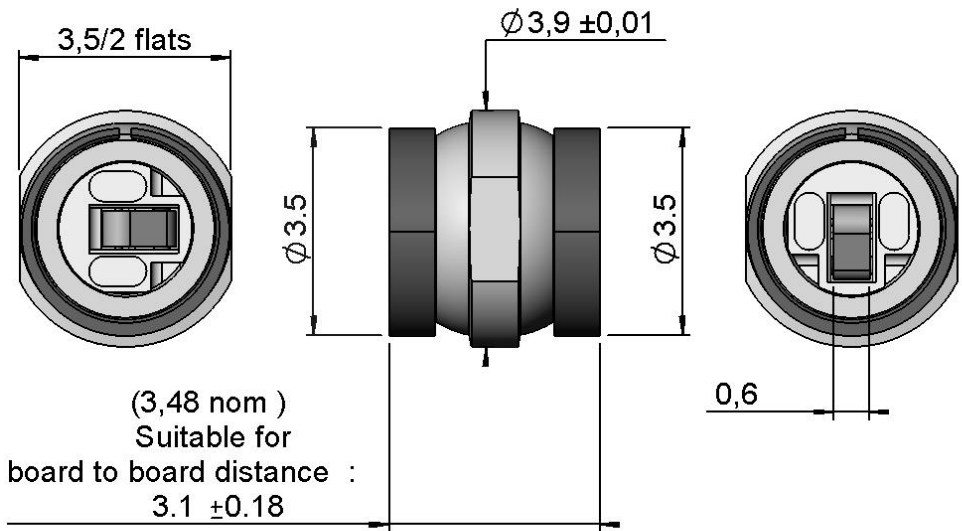

All dimensions are in mm. Tolerances according ISO 2768 m-H

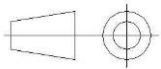

COMPONENTS	MATERIALS	PLATING ( $\mu\text{m}$ )
Body	<b>BRONZE</b>	<b>NPGR</b>
Center contact	<b>BERYLLIUM COPPER</b>	<b>GOLD OVER NICKEL</b>
Outer contact		
Insulator	<b>PEEK</b>	
Gasket		
Others parts	<b>BERYLLIUM COPPER</b>	<b>NPGR</b>
-	-	-
-	-	-

PAGE 2/3

ISSUE **01-03-21A**

SERIES **IMP**

PART NUMBER **R107803020**

### PACKAGING

Standard	Unit	Other
<b>100</b>	<b>Contact us</b>	<b>Contact us</b>

### ELECTRICAL CHARACTERISTICS

Impedance	<b>50</b>	$\Omega$
Frequency	<b>0-18</b>	GHz
VSWR	<b>* + 0,000</b>	x F(GHz) Maxi
Insertion loss	<b>**</b>	$\sqrt{F}$ (GHz) dB Maxi
RF leakage	<b>- ( NA</b>	- F(GHz)) dB Maxi
Voltage rating	<b>225</b>	Veff Maxi
Dielectric withstanding voltage	<b>500</b>	Veff mini
Insulation resistance	<b>1000</b>	M $\Omega$ mini

### MECHANICAL CHARACTERISTICS

Center contact retention		
Axial force – Mating End	<b>0.5</b>	N mini
Axial force – Opposite end	<b>0.5</b>	N mini
Torque	<b>NA</b>	N.cm mini

Recommended torque		
Mating	<b>NA</b>	N.cm
Panel nut	<b>NA</b>	N.cm

Mating life	<b>50</b>	Cycles mini
Nominal Weight (Add +15% for max weight)	<b>0,250</b>	g

### ENVIRONMENTAL

Operating temperature	<b>-55/+125</b>	°C
Hermetic seal	<b>NA</b>	Atm.cm3/s
Panel leakage	<b>NA</b>	

### SPECIFICATION

### OTHER CHARACTERISTICS

Assembly instruction:

Others:

**\*V.S.W.R: 1.3 max DC-12GHzs**

**\*V.S.W.R: 1.55 max --> 18GHz**

**\*\*0.25dB max at 18GHz**

**THALES P/N: 352250067651**

PAGE 3/3

ISSUE 01-03-21A

SERIES IMP

PART NUMBER R107803020

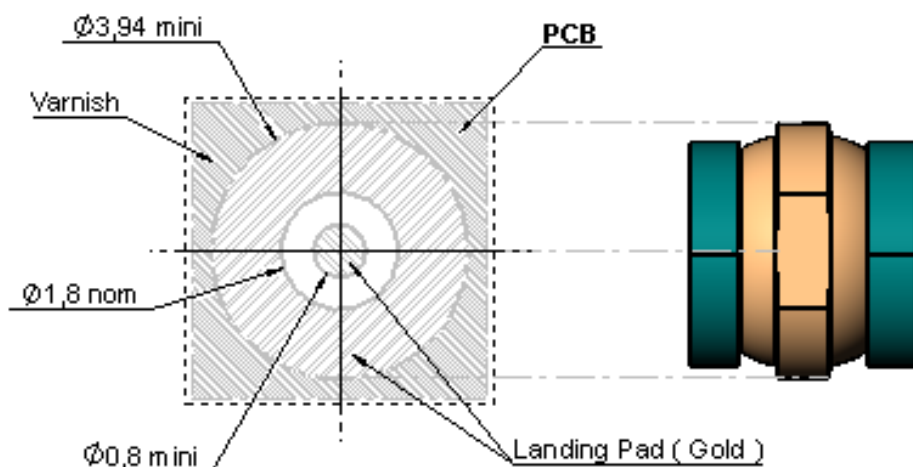

## 2 - UNCOMPRESSED

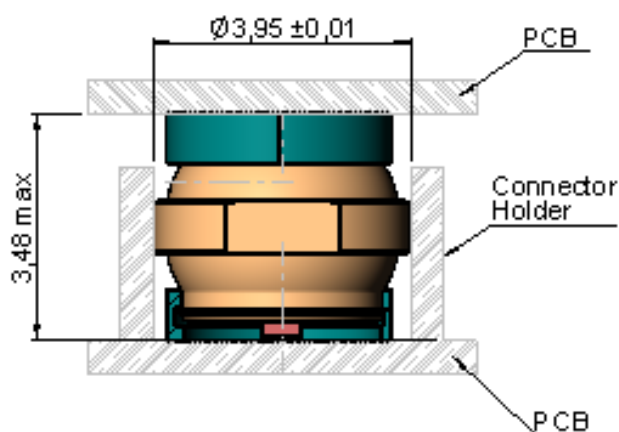

## 3 - COMPRESSED

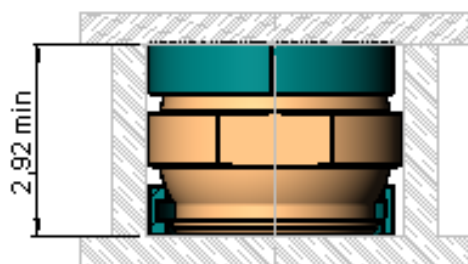

## 1 - UNCOMPRESSED

