

PAGE 1/3	ISSUE 31-01-20A	SERIES IMP	PART NUMBER R107802000
----------	-----------------	------------	------------------------

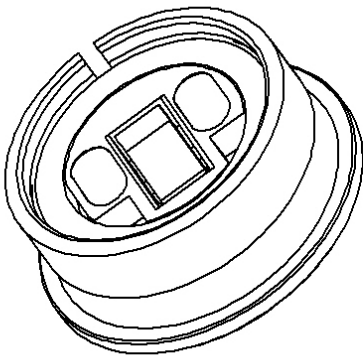

All dimensions are in mm. Tolerances according ISO 2768 m-H

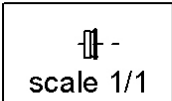
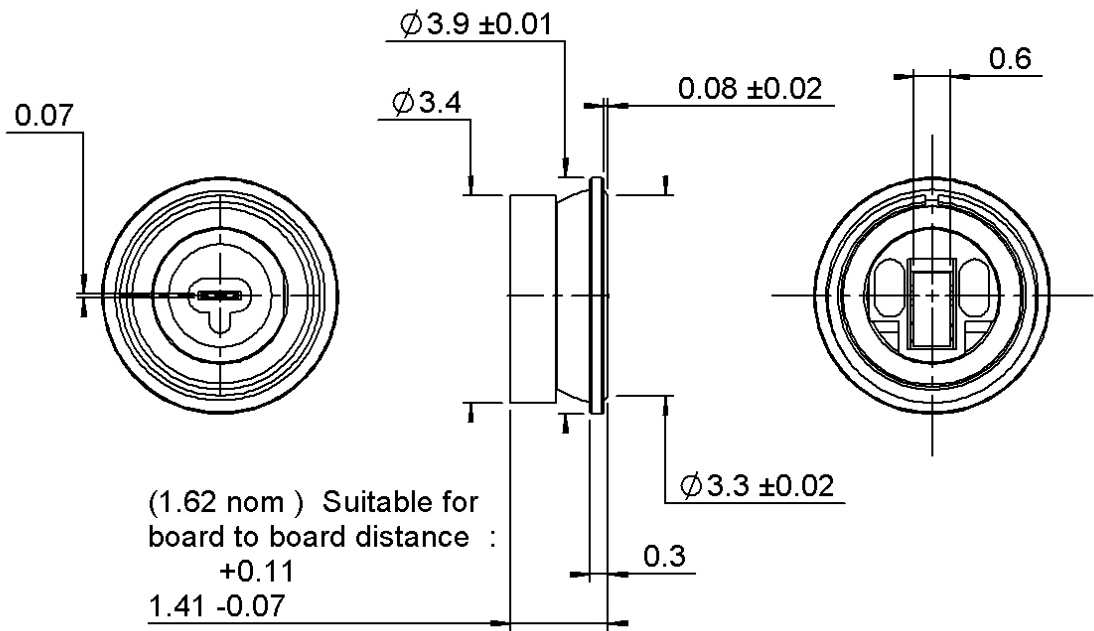
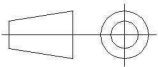

COMPONENTS	MATERIALS	PLATING (µm)
Body	<b>BRONZE</b>	<b>NPGR</b>
Center contact	<b>BERYLLIUM COPPER</b>	<b>GOLD 1.3 OVER NICKEL2</b>
Outer contact		
Insulator	<b>PEEK</b>	
Gasket		
Others parts	<b>BERYLLIUM COPPER</b>	<b>NPGR</b>
-	-	-
-	-	-

PAGE 2/3

ISSUE 31-01-20A

SERIES IMP

PART NUMBER R107802000

## PACKAGING

Standard	Unit	Other
100	Contact us	Contact us

## ELECTRICAL CHARACTERISTICS

Impedance	50	Ω
Frequency	0-18	GHz
VSWR	* + 0,0000	x F(GHz) Maxi
Insertion loss	**	√F(GHz) dB Maxi
RF leakage	- ( NA	- F(GHz) dB Maxi
Voltage rating	225	Veff Maxi
Dielectric withstanding voltage	500	Veff mini
Insulation resistance	1000	MΩ mini

## ENVIRONMENTAL

Operating temperature	-55/+125	°C
Hermetic seal	NA	Atm.cm3/s
Panel leakage	NA	

## MECHANICAL CHARACTERISTICS

Center contact retention		
Axial force – Mating End	0.5	N mini
Axial force – Opposite end	0.5	N mini
Torque	NA	N.cm mini

## SPECIFICATION

## OTHER CHARACTERISTICS

Recommended torque		
Mating	NA	N.cm
Panel nut	NA	N.cm
Mating life	50	Cycles mini
Nominal Weight	0,1300	g
(Add +15% for max weight)		

Others:

\*V.S.W.R: 1.3 max DC-12GHz

\*V.S.W.R: 1.5 max ->18GHz

\*\*0.20dB maxi

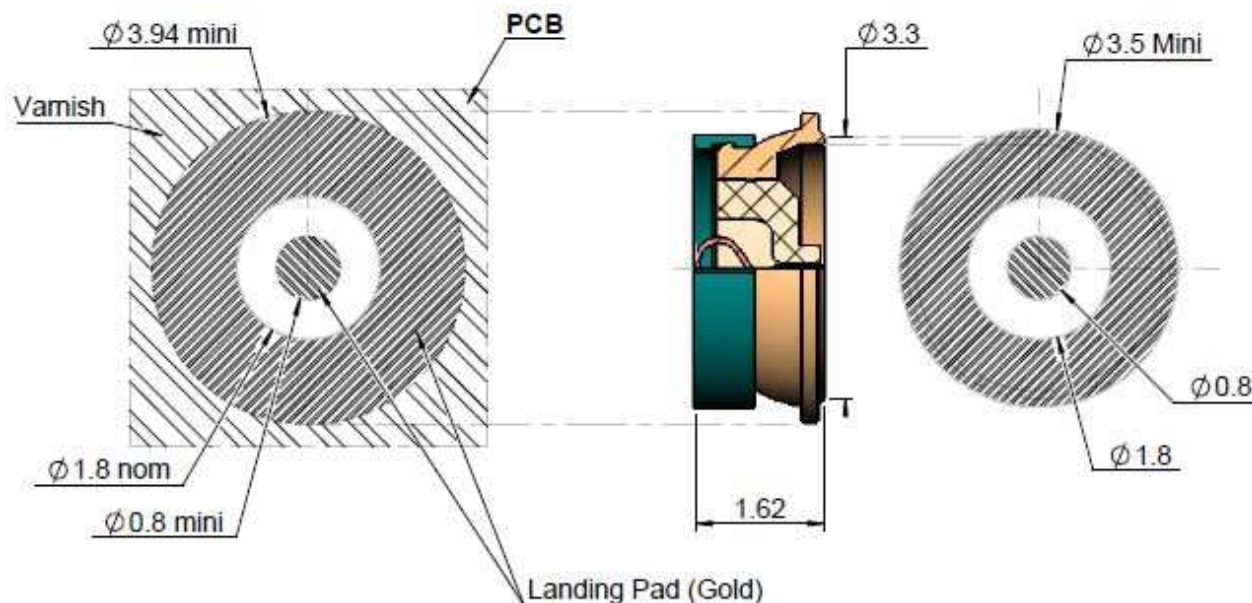

## **2 - COMPRESSED : 1.52**

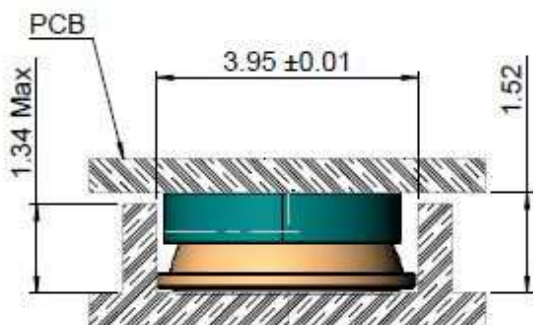

## **3 - COMPRESSED : 1.34**

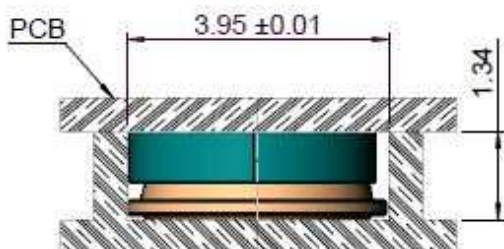

## **1 - UNCOMPRESSED**

